

THIS DRAWING IS UNPUBLISHED. RELEASED FOR PUBLICATION
 © COPYRIGHT - By - ALL RIGHTS RESERVED.

LOC	DIST	REVISIONS					
AF	50	P	LTR	DESCRIPTION	DATE	DWN	APVD
		E1		REVISED PER ECO-11-004820	11MAR11	RK	HMR

- 1 CONTINUOUS STRIP ON REELS.
- 2 ACCEPTS WIRE SIZE [#16-#12 OR TWO #16'S].
- 3 INSULATION RANGE TO BE 4.06-5.33 [.160-.210] OR TWO 3.30 [.130] MAX DIA.
- 4 MATING TAB THK IS 0.81 [.032±.001].
- 5 INTERLEAVING PAPER REQUIRED. ±0.025
- 6 PRELIMINARY - NOT FOR PRODUCTION

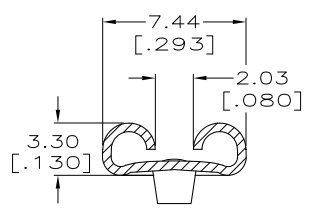
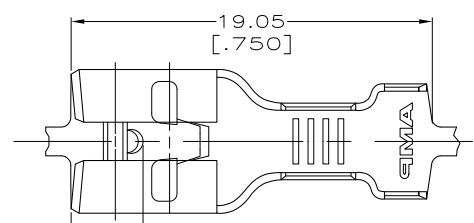

SECTION A-A

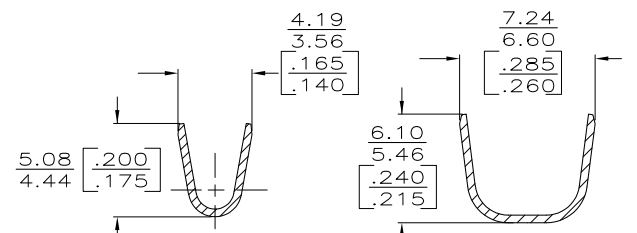
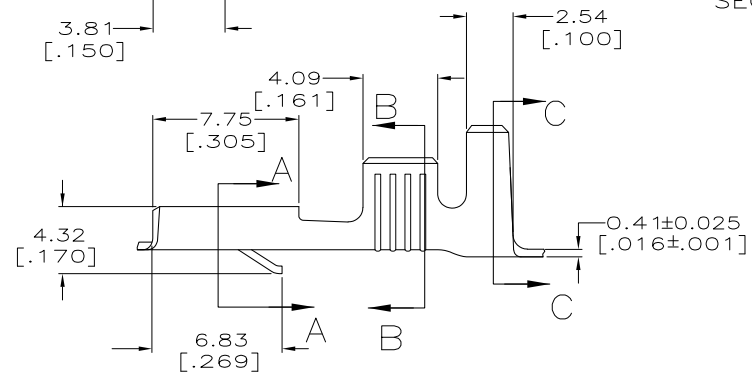

SECTION B-B

SECTION C-C

△ 0.002032 [.000080] MIN TIN	△ 60249-5
0.000381 [.000015] THK SILVER	60249-3
0.002032 [.000080] MIN TIN	60249-2
-	60249-1
FINISH	PART NO

THIS DRAWING IS A CONTROLLED DOCUMENT.		DWN	JR RUTH	7/14/95	STE TE Connectivity
DIMENSIONS: mm(INCHES)		CHK	MS FEHER	7/14/95	
TOLERANCES UNLESS OTHERWISE SPECIFIED:		APVD	J GILLESPIE	7/14/95	
0 PLC ± - 1 PLC ± - 2 PLC ± 0.38 [.015] 3 PLC ± - 4 PLC ± - ANGLES ± -		NAME	RECEPTACLE, FASTIN-FASTON, 6.35 [.250] SERIES		
MATERIAL	H04 BRASS	FINISH	SEE TABLE	WEIGHT	-
		APPLICATION SPEC	114-2025		RESTRICTED TO
		SIZE	A3	CAGE CODE	00779
		DRAWING NO	C=60249		SCALE
		CUSTOMER DRAWING			5:1
		SHEET	1 of 1		REV
					E1