

THE DRAWING IS UNPUBLISHED.
 RELEASED FOR PUBLICATION
 ALL RIGHTS RESERVED.

LOC	QTY	REVISIONS			
AF	50	REV	DESCRIPTION	DATE	BY
		AN2	REVISED PER ECO-11-004587	11MAR11	RK HMR

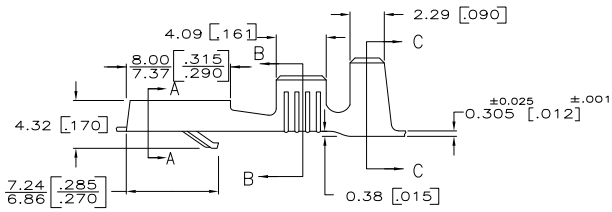
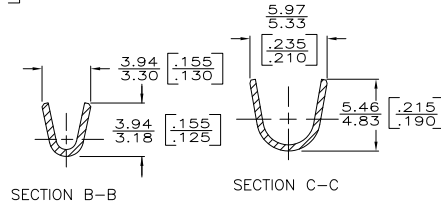
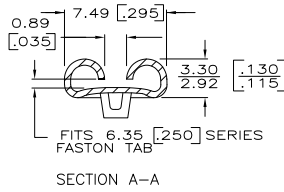
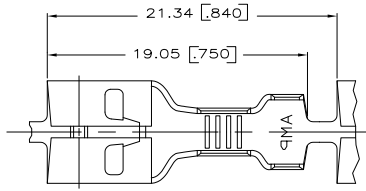

- 1 DIMENSIONS IN BRACKETS ARE IN INCHES.
- 2 CONTINUOUS STRIP ON REELS.
- 3 FOR FOREIGN PRODUCTION ONLY.
- 4 NO RIB IN LOCKING LANCE.
- 5 NO STRESS RELIEVING
- 6 REELED WITH INTERLEAVING PAPER
- 8 OBSOLETE PARTS: OBSOLETE CIS STREAMLINING PER D.RENAUD/D.SINISI

LOOSE PIECE	FINISH	MATERIAL	INSULATION RANGE	WIRE SIZE	TAB THK	PART NO
△△△	—	TIN #4H BRASS				42100-9
△△△	—	TIN #4H BRASS				2-42100-2
△△△	—	#4H BRASS	2.54 - 4.32	0.8 - 2.0 mm ²	±0.025	2-42100-1
△△△ OBSOLETE	—	TIN #4H BRASS				1-42100-2
△△△ OBSOLETE	1-42238-1	SILVER #4H BRASS	[.100 - .170]	[18 - 14]	0.81 [.032 ±.001]	1-42100-1
△△△	—	#4H BRASS				42100-3
△△△	—	#4H BRASS				42100-2
△△△	—	#4H BRASS				42100-1

THIS DRAWING IS A CONTROLLED DOCUMENT.		DR R. RUTH 2/5/98	TE TE Connectivity
		DR MS FEHER 3/5/98	
DIMENSIONS: mm(INCHES)		APR C. MEYERS 2/6/98	RECEPTACLE, FASTON-FASTON, .250 SERIES
TOLERANCES UNLESS OTHERWISE SPECIFIED:		PRODUCT SPEC	SIZE A2
0 P/C ± — 1 P/C ± — 2 P/C ± — 3 P/C ± 0.25 [.010] 4 P/C ± — ANGLES ± —		APPLICATION SPEC	DRAWING NO C=42100
MATERIAL SEE ABOVE	FINISH SEE ABOVE	WEIGHT —	RESTRICTED TO —
CUSTOMER DRAWING		SCALE 5:1	SHEET 1 of 1

METRIC