

DRAWING MADE IN THIRD ANGLE PROJECTION

THIS DRAWING IS UNPUBLISHED. RELEASED FOR PUBLICATION, 19
 © COPYRIGHT 19 BY AMP INCORPORATED. ALL INTERNATIONAL RIGHTS RESERVED.

| LOC | DIST | REVISIONS | | | | DATE | APPD |
|-----|------|-----------|-----|----------------------|--|---------|-------|
| AF | 50 | ZONE | LTR | DESCRIPTION | | | |
| | | L | | REV PER 063A-0125-01 | | 20FEB01 | JR/PD |

1 CONTINUOUS STRIP ON REELS.

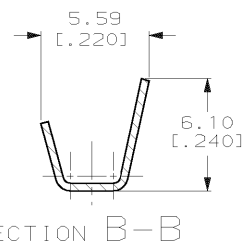
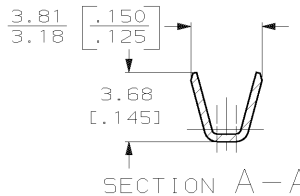
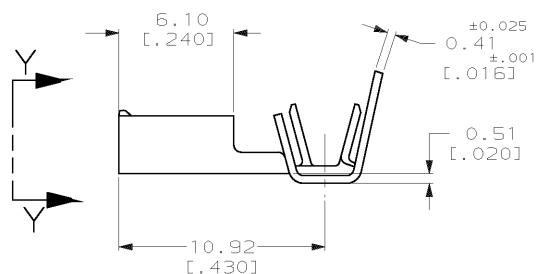
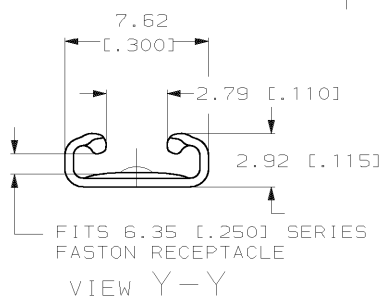
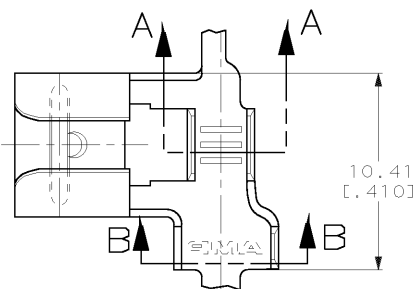

| | | | | |
|---|--|---|------------------------------|---------------------|
| TIN | 2.79-4.06 | 0.8-2.0mm ² | 0.81 | 63096-2 |
| - | [.110-.160] DIA | [18-14] AWG | [.032] | 63096-1 |
| FINISH | INSULATION RANGE | WIRE SIZE | MATING TAB THK ±0.025 [.001] | PART NO |
| DO NOT SCALE PRINT. UNLESS SPECIFIED DIMENSIONS IN MM [INCHES] TOLERANCES ON: 2. PLC DEC ± 3. PLC DEC ± 0.38 (.015) ANGLES ± - | DR 4/15/91 JR RUTH CHK 4/15/91 MS FEHER APPD 4/15/91 C MEYERS APPD 4/15/91 D REINER | AMP Incorporated Harrisburg, PA 17105-3608 | | |
| MATERIAL 4M BRASS | PRODUCT SPEC - | NAME RECEPTACLE, FASTON, FLAG, 6.35 [.250] SERIES | | |
| FINISH SEE TABLE | APPLICATION SPEC - | SIZE B | CAGE CODE 00779 | DRAWING NO 63096 |
| | WEIGHT - | SCALE 5:1 | SHEET 1 OF 1 | |

AMP 1470-15 REV 11-89 16-SEP-96 09:18:16 amp13469 /ws/dept2121/dwg2121/u.faston-ceb/u.250-fl

CUSTOMER DRAWING