

4

3

2

1

THIS DRAWING IS UNPUBLISHED. RELEASED FOR PUBLICATION  
 © COPYRIGHT - By - ALL RIGHTS RESERVED.

LOC	DIST	REVISIONS				
P	LTR	DESCRIPTION	DATE	DWN	APVD	
AF	50	T1	REVISED PER ECO-11-004917	11MAR11	RK HMR	

- 1 CONTINUOUS STRIP ON REELS.
- 2 MATING TAB THK IS .032
- 3 WIRE SIZE IS #18-#14 AWG.
- 4 INSULATION RANGE IS .120-.170 DIA. ±.001
- 5 PRELIMINARY - NOT FOR PRODUCTION
- 6 REDUCED PACKAGE QUANTITY

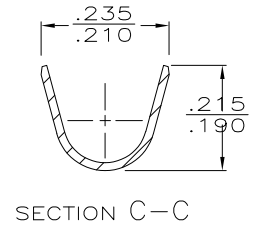
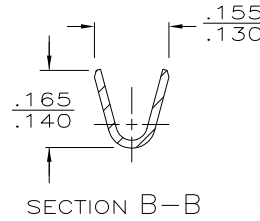
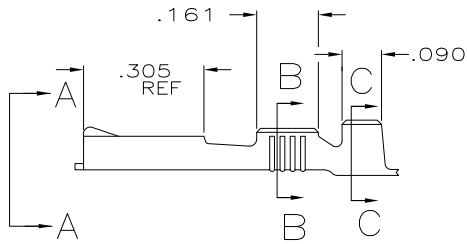
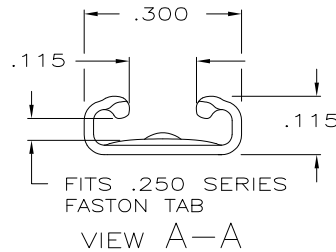
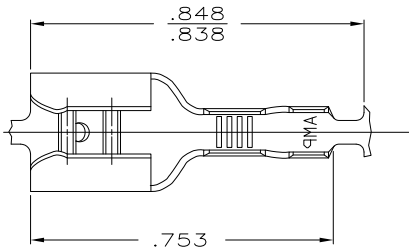

TIN	.016±.001 BRASS	6	542660-6
NICKEL	.016±.001 STEEL	5	42660-5
<del>PRE-TIN</del>	<del>.016±.001 BRASS</del>		<del>42660-4</del>
TIN	.016±.001 BRASS		42660-2
	.016±.001 BRASS		42660-1
FINISH	MATERIAL	PART NO	

THIS DRAWING IS A CONTROLLED DOCUMENT.		DWN	JR RUTH	4/17/86	 TE Connectivity	RECEPTACLE FASTON™ .250 SERIES	RESTRICTED TO
DIMENSIONS:		CHK	G YETTER	4/17/86			
INCHES		APVD	C MEYERS	4/17/86			
TOLERANCES UNLESS OTHERWISE SPECIFIED:		NAME		SIZE			
0 PLC	± -	PRODUCT SPEC		A3	00779	C-42660	
1 PLC	± -	APPLICATION SPEC		WEIGHT		SCALE	
2 PLC	± -	MATERIAL		CUSTOMER DRAWING		NTS	
3 PLC	± .015	FINISH		SHEET		1 OF 1	
4 PLC	± -	SEE ABOVE		REV		T1	