

## 2297

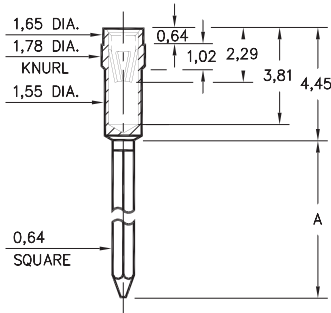

Basic Part Number	# of Wraps	Length A
2297-2	2	9,4
2297-3	3	10,92

**2297-X-17-XX-16-XX-02-0**  
Press-fit in 1,70 mounting hole

## 0280

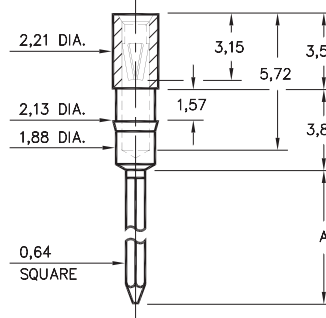

Basic Part Number	# of Wraps	Length A
0280-2	2	9,14
0280-3	3	12,95

**0280-X-17-XX-06-XX-02-0**  
Press-fit in 2,06 mounting hole

## 0281

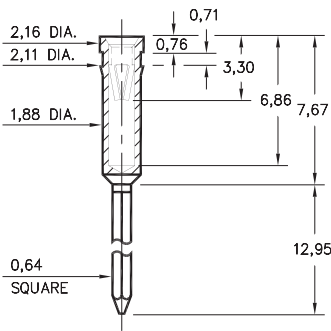

**0281-3-17-XX-06-XX-02-0**  
Press-fit in 2,03 mounting hole

### SPECIFICATIONS

**SHELL MATERIAL:**  
Brass Alloy 360, 1/2 Hard

**CONTACT MATERIAL:**  
Beryllium Copper Alloy 172, HT

**DIMENSION IN INCHES TOLERANCES ON:**  
LENGTHS: ±0,13  
DIAMETERS: ±0,05  
ANGLES: ± 2°

**ORDER CODE: XXXX - X - 17 - XX - XX - XX - 02 - 0**

**BASIC PART #** →

**SPECIFY SHELL FINISH:** →

- 01 5,08µm TIN/LEAD OVER NICKEL
- ◇ 80 5,08µm TIN OVER NICKEL (RoHS)
- ◇ 15 0,25µm GOLD OVER NICKEL (RoHS)

**SPECIFY CONTACT FINISH:** →

- 01 5,08µm TIN/LEAD OVER NICKEL
- ◇ 80 5,08µm TIN OVER NICKEL (RoHS)
- ◇ 27 0,76µm GOLD OVER NICKEL (RoHS)

**SELECT CONTACT**

#06 or #16 CONTACT (DATA ON PAGES 220 & 221)

