

4 3 2 1

THIS DRAWING IS UNPUBLISHED. RELEASED FOR PUBLICATION
 © COPYRIGHT BY TYCO ELECTRONICS CORPORATION. ALL RIGHTS RESERVED.

LOC	DIST	REVISIONS					
CP	00	P	LTR	DESCRIPTION	DATE	BY	APPD
		E		REVISED PER DS11-0088-03	6-4-03	JB	KK

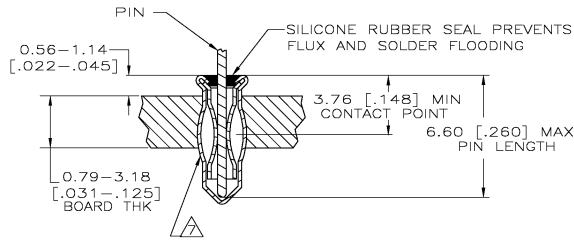
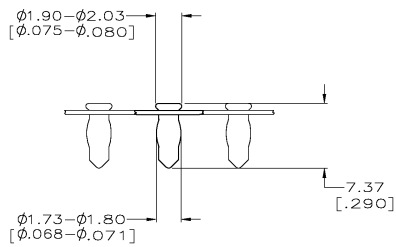
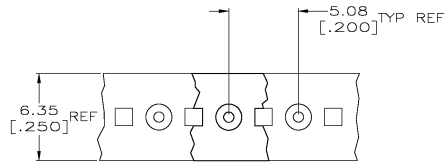

- △ MATERIAL:
 EYELET - COPPER (QQ-C-576)
 SPRING - BERYLLIUM COPPER (QQ-C-533)
 SEALANT - SILICONE RUBBER
- △ TIN PLATE (MIL-T-10727)0.00381 [.000150] MIN THK.
- △ TIN PLATE(MIL-T-10727)0.00254 [.000100] MIN THK.
- △ GOLD PL(MIL-G-45204)0.00076 [.000030] MIN THK ON CONTACT AREA.
- △ PACKAGED 50,000 PER REEL
- △ TO INSURE 1/2 OZ MIN RETENTION DO NOT EXCEED 0.10 [.004] DIFFERENCE IN PIN DIA WHEN CHANGING TO A SMALLER DIA PIN
- △ PRODUCT IS OVALIZED FOR RETENTION IN THE P.C. BOARD. THE RECOMMENDED HOLE DIAMETER IS $\phi 1.57$ [$\phi .062$] MINIMUM, +0.08 [.003] MAX. PRIOR TO SOLDERING.
- △ PACKAGED 10,000 PER REEL
- △ TIN PER ASTM B 545, 0.00254 [.000100] MIN THK.

3.76-6.60 [.148-.260]	$\phi 0.71 - \phi 0.84$ [$\phi .028 - \phi .033$]	TIN △	TIN △	△ 6-645986-1
3.76-6.60 [.148-.260]	$\phi 0.71 - \phi 0.84$ [$\phi .028 - \phi .033$]	GOLD △	TIN △	△ 1-645986-2
3.76-6.60 [.148-.260]	$\phi 0.71 - \phi 0.84$ [$\phi .028 - \phi .033$]	TIN △	TIN △	△ 1-645986-1
3.76-6.60 [.148-.260]	$\phi 0.71 - \phi 0.84$ [$\phi .028 - \phi .033$]	GOLD △	TIN △	△ 645986-2
3.76-6.60 [.148-.260]	$\phi 0.71 - \phi 0.84$ [$\phi .028 - \phi .033$]	TIN △	TIN △	△ 645986-1
LENGTH	DIA △	EYELET	SPRING	PART NO.
PIN		FINISH		

THIS DRAWING IS A CONTROLLED DOCUMENT. DW 1-24-83
 D. HOLLINGSWORTH 3-4-83
 OK M. MUTZBAUGH
 P/P/C

TYCO Electronics Tyco Electronics Corporation

MINIATURE SPRING SOCKET ASSY
 SERIES 3
 WITH SEALANT

SIZE CASE CODE DRAWING NO. RESTRICTED TO
 A2 00779 C-645986

SCALE 10:1 SHEET 1 OF 1 REV E

CUSTOMER DRAWING