

# Customer Information Sheet

DRAWING No.: H3153-XX SHEET 2 OF 2 IF IN DOUBT - ASK © NOT TO SCALE THIRD ANGLE PROJECTION ALL DIMENSIONS IN mm

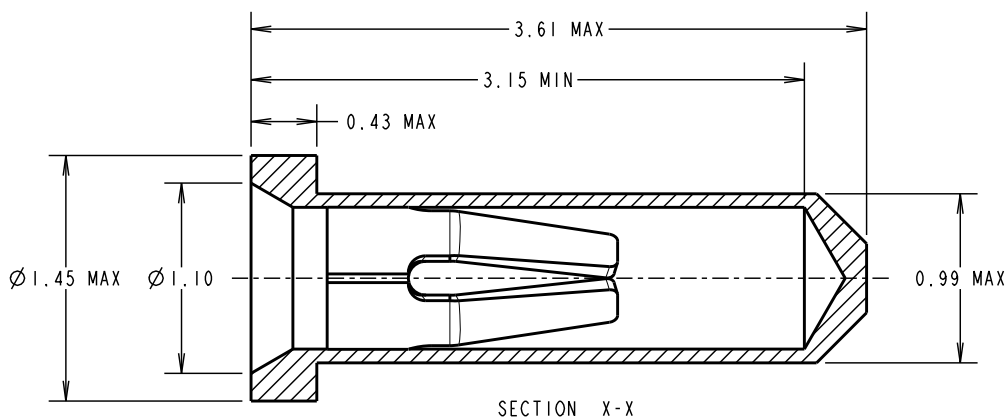

**SPECIFICATION:**

**MATERIAL:**

CONTACT SHELL = BRASS  
CONTACT CLIP = BERYLLIUM COPPER

**FINISH:**

01 = 0.1µ GOLD CLIP, 4µ TIN OVER NICKEL SHELL  
05 = 0.1µ GOLD CLIP, 0.13µ GOLD SHELL  
46 = 1.3µ 100% TIN CLIP, 4µ 100% TIN SHELL (ALL OVER NICKEL)

**ELECTRICAL:**

CURRENT RATING AT 25°C = 2A MAX  
CURRENT RATING AT 85°C = 1.75A MAX  
CONTACT RESISTANCE (INITIAL) = 15 MILLOHMS MAX  
CONTACT RESISTANCE (AFTER CONDITIONING) = 25 MILLIOHMS MAX  
DURABILITY - 01, 05 = 500 OPERATIONS  
46 = 50 OPERATIONS.

**ENVIRONMENTAL:**

OPERATING TEMPERATURE = -55°C TO +125°C  
FOR COMPLETE SPECIFICATION, SEE COMPONENT SPECIFICATION C006XX (LATEST ISSUE).

ORDER CODE:	<b>H3153-XX</b>
FINISH:	01 = GOLD CLIP, TIN SHELL 05 = GOLD CLIP, GOLD SHELL 46 = 100% TIN CLIP, 100% TIN SHELL

SM	12	15.12.10	11052
NAME	ISS.	DATE	C/NOTE
APPROVED: S. MCCULLAGH			
CHECKED: R. ADDE			
DRAWN: J. CLAY			
CUSTOMER REF.:			
ASSEMBLY DRG:			

**NOTES:**

1. RECOMMENDED PIN LENGTH = 3.15 - 2.30mm
2. RECOMMENDED MOUNTING HOLE SIZE = Ø1.10 - 1.00mm
3. RECOMMENDED PIN SIZE = Ø0.51 - 0.46mm



<b>HARWIN USA</b> TEL: 603 893 5376 FAX: 603 893 5396 mis@harwin.com	<b>HARWIN Europe (UK)</b> TEL: 023 9231 4545 FAX: 023 9231 4590 mis@harwin.co.uk	<b>HARWIN Asia</b> TEL: +65 6 779 4909 FAX: +65 6 779 3868 mis@harwin.com.sg
---	---	---

THIS DRAWING AND ANY INFORMATION OR DESCRIPTIVE MATTER SET OUT HEREON ARE CONFIDENTIAL AND COPYRIGHT PROPERTY OF THE HARWIN GROUP AND MUST NOT BE DISCLOSED, LOANED, COPIED OR USED FOR MANUFACTURING, TENDERING OR FOR ANY OTHER PURPOSE WITHOUT THEIR WRITTEN PERMISSION.

**TOLERANCES**  
X. = ±1mm  
X.X = ±0.25mm  
X.XX = ±0.10mm  
X.XXX = ±0.01mm  
ANGLES = ±5°  
UNLESS STATED

**MATERIAL:** SEE ABOVE  
**FINISH:** SEE ABOVE  
**S/AREA:** mm<sup>2</sup>

**TITLE:** SUB-MINIATURE SOCKET ASSEMBLY  
**DRAWING NUMBER:** H3153-XX

SHT 2 OF 2