

4

3

2

1

THIS DRAWING IS UNPUBLISHED. RELEASED FOR PUBLICATION
 © COPYRIGHT BY TYCO ELECTRONICS CORPORATION. ALL RIGHTS RESERVED.

LOC	DIST	REVISIONS		
F	L/R	DESCRIPTION	DATE	BY/APP'D
AF	50			
J		REVISED PER ECR-06-010427	31AUG06	HMR KR

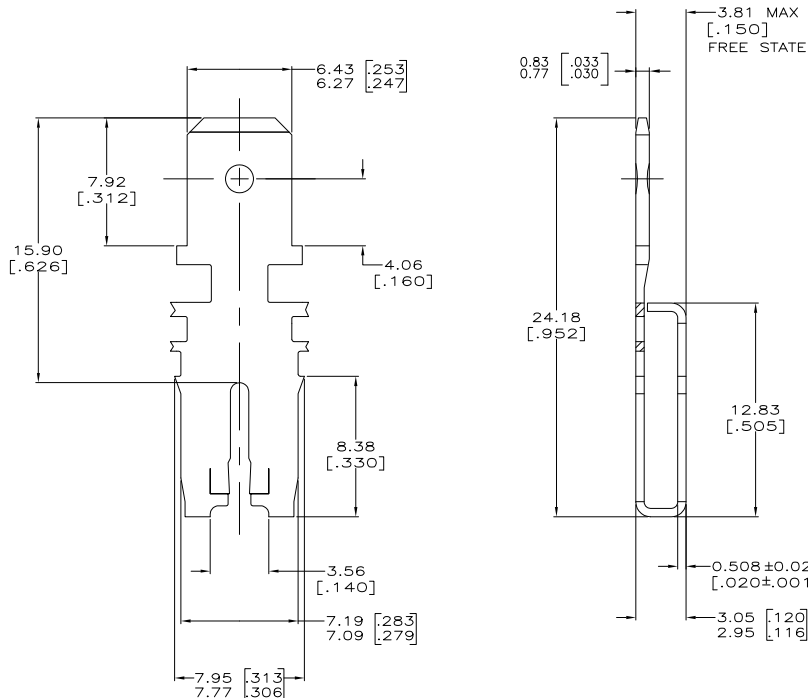
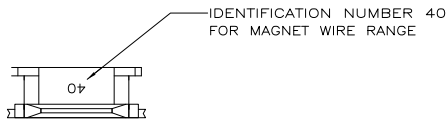

- 1 CONTINUOUS STRIP ON REELS WITH TERMINALS LOCATED ON 8.38±0.08[.330±.003] CENTERS.
- 2 SLOT ACCEPTS 1.45-1.29mm DIA [#15-#16] AWG COPPER MAGNET WIRE. TWO WIRES OF THE SAME SIZE MAX PER SLOT.
- 3 AFTER INSERTION INTO PLASTIC HOLDER, TAB PORTION MUST BE BENT OVER 45° TO 90° OR POTTED-IN TO PREVENT PULL-OUT WHEN MATING RECEPTACLE IS DISCONNECTED.
- 4 VARNISH RESIST OVER 0.002032 [.000080] MIN TIN PLATE.
- 5 PRELIMINARY - NOT FOR PRODUCTION.

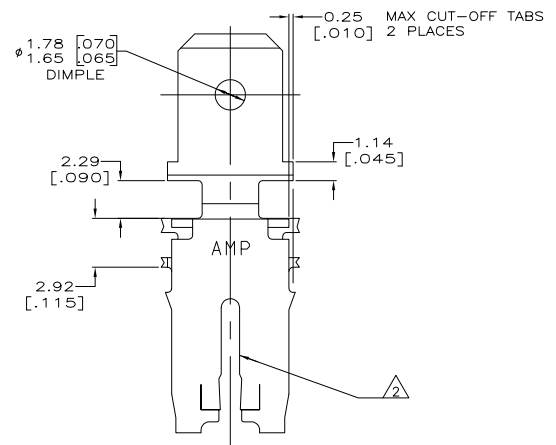

H04 PRE-MILLED PHOS BRONZE	63064-2
4M PRE-MILLED BRASS	63064-1
MATERIAL	PART NUMBER

THIS DRAWING IS A CONTROLLED DOCUMENT.		DWG: MICHAEL S. FEYER 07MAY1999 CHK: JEFF R. RUTH 07JUN1999 NAME: KURT A. RANDOLPH PRODUCT SPEC: 108-2053 APPLICATION SPEC: 114-2066 WEIGHT: - FINISH: -	Tyco Electronics Corporation Harrisburg, PA 17105-3608 Tyco Electronics TAB, 6.35 [.250] FASTON, 500 SERIES MAG-MATE	SIZE: A2 CASE CODE: 00779 DRAWING NO: C=63064	RESTRICTED TO: - SCALE: 6:1 SHEET: 1 of 1 REV: J
DIMENSIONS: mm [INCHES]	0 PLC # - 1 PLC # - 2 PLC # - 3 PLC # - 4 PLC # - ANGLES # - FINISH # -	CUSTOMER DRAWING			

AMP 1471-9 REV 31MMR2000

63064

A