

THIS DRAWING IS UNPUBLISHED. RELEASED FOR PUBLICATION  
 COPYRIGHT BY TYCO ELECTRONICS CORPORATION. ALL RIGHTS RESERVED.

LOC	QST	REVISIONS			
TR	LR	DESCRIPTION	DATE	DR	APP
AF	50	A	REVISED PER ECR-06-010412	06NOV06	HMR KR

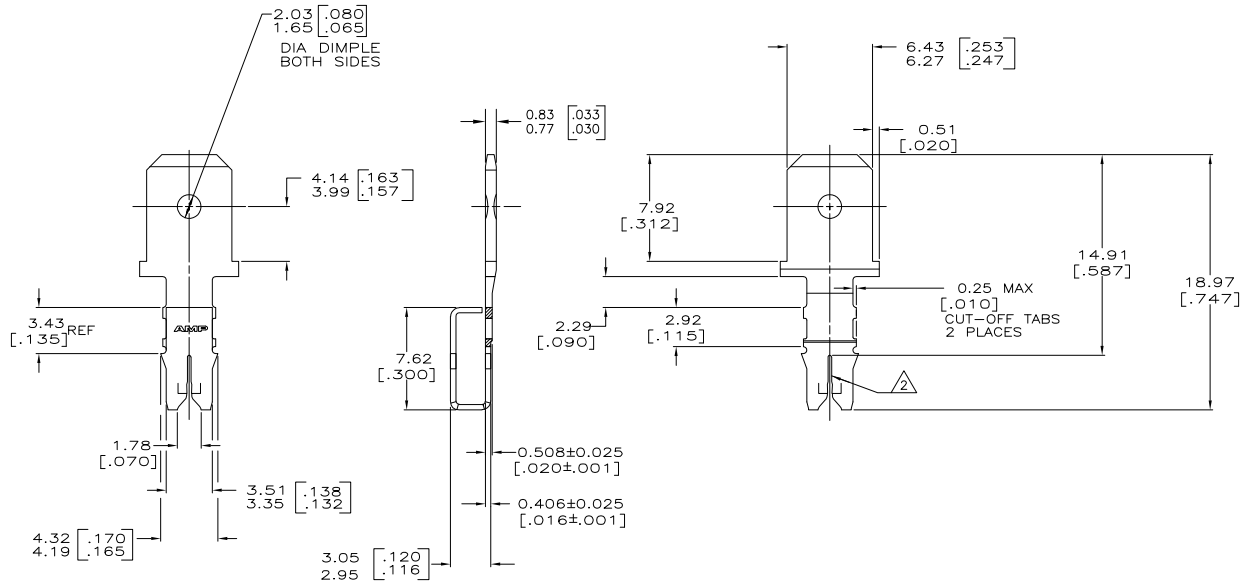

- CONTINUOUS STRIP ON REELS WITH TERMINALS LOCATED ON  $8.38 \pm 0.08$  [ $.330 \pm .003$ ] CENTERS. SLOT TERMINATES EITHER SINGLE OR DOUBLE MAGNET WIRES OF THE SAME TYPE AND SIZE, COPPER RANGE IS  $0.36-0.57\text{mm}$  [#27-#23] AWG.
- AFTER INSERTION INTO PLASTIC HOLDER TAB PORTION MUST BE BENT OVER  $45^\circ$  TO  $90^\circ$  OR POTTED-IN TO PREVENT PULL-OUT WHEN MATING RECEPTACLE IS DISCONNECTED.



62657-1  
PART NO

THIS DRAWING IS A CONTROLLED DOCUMENT.		DRN MICHAEL S. FELNER 13/AM/93	Tyco Electronics Corporation																									
DIMENSIONS: TO DIMENSIONS UNLESS OTHERWISE SPECIFIED:		DRS RICHARD GRZYBOWSKI 14/AM/93	Harrisburg, PA 17105-3608																									
mm [INCHES]		APP NELSON F. NEFF 20/AM/93	TAB, 6.35 [.250] FASTON™, LOOSE PIECE, MAG-MATE™																									
<table border="1"> <tr> <td>Ø</td> <td>FPC</td> <td>±</td> <td>-</td> </tr> <tr> <td>1</td> <td>FPC</td> <td>±</td> <td>0.25 [.010]</td> </tr> <tr> <td>2</td> <td>FPC</td> <td>±</td> <td>-</td> </tr> <tr> <td>3</td> <td>FPC</td> <td>±</td> <td>-</td> </tr> <tr> <td>4</td> <td>FPC</td> <td>±</td> <td>-</td> </tr> <tr> <td>5</td> <td>FPC</td> <td>±</td> <td>-</td> </tr> </table>		Ø	FPC	±	-	1	FPC	±	0.25 [.010]	2	FPC	±	-	3	FPC	±	-	4	FPC	±	-	5	FPC	±	-	PRODUCT SPEC 108-2012	SIZE A2	CAGE CODE 00779
Ø	FPC	±	-																									
1	FPC	±	0.25 [.010]																									
2	FPC	±	-																									
3	FPC	±	-																									
4	FPC	±	-																									
5	FPC	±	-																									
MATERIAL 02Z PFC-MILLED BRASS		FINISH 01002032 [.000080] WN TN PER ML-1-10727	APPLICATION SPEC 114-2046	DRAWING NO 62657																								
		WEIGHT -	CUSTOMER DRAWING	RESTRICTED TO -																								
			SCALE 5:1	SHEET 1 of 1																								

AMP 1471-B REV 31MMR2000

62657

A