

4

3

2

1

THIS DRAWING IS UNPUBLISHED. RELEASED FOR PUBLICATION. (C) COPYRIGHT IS BY AMP INCORPORATED. ALL RIGHTS RESERVED.

REV	DATE	BY	APP'D	DESCRIPTION
B	12/14/01	TRF	KR	REVISED STATUS PER 063A-03329-01



- CONTINUOUS STRIP ON REELS WITH TERMINALS LOCATED ON 5.59±0.08 [.220±.003] CENTERS.
- SLOT ACCEPTS A 7 STRAND TINSEL WIRE. 0.79±0.08 [.031±.003] DIA.
- AFTER INSERTION INTO PLASTIC HOLDER TAB PORTION MUST BE BENT OVER 45° TO 90°, OR POTTED TO PREVENT PULL-OUT WHEN MATING RECEPTACLE IS DISCONNECTED.

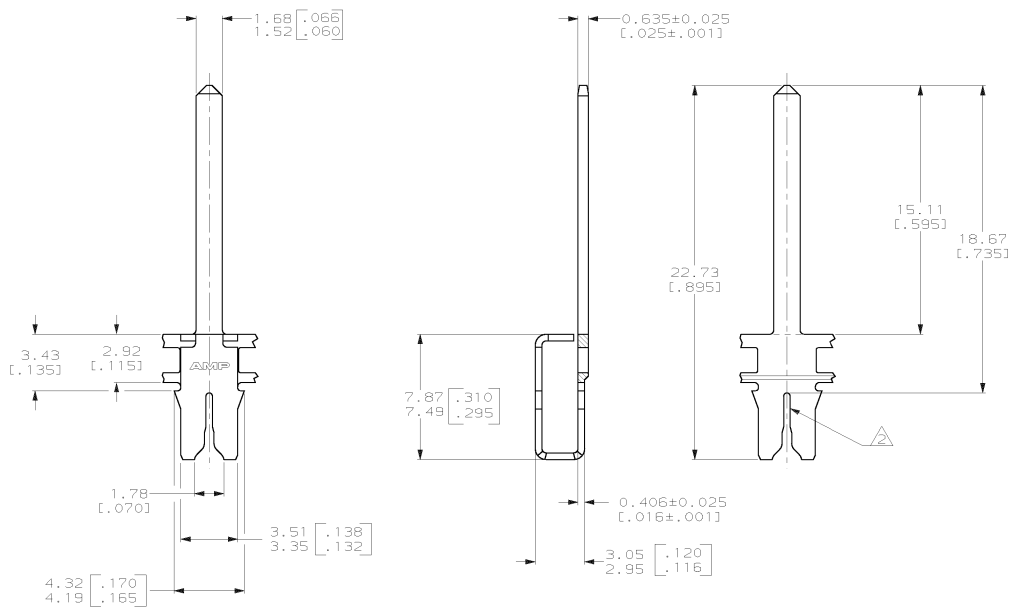

1217595-1
PART NUMBER

THIS DRAWING IS A CONTROLLED DOCUMENT.		DATE: 12/14/01	BY: TRF	APP'D: KR
DRAWN BY: J. RUTH		AMP INCORPORATED HARRISBURG, PA 17105-3608		
CHECKED BY: J. FISHER		AMP		
PROJECT: 108-2012		TAB, 1.60[.063] SERIES, MAG-MATE™		
APPLICATION SPEC: 114-2046		SIZE: A2		
MATERIAL: H04 PRE-MILLED BRASS		CASE CODE: 00779		
FINISH: 0.002032[.000801] MIN TIN PER		DRAWING NO: C-1217595		
CUSTOMER DRAWING		SCALE: 6:1 SHEET: 1 OF 1 REV: B		

1217595

A