

4

3

2

1

THIS DRAWING IS UNPUBLISHED. RELEASED FOR PUBLICATION.
 © COPYRIGHT BY TYCO ELECTRONICS CORPORATION. ALL INTERNATIONAL RIGHTS RESERVED.

LOC	DIST	REVISIONS		
F	LR	DESCRIPTION	DATE	BY
AF	50	E2	REVISED PER ECR-10-013120	24JUN10 HMR GJ

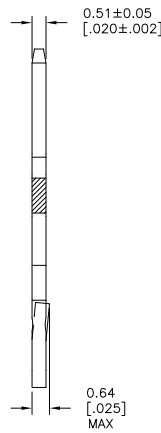
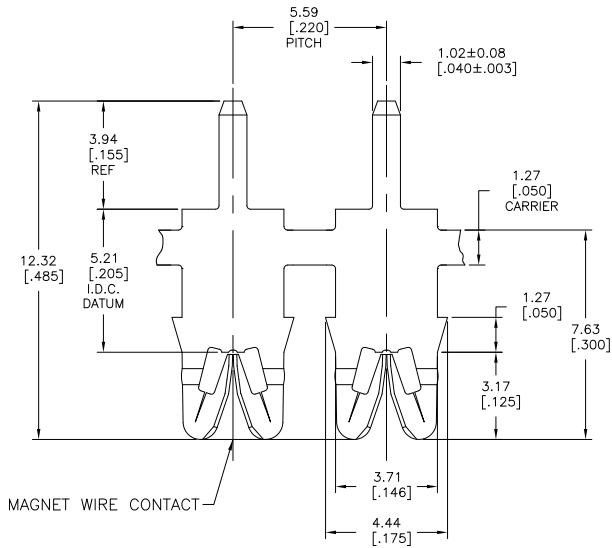

- SPECIFICATIONS:
MAGNET WIRE #18 - #34 AWG,
1.02[040] - 0.16[006] DIA COPPER.
OTHER SIZES MAY BE ACCOMMODATED.
CONSULT TYCO ELECTRONICS FOR APPROVAL.
- POCKET RECOMMENDATION: #1601425
- TERMINAL APPLICATION TO COMPLY WITH TYCO ELECTRONICS SPECIFICATION 114-13166 FIGURE 7.
- TWO(2) TERMINALS SHOWN FOR ILLUSTRATION PURPOSES ONLY.

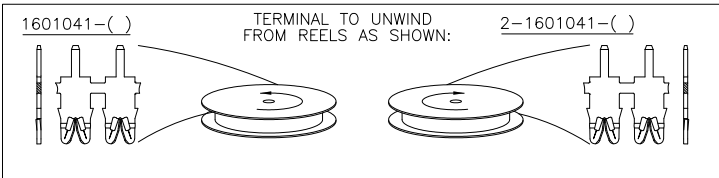
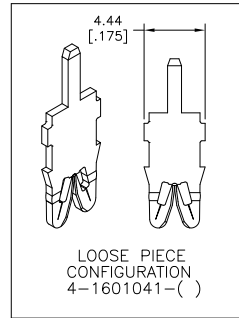

	POST TIN PLATE OVER NICKEL	-	4-1601041-3
	POST TIN PLATE OVER NICKEL	-	1601041-3
SUPERSEDED BY 4-1601041-3	SELECTIVE POST TIN LEAD PLATE OVER NICKEL	031-087-024	4-1601041-2
	UNPLATED	031-087-000	4-1601041-1
SUPERSEDED BY 1601041-3	SELECTIVE POST TIN LEAD PLATE OVER NICKEL	131-087-024	1601041-2
	UNPLATED	131-087-000	1601041-1
	FINISH	REFERENCE PART NUMBER	TE PART NUMBER

THIS DRAWING IS A CONTROLLED DOCUMENT.		DATE	11JAN2002	BY	J. WELLS
DIMENSIONS: mm [INCHES]		DATE	11JAN2002	BY	M. FEHER
TOLERANCES UNLESS OTHERWISE SPECIFIED:		DATE	11JAN2002	BY	K. RANDOLPH
0 PL	±	PRODUCT SPEC	108-2085	NAME	
1 PL	±	APPLICATION SPEC		SIZE	A2
2 PL	±			Q&E CODE	C=1601041
3 PL	±			DRAWING NO	
4 PL	±				
ANGLES	± °				
MATERIAL	BRASS, SPRING HARD	WEIGHT	-	RESTRICTED TO	-
FINISH	SEE TABLE	CUSTOMER DRAWING		SCALE	10:1
				SHEET	1 of 1
				REV	E2