

4

3

2

1

THIS DRAWING IS UNPUBLISHED. RELEASED FOR PUBLICATION  
 © COPYRIGHT BY TYCO ELECTRONICS CORPORATION. ALL RIGHTS RESERVED.

LOC	DIST	REVISIONS			
P	LTR	DESCRIPTION	DATE	MIN	APD
C		REV PER 063A-072B-04	070CT2004	RF	KR

IDENTIFICATION NUMBER 15  
 FOR MAGNET WIRE RANGE

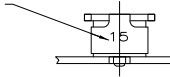

- 1 CONTINUOUS STRIP ON REELS WITH TERMINALS LOCATED ON 5.59 [.220] CENTERS.
- △ 2 SLOT TERMINATES A SINGLE COPPER MAGNET WIRE ONLY. COPPER RANGE: 0.64-0.81mm [#22-#20] AWG.
- △ 3 0.00254 [.000100] MIN TIN ALL OVER
- 0.00254 [.000100] MIN COPPER UNDERPLATE

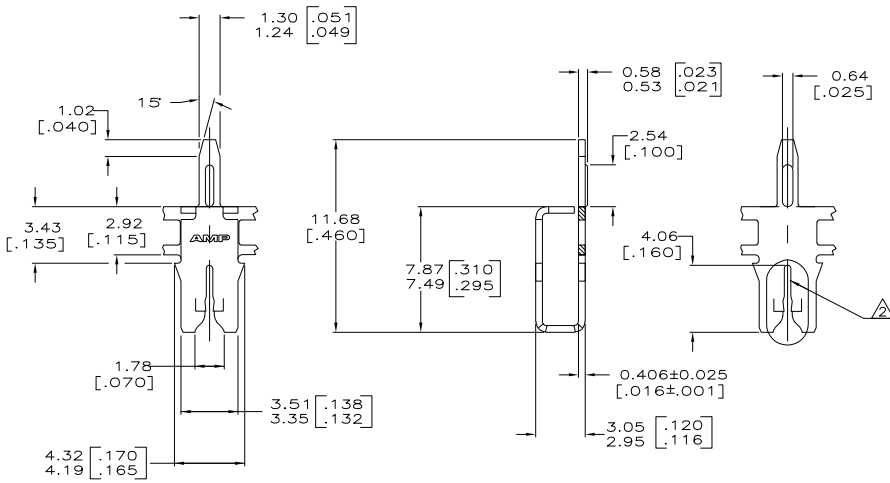

63660-1  
 PART NUMBER

THIS DRAWING IS A CONTROLLED DOCUMENT.		DRN	MICHAEL S. FEHR	8/14/92	Tyco Electronics Corporation Harrisburg, PA 17105-3608
		OK	PHILLIP M. FORTNEY	8/18/92	
DIMENSIONS:		TOLERANCES UNLESS OTHERWISE SPECIFIED:		PRODUCT SPEC	
INCHES		FRACTIONS		108-2012	
Ø		± .005		APPLICATION SPEC	
Ø		± .010		114-2046	
Ø		± .015		SIZE	
Ø		± .020		A2	
Ø		± .025		CAGE CODE	
Ø		± .030		DRAWING NO	
Ø		± .035		C-63660	
Ø		± .040		RESTRICTED TO	
Ø		± .045		-	
Ø		± .050		-	
Ø		± .055		-	
Ø		± .060		-	
Ø		± .065		-	
Ø		± .070		-	
Ø		± .075		-	
Ø		± .080		-	
Ø		± .085		-	
Ø		± .090		-	
Ø		± .095		-	
Ø		± .100		-	
Ø		± .105		-	
Ø		± .110		-	
Ø		± .115		-	
Ø		± .120		-	
Ø		± .125		-	
Ø		± .130		-	
Ø		± .135		-	
Ø		± .140		-	
Ø		± .145		-	
Ø		± .150		-	
Ø		± .155		-	
Ø		± .160		-	
Ø		± .165		-	
Ø		± .170		-	
Ø		± .175		-	
Ø		± .180		-	
Ø		± .185		-	
Ø		± .190		-	
Ø		± .195		-	
Ø		± .200		-	
Ø		± .205		-	
Ø		± .210		-	
Ø		± .215		-	
Ø		± .220		-	
Ø		± .225		-	
Ø		± .230		-	
Ø		± .235		-	
Ø		± .240		-	
Ø		± .245		-	
Ø		± .250		-	
Ø		± .255		-	
Ø		± .260		-	
Ø		± .265		-	
Ø		± .270		-	
Ø		± .275		-	
Ø		± .280		-	
Ø		± .285		-	
Ø		± .290		-	
Ø		± .295		-	
Ø		± .300		-	
Ø		± .305		-	
Ø		± .310		-	
Ø		± .315		-	
Ø		± .320		-	
Ø		± .325		-	
Ø		± .330		-	
Ø		± .335		-	
Ø		± .340		-	
Ø		± .345		-	
Ø		± .350		-	
Ø		± .355		-	
Ø		± .360		-	
Ø		± .365		-	
Ø		± .370		-	
Ø		± .375		-	
Ø		± .380		-	
Ø		± .385		-	
Ø		± .390		-	
Ø		± .395		-	
Ø		± .400		-	
Ø		± .405		-	
Ø		± .410		-	
Ø		± .415		-	
Ø		± .420		-	
Ø		± .425		-	
Ø		± .430		-	
Ø		± .435		-	
Ø		± .440		-	
Ø		± .445		-	
Ø		± .450		-	
Ø		± .455		-	
Ø		± .460		-	
Ø		± .465		-	
Ø		± .470		-	
Ø		± .475		-	
Ø		± .480		-	
Ø		± .485		-	
Ø		± .490		-	
Ø		± .495		-	
Ø		± .500		-	
Ø		± .505		-	
Ø		± .510		-	
Ø		± .515		-	
Ø		± .520		-	
Ø		± .525		-	
Ø		± .530		-	
Ø		± .535		-	
Ø		± .540		-	
Ø		± .545		-	
Ø		± .550		-	
Ø		± .555		-	
Ø		± .560		-	
Ø		± .565		-	
Ø		± .570		-	
Ø		± .575		-	
Ø		± .580		-	
Ø		± .585		-	
Ø		± .590		-	
Ø		± .595		-	
Ø		± .600		-	
Ø		± .605		-	
Ø		± .610		-	
Ø		± .615		-	
Ø		± .620		-	
Ø		± .625		-	
Ø		± .630		-	
Ø		± .635		-	
Ø		± .640		-	
Ø		± .645		-	
Ø		± .650		-	
Ø		± .655		-	
Ø		± .660		-	
Ø		± .665		-	
Ø		± .670		-	
Ø		± .675		-	
Ø		± .680		-	
Ø		± .685		-	
Ø		± .690		-	
Ø		± .695		-	
Ø		± .700		-	
Ø		± .705		-	
Ø		± .710		-	
Ø		± .715		-	
Ø		± .720		-	
Ø		± .725		-	
Ø		± .730		-	
Ø		± .735		-	
Ø		± .740		-	
Ø		± .745		-	
Ø		± .750		-	
Ø		± .755		-	
Ø		± .760		-	
Ø		± .765		-	
Ø		± .770		-	
Ø		± .775		-	
Ø		± .780		-	
Ø		± .785		-	
Ø		± .790		-	
Ø		± .795		-	
Ø		± .800		-	
Ø		± .805		-	
Ø		± .810		-	
Ø		± .815		-	
Ø		± .820		-	
Ø		± .825		-	
Ø		± .830		-	
Ø		± .835		-	
Ø		± .840		-	
Ø		± .845		-	
Ø		± .850		-	
Ø		± .855		-	
Ø		± .860		-	
Ø		± .865		-	
Ø		± .870		-	
Ø		± .875		-	
Ø		± .880		-	
Ø		± .885		-	
Ø		± .890		-	
Ø		± .895		-	
Ø		± .900		-	
Ø		± .905		-	
Ø		± .910		-	
Ø		± .915		-	
Ø		± .920		-	
Ø		± .925		-	
Ø		± .930		-	
Ø		± .935		-	
Ø		± .940		-	
Ø		± .945		-	
Ø		± .950		-	
Ø		± .955		-	
Ø		± .960		-	
Ø		± .965		-	
Ø		± .970		-	
Ø		± .975		-	
Ø		± .980		-	
Ø		± .985		-	
Ø		± .990		-	
Ø		± .995		-	
Ø		± 1.000		-	
Ø		± 1.005		-	
Ø		± 1.010		-	
Ø		± 1.015		-	
Ø		± 1.020		-	
Ø		± 1.025		-	
Ø		± 1.030		-	
Ø		± 1.035		-	
Ø		± 1.040		-	
Ø		± 1.045		-	
Ø		± 1.050		-	
Ø		± 1.055		-	
Ø		± 1.060		-	
Ø		± 1.065		-	
Ø		± 1.070		-	
Ø		± 1.075		-	
Ø		± 1.080		-	
Ø		± 1.085		-	
Ø		± 1.090		-	
Ø		± 1.095		-	
Ø		± 1.100		-	
Ø		± 1.105		-	
Ø		± 1.110		-	
Ø		± 1.115		-	
Ø		± 1.120		-	
Ø		± 1.125		-	
Ø		± 1.130		-	
Ø		± 1.135		-	
Ø		± 1.140		-	
Ø		± 1.145		-	
Ø		± 1.150		-	
Ø		± 1.155		-	
Ø		± 1.160		-	
Ø		± 1.165		-	
Ø		± 1.170		-	
Ø		± 1.175		-	
Ø		± 1.180		-	
Ø		± 1.185		-	
Ø		± 1.190		-	
Ø		± 1.195		-	
Ø		± 1.200		-	
Ø		± 1.205		-	
Ø		± 1.210		-	
Ø		± 1.215		-	
Ø		± 1.220		-	
Ø		± 1.225		-	
Ø		± 1.230		-	
Ø		± 1.235		-	
Ø		± 1.240		-	
Ø		± 1.245		-	
Ø		± 1.250		-	
Ø		± 1.255		-	
Ø		± 1.260		-	
Ø		± 1.265		-	
Ø		± 1.270		-	
Ø		± 1.275		-	
Ø		± 1.280		-	
Ø		± 1.285		-	
Ø		± 1.290		-	
Ø		± 1.295		-	
Ø		± 1.300		-	
Ø		± 1.305		-	
Ø		± 1.310		-	
Ø		± 1.315		-	
Ø		± 1.320		-	
Ø		± 1.325		-	
Ø		± 1.330		-	
Ø		± 1.335		-	
Ø		± 1.340		-	
Ø		± 1.345		-	
Ø		± 1.350		-	
Ø		± 1.355</			