

4

3

2

1

THIS DRAWING IS UNPUBLISHED. RELEASED FOR PUBLICATION
 © COPYRIGHT BY TYCO ELECTRONICS CORPORATION. ALL RIGHTS RESERVED.

| LOC | | DIST | | REVISIONS | | | |
|-----|-----|----------------------|-----------|-----------|-----|--|--|
| P | LTR | DESCRIPTION | DATE | MIN | APD | | |
| C | | REV PER 063A-072B-04 | 070CT2004 | RF | KR | | |

IDENTIFICATION NUMBER 24
 FOR MAGNET WIRE RANGE

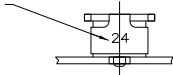

- 1 CONTINUOUS STRIP ON REELS WITH TERMINALS LOCATED ON 5.59 [.220] CENTERS.
- △ 2 SLOT TERMINATES A SINGLE COPPER MAGNET WIRE ONLY. COPPER RANGE: 0.91-1.15mm [#19-#17] AWG.
- △ 3 0.00254 [.000100] MIN TIN ALL OVER
0.00254 [.000100] MIN COPPER UNDERPLATE

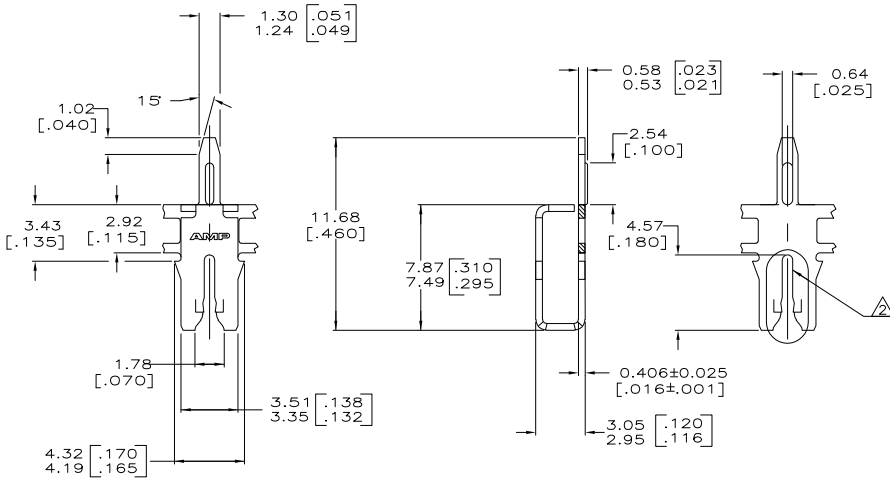

63661-1
 PART NUMBER

| | | | | | |
|--|--|--|---------|---|---------------------------|
| THIS DRAWING IS A CONTROLLED DOCUMENT. | | DRN | 8/14/92 | Tyco Electronics Corporation Harrisburg, PA 17105-3608 | POST, SOLDER, MAG-MATE |
| | | OK | 8/18/92 | | |
| | | PHILLIP M. FORTNEY | NAME | | |
| DIMENSIONS: | | TOLERANCES UNLESS OTHERWISE SPECIFIED: | | PRODUCT SPEC | |
| INCHES | | FRACTIONS | | 108-2012 | |
| Ø | | ± | | APPLICATION SPEC | |
| Ø | | ± .25 (ø10) | | 114-2046 | |
| Ø | | ± | | SIZE | |
| Ø | | ± | | A2 | |
| Ø | | ± | | CAGE CODE | |
| Ø | | ± | | 00779 | |
| Ø | | ± | | DRAWING NO | |
| Ø | | ± | | C-63661 | |
| Ø | | ± | | RESTRICTED TO | |
| Ø | | ± | | - | |
| Ø | | ± | | SCALE | |
| Ø | | ± | | 6:1 | |
| Ø | | ± | | SHEET | |
| Ø | | ± | | 1 OF 1 | |
| Ø | | ± | | REV | |
| Ø | | ± | | C | |

AMP 1471-9 REV 31MM2000