

4

3

2

1

THIS DRAWING IS UNPUBLISHED. RELEASED FOR PUBLICATION
 © COPYRIGHT BY TYCO ELECTRONICS CORPORATION. ALL RIGHTS RESERVED.

LOC	DIST	REVISIONS			
P	LTR	DESCRIPTION	DATE	MIN	APD
AF	50				
B		REVISED PER 0G3A-0067-05	7FEB05	MF	KR

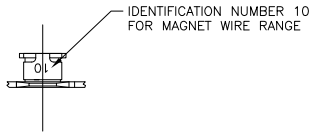

- 1 CONTINUOUS STRIP ON REELS WITH TERMINALS LOCATED ON 5.59±0.08 [.220±.003] CENTERS.
 - 2 AFTER INSERTION INTO PLASTIC HOLDER TAB PORTION MUST BE BENT 45° TO 90° OR POTTED-IN TO PREVENT PULL-OUT WHEN MATING RECEPTACLE IS DISCONNECTED.
- △ 3 SLOT TERMINATES EITHER SINGLE OR DOUBLE MAGNET WIRE OF THE SAME SIZE AND TYPE.
 COPPER RANGE: 0.36-0.57mm [#27-#23] AWG.
- △ 4 0.002032 [.000080] MIN TIN PLATE.

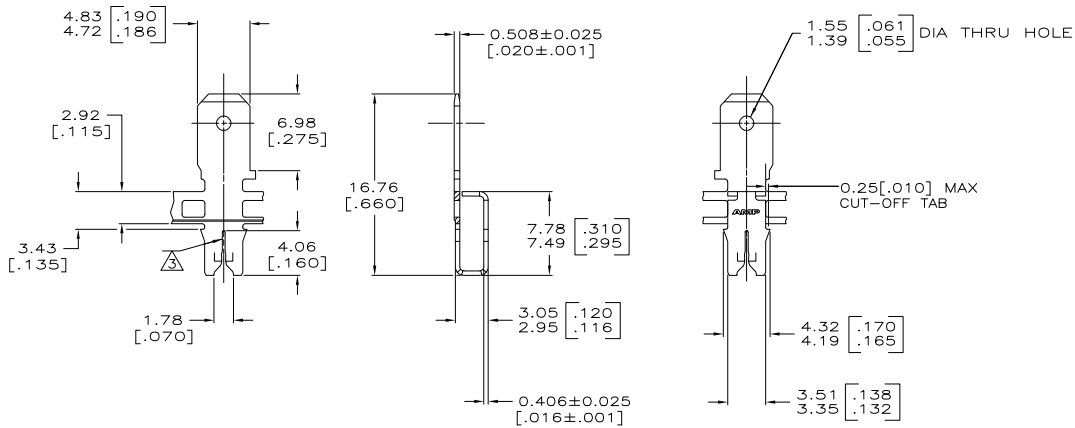

△ 4	63585-1
FINISH	PART NUMBER

THIS DRAWING IS A CONTROLLED DOCUMENT.		DWG: MICHAEL S. FEHLER 7FEB02005 OK: KURT A. RANDOLPH 7FEB02005 APP'D: KURT A. RANDOLPH 7FEB02005 PRODUCT SPEC: 108-2012 APPLICATION SPEC: 114-2046 HEIGHT: - FINISH: - SEE TABLE	Tyco Electronics Tyco Electronics Corporation Harrisburg, Pa 17105-3608 TAB, 4.75 [.187] FASTON, 300 SERIES MAG-MATE SIZE: A2 CHG CODE: 00779 DRAWING NO: C-63585 SCALE: 4:1 SHEET: 1 OF 1 REV: B	FINISH: △ 4 PART NUMBER: 63585-1 RESTRICTED TO: -
--	--	--	--	---

AMP 1471-9 REV 31MM2000

63585