

DRAWING MADE IN THIRD ANGLE PROJECTION

THIS DRAWING IS UNPUBLISHED. RELEASED FOR PUBLICATION
 © COPYRIGHT 19 BY AMP INCORPORATED, HARRISBURG, PA. ALL INTERNATIONAL RIGHTS RESERVED. AMP PRODUCTS MAY BE COVERED BY U.S. AND FOREIGN PATENTS AND/OR PATENTS PENDING.

LOC	DIST	P	F	ZONE	LTR	DESCRIPTION	DATE	APPROVED
AF	50				B	REV & REDRAWN AF-5094	1/20/88	MSF

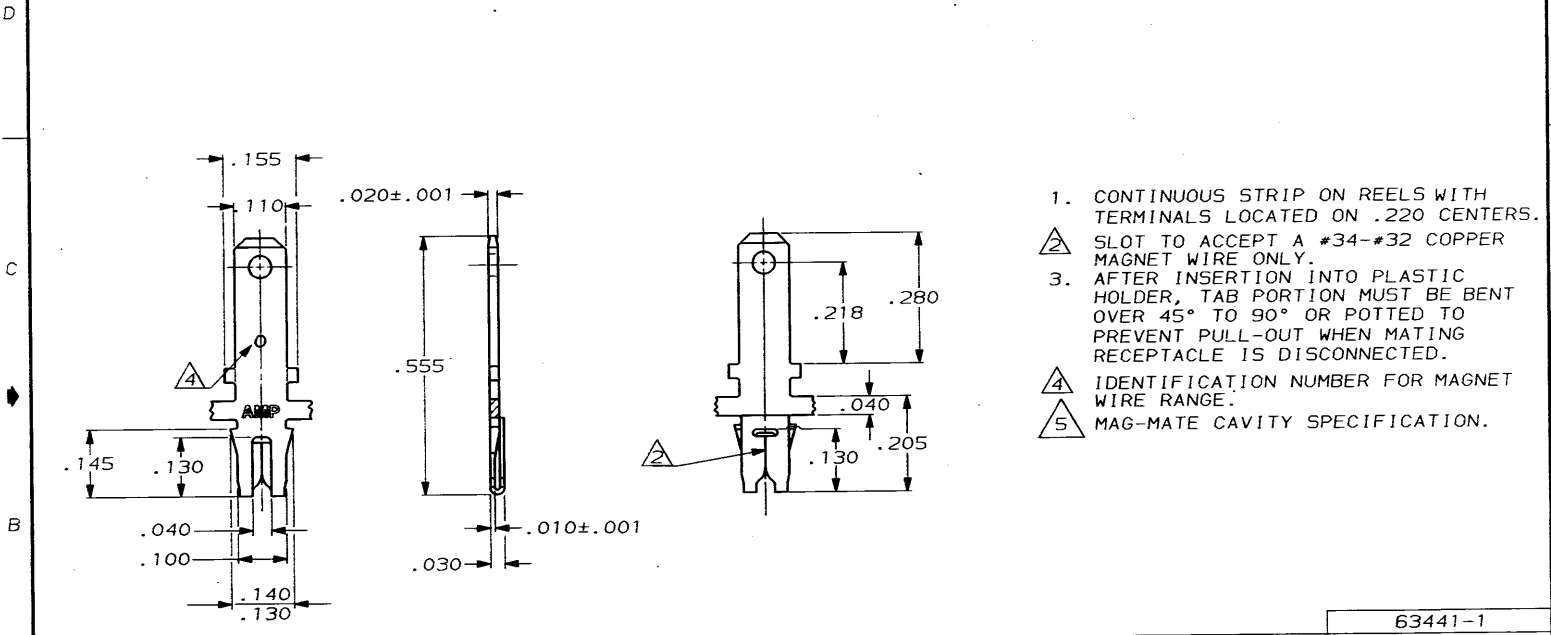

1. CONTINUOUS STRIP ON REELS WITH TERMINALS LOCATED ON .220 CENTERS.
2. SLOT TO ACCEPT A #34-#32 COPPER MAGNET WIRE ONLY.
3. AFTER INSERTION INTO PLASTIC HOLDER, TAB PORTION MUST BE BENT OVER 45° TO 90° OR POTTED TO PREVENT PULL-OUT WHEN MATING RECEPTACLE IS DISCONNECTED.
4. IDENTIFICATION NUMBER FOR MAGNET WIRE RANGE.
5. MAG-MATE CAVITY SPECIFICATION.

63441-1
PART NO

UNLESS OTHERWISE SPECIFIED DIMENSIONS ARE IN INCHES TOLERANCES ON: 2 PL DEC ± - 3 PL DEC ± .010 ANGLES ± -		DR <i>MSF</i> 1/20/88 CHK <i>G. Yette</i> 1/22/88 APP <i>E. T. [unclear]</i> 1/20/88 P. [unclear] 1/20/88	AMP INCORPORATED Harrisburg, Pa. 17105	
MATERIAL #4 HARD BRASS	PRODUCT SPEC -	NAME TAB, .110 FASTON, MAG-MATE™ MICRO	SIZE B	FSCM NO 00779
FINISH TIN	APPLICATION SPEC 114-2099 5	DRAWING NO 63441	SCALE 5:1	SHEET 1 OF 1
WEIGHT -				

AMP 1470-15 REV 10-84

CUSTOMER DRAWING