

DRAWING MADE IN THIRD ANGLE PROJECTION
 THIS DRAWING IS UNPUBLISHED. RELEASED FOR PUBLICATION
 © COPYRIGHT 19 BY AMP INCORPORATED. ALL INTERNATIONAL RIGHTS RESERVED.

LOC		DIST		ZONE		LTR		REVISIONS		DATE	APPO
AF	50	P	F					AD	ADDED -6 PER 063A-0271-01	179X101	MF-KR

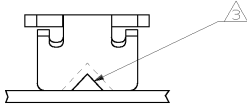

- 1 CONTINUOUS STRIP ON REELS WITH TERMINALS LOCATED ON 5.59±0.08 [.220±.003] CENTERS.
- △ SLOT ACCEPTS 0.64-0.81mm [#22-#20] AWG COPPER MAGNET WIRE. A SINGLE WIRE ONLY.
- △ POKE-IN ACCEPTS A 0.81-1.02mm² [#20-#18] AWG SOLID OR FUSED STRANDED LEAD WIRE.
- △ 0.002032 [.000080] MIN TIN.
- △ VARNISH RESIST OVER 0.002032 [.000080] MIN TIN.
- △ SPECIAL REEL QUANTITY FOR AMP SPAIN PRODUCTION ONLY.
- △ PRELIMINARY - NOT FOR PRODUCTION.

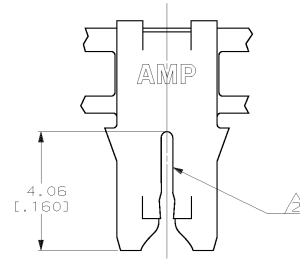
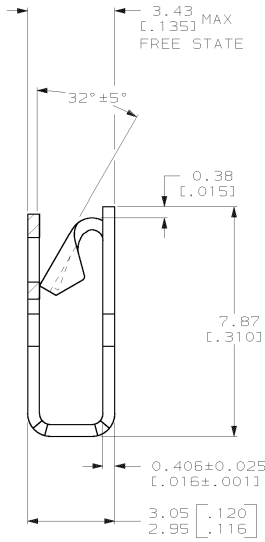
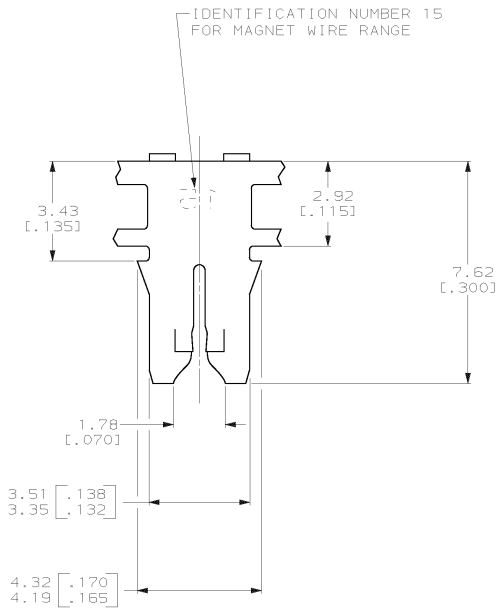

REVERSE	WELD	CARDBOARD REEL	4M BRASS	△	△	62420-6
STANDARD	SPLICE FREE	PLASTIC REEL	4M BRASS	△	△	62420-5
STANDARD	WELD	CARDBOARD REEL	HO4 PHOSPHOR BRONZE	△		62420-4
STANDARD	WELD	CARDBOARD REEL	4M BRASS	△	△	62420-3
STANDARD	WELD	CARDBOARD REEL	4M BRASS	△		62420-2
STANDARD	WELD	CARDBOARD REEL	4M BRASS	△		62420-1
REELING DIRECTION	SPLICE	REELING MATERIAL	MATERIAL	FINISH		PART NO

DO NOT SCALE PRINT. UNLESS SPECIFIED DIMENSIONS IN mm (INCHES) TOLERANCES ON: 2 PLC DEC ± 0.25 (.010) 3 PLC DEC ± ANGLES ± -	DR 5/19/92 MICHAEL S. FEHER	AMP Incorporated Harrisburg, PA 17105-3608
MATERIAL	CHK 5/29/92 JEFF R. RUTH	
SEE TABLE	APPD 5/21/92 NELSON E. NEFF	NAME
FINISH	APPD 5/21/92 TERRY L. SHUTTER	TERMINAL, POKE-IN, 300 SERIES MAG-MATE™
SEE TABLE	PRODUCT SPEC 108-2012	SIZE CAGE CODE DRAWING NO
	APPLICATION SPEC 114-2046	00779 62420
	WEIGHT -	SCALE 10:1 SHEET 1 OF 1