

4

3

2

1

THIS DRAWING IS UNPUBLISHED. RELEASED FOR PUBLICATION .19  
 © COPYRIGHT 19 BY AMP INCORPORATED. ALL RIGHTS RESERVED.

LOC	DIST	REVISIONS			
P	LTR	DESCRIPTION	DATE	DWN	APVD
AF	50	C	REVISED PER 0G3A-0280-02	03JUN02	MF GP

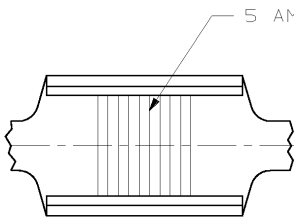

1 CONTINUOUS STRIP ON REELS.

2 WIRE SIZE IS 1500-5000 CMA  $\Delta$

$\Delta$  CRIMP WIDTH: .110 F TYPE (AMPLIVAR THRU)  
 CRIMP HEIGHT ( $\pm$ .002) = (TOTAL CMA + 10,700) / 193,400  
 GENERAL APPLICATION GUIDELINES MUST BE FOLLOWED AS SPECIFIED IN CATALOG #82221  
 FOR APPLICATOR INFORMATION CALL: 1-800-722-1111  
 FOR PRODUCT INFORMATION CALL: 1-800-522-6752

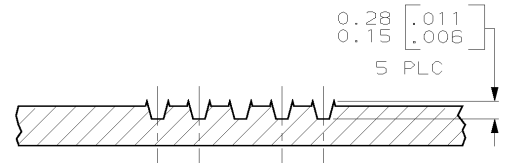
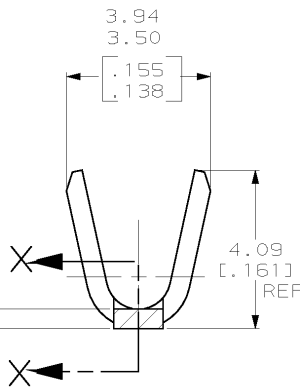
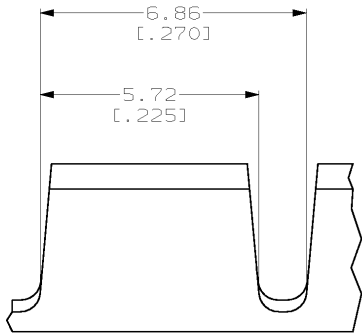

SECTION A-A  
 SCALE 20:1

41899
PART NO.

THIS DRAWING IS A CONTROLLED DOCUMENT.		DWN JR RUTH	ORSEPOD	<b>AMP</b> AMP Incorporated Harrisburg, PA 17105-3608
DIMENSIONS: MM (INCHES)		CHK MS FEHER	ORSEPOD	
TOLERANCES UNLESS OTHERWISE SPECIFIED:		APVD G PORTA	ORSEPOD	NAME SPLICE, AMPLIVAR
0 PLC $\pm$		PRODUCT SPEC		SIZE CAGE CODE DRAWING NO
1 PLC $\pm$		APPLICATION SPEC		114-2009
2 PLC $\pm$ 0.38 (.015)		WEIGHT		A3100779 $\text{C}$ - 41899
3 PLC $\pm$		CUSTOMER DRAWING		RESTRICTED TO
4 PLC $\pm$				
ANGLES $\pm$				
MATERIAL	082 BRASS	FINISH	0.00254 [.000100] MIN TIN	SCALE 10:1 SHEET 1 OF 1 REV C

AMP 1470-19 REV 11 JUN97

03-JUN-02 14:17:41 amp02644 /home/amp02644/dmtecdm