

THIS DRAWING IS UNPUBLISHED. RELEASED FOR PUBLICATION .19
 © COPYRIGHT 19 BY AMP INCORPORATED. ALL INTERNATIONAL RIGHTS RESERVED.

LOC	DIST	P	F	ZONE	LTR	REVISIONS	DATE	APPRO
6	14			A		REL PER 063A-0221-02	02MAY02	JR/TH

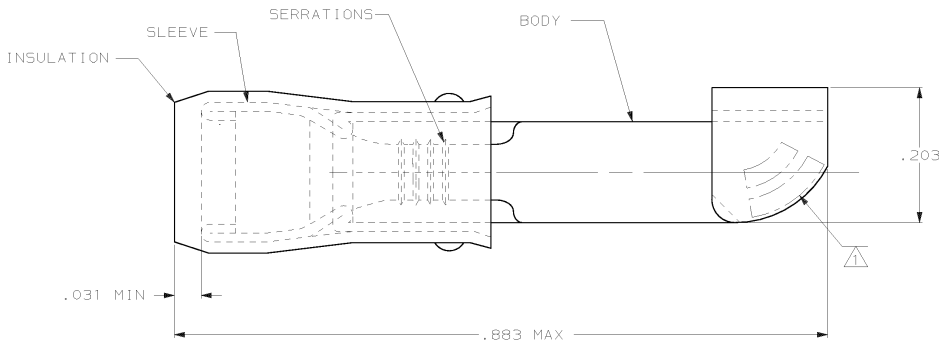

AMP
WIRE RANGE
 22-16 AWG
 SOLID OR STRANDED

- ① MARKED "AMP 22-18*" FOR MILITARY COMMERCIAL RANGE IS 22-16
- ② DESIGNED FOR WIRE INSULATION DIA .080-.125
- ③ TONGUE MATERIAL THK .033 MAX.
- ④ PREPRODUCTION - FA5R REQ

④ 696451-1
 PART NO

AMP INCORPORATED CUSTOMER SERVICE SYSTEMS		MAX RECOMMENDED OPERATING TEMPERATURE: 105°C (221°F)	DO NOT SCALE PRINT. UNLESS SPECIFIED DIMENSIONS IN mm (INCHES) TOLERANCES ON: 2 PLC DEC ± - 3 PLC DEC ± .008 ANGLES ± -	DR 04APRO2 JR RUTH	AMP Incorporated Harrisburg, PA 17105-3608 NAME TERMINAL, PIDG™ KNIFE DISCONNECT, WIRE SIZE: 22-16 AWG		
FOR ADDITIONAL PRODUCT INFORMATION OR COPIES OF DRAWINGS AND TECHNICAL DOCUMENTS	PRODUCT INFORMATION CENTER 1-800-522-6752	VOLTAGE RATING: 300V MAX	MATERIAL COPPER ASTM B-152 SLEEVE, RED NYLON	CHK 04APRO2 T MICHIPELLUTI			
FOR APPLICATION TOOLING INFORMATION	TOOLING ASSISTANCE CENTER 1-800-722-1111	WIRE CROSS SECTIONAL AREA RANGE: 0.26-1.65mm² (509-3,260 CIR MILS) SOLID OR STRANDED	FINISH NICKEL PL PER ASTM B162	APPD 04APRO2 T MICHIPELLUTI	④	00779	④-696451
FOR ORDER ENTRY	1-800-526-5142	THIS DRAWING IS A CONTROLLED DOCUMENT FOR AMP INCORPORATED. IT IS SUBJECT TO CHANGE AND THE CONTROLLING ENGINEERING ORGANIZATION SHOULD BE CONTACTED FOR THE LATEST REVISION.		PRODUCT SPEC -	SCALE	10:1	SHEET 1 OF 1

CUSTOMER DRAWING

AMP 1471-B REV 3-92
 04-APR-02 10:17:10 amp13469 /ws/tesp/u.ir-proposals

31769