

C 880 137

DO NOT SCALE
DIMENSIONS IN

METRIC

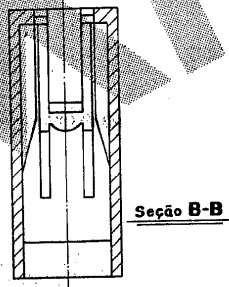
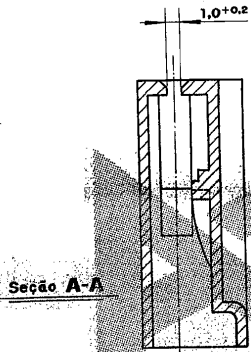
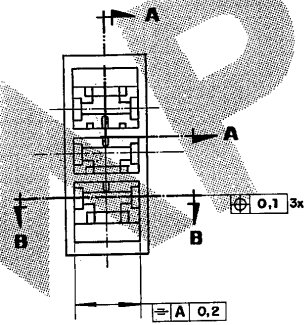
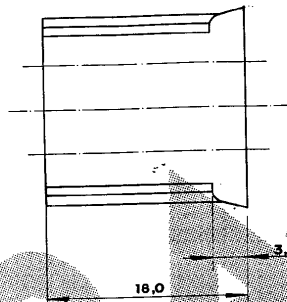
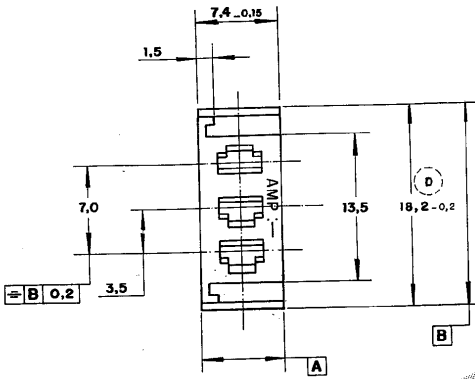

NOTA: 1- NÃO É PERMITIDO O USO DE CADMIO NOS MATERIAIS E/OU NAS CORES P/ACABAMENTO.
 △ OBSOLETE PARTS: OBSOLETE CIS STREAMLINING PER D.RENAUD/D.SINISI

PRETO	NYLON 6-6	880 137 - 2
NATURAL	NYLON 6-6	880 137 - 1
OTHER TREATMENT	FINISH	MATERIAL
CUSTOMER DWG for REFERENCE ONLY		
THIS DRAWING IS UNPUBLISHED. RELEASED FOR PUBLICATION BY AMP DO BRASIL LTDA S.P. ALL INTERNATIONAL RIGHTS RESERVED. AMP PRODUCTS MAY BE COVERED BY U.S. AND FOREIGN PATENTS AND/OR PATENTS PENDING.		
TOLERANCES UNLESS OTHERWISE STATED	INS. DIA. RANGE	WIRE RANGE
DEC. ± 0.8		SCALE
ANGLES ± 1°		
DR. <i>[Signature]</i>	DESCRIPTION	
DATE: 11/25/83	3 WAY .110 FAST-IN-ON REC. HSG.	
D1 REVISED PER ECO-89-026444	KK	AEG 27NOV82
D 18,2 ERA 16,8	DORI	16.8.85
B REVISADO	G.F.M.	T.V. 19.8.85
A ERA P82-29314	G.R.N.	J.N. 3.3.83
REVISION RECORD	DR	CHK DATE APP.
A3 DWG NO C 880 137		SHEET 1 OF 1