

THIS DRAWING IS UNPUBLISHED. RELEASED FOR PUBLICATION 2003
 COPYRIGHT 2003 BY TYCO ELECTRONICS CORPORATION. ALL RIGHTS RESERVED.

LOC	DIST	REVISIONS				
P	LTR	DESCRIPTION	DATE	DWN	APVD	
		AL REDRAWN AND UPDATED, ECR-06-009404	02 MAY 2006	HY	GT	
		AL1 REVISED PER ECO-09-026346	26NOV09	KK	AEG	

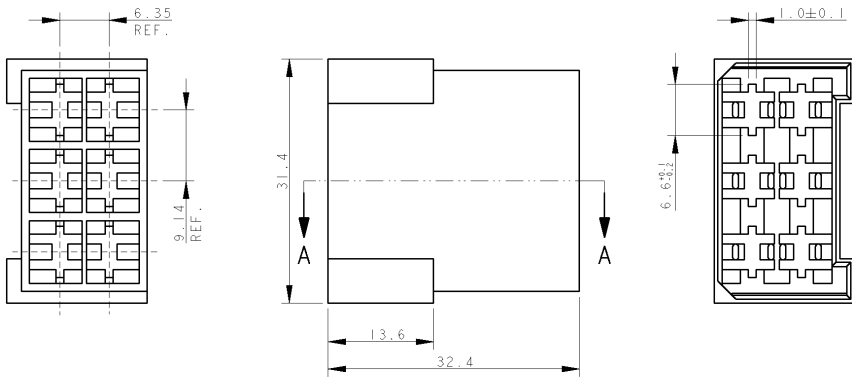

- 1 PA 6.6 UNFILLED, UL 94-V2
- 2 PA 6.6 UNFILLED UL 94 V0 & ACCORDING TO IEC 60335-1 NORM.
- 3 PA 6.6 20% GLASS FIBER FILLED, TECHNYL A 216 V20.
- 4 OBSOLETE PARTS: OBSOLETE CIS STREAMLINING PER D.RENAUD/D.SINISI

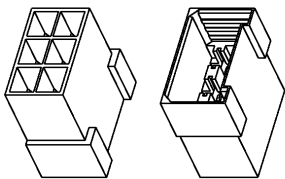
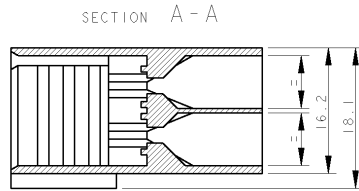

SCALE 1:1

OB	COLOUR	MATERIAL	TYCO P/N	REV
1	NATURAL	1	4-180906-0	AK
2	NATURAL	2	3-180906-0	AK
3	NATURAL	3	2-180906-0	AL
4	ORANGE	4	0-180906-0	AK
5	VIOLET	5	0-180906-0	AK
6	BROWN	6	0-180906-0	AK
7	BLACK	7	0-180906-5	AK
8	YELLOW	8	0-180906-4	AK
9	BLUE	9	0-180906-3	AK
10	GREEN	10	0-180906-2	AK
11	RED	11	0-180906-1	AK
12	NATURAL	12	0-180906-0	AK
NOTE	COLOUR	MATERIAL	TYCO P/N	REV

DIMENSIONS: mm 		TOLERANCES UNLESS OTHERWISE SPECIFIED: 0 PLC ± 1 PLC ±0.3 2 PLC ± 3 PLC ± 4 PLC ± ANGLES ±2°		OWN 18APR2006 CHG H. YAALI H. YAALI APVD G. TURCO PRODUCT SPEC 108-20020 APPLICATION SPEC WEIGHT CUSTOMER DRAWING		tyco Electronics tyco Electronics AMP Italia S.p.A. C.so F.lli Cervi, 15 COLLEGNO (TO)	
MATERIAL SEE TABLE FINISH		SIZE A3 CAGE CODE - DRAWING NO. C-180906		FASTIN-FASTON* Connector, 6.3 mm series TAB HOUSING 6 WAY		RESTRICTED TO SCALE 2:1 SHEET 1 OF 1 REV AL1	

AMP 1470-19 REV 31MAR2000

P10/ENGINEER DRAWING