

4

3

2

1

THIS DRAWING IS UNPUBLISHED. RELEASED FOR PUBLICATION .19  
 © COPYRIGHT 19 BY AMP INCORPORATED. ALL RIGHTS RESERVED.

LOC		DIST		REVISIONS			
P	LTR	DESCRIPTION		DATE	DWN	APVD	
	D	ADDED -2 PER 063A-0018-01		19JAN01	JR	ND	

SUGGESTED MATING TAB

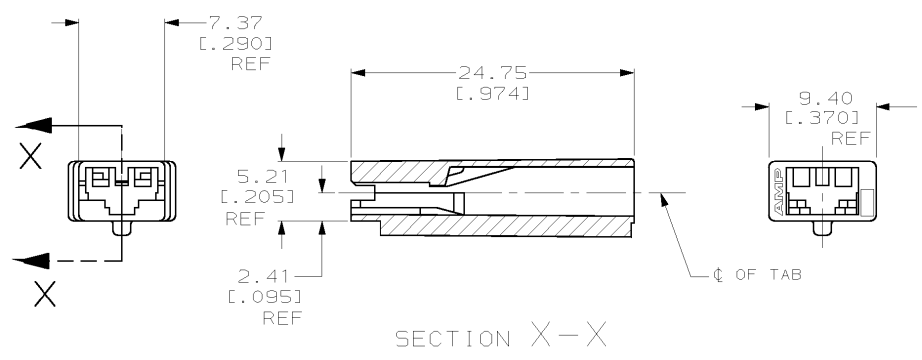
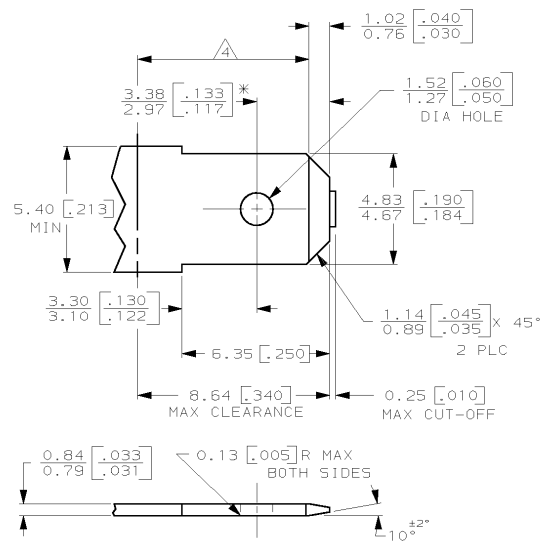

- 1 ACCEPTS CONTACTS FOR 0.81 [0.032] THICK TABS ONLY. EXAMPLE, 63498, 173690.
- ⚠ PRELIMINARY - NOT FOR PRODUCTION

- 1 MATL: #2 HARD BRASS OR NICKEL PLATED STEEL.
- 2 NO BURRS PERMISSIBLE AT HOLE.
- 3 TIN PLATING IS REQUIRED ON BRASS WHEN TERMINAL TEMPERATURE IS OVER 225°F.
- 4 MUST BE FLAT WITHIN 0.076 [0.003] OVER THIS LENGTH.
- 5 HOLE MUST BE SYMMETRICAL ABOUT TAB  $\phi$  WITHIN 0.076 [0.003].
- \* TO BE USED ONLY WHEN SHOULDER IS ELIMINATED.

STANYL TW341	⚠ 521125-2
6/6 NYLON	521125-1
MATERIAL	PART NO.

THIS DRAWING IS A CONTROLLED DOCUMENT.		DWN	11/15/96	<b>AMP</b> AMP Incorporated Harrisburg, PA 17105-3608
		JR RUTH	11/15/96	
		CHK	11/15/96	NAME HOUSING, POSITIVE-LOCK, 4.75 [.187] SERIES, MK II
		MS FEHER	11/15/96	
		APVD	11/15/96	PRODUCT SPEC APPLICATION SPEC
		J GILLESPIE	11/15/96	
DIMENSIONS: MM (INCHES)	TOLERANCES UNLESS OTHERWISE SPECIFIED:	SIZE	CAGE CODE	DRAWING NO
0 PLC ±-	1 PLC ±-	A3	00779	C-521125
2 PLC ±0.25 [.010]	3 PLC ±-	SCALE	3:1	SHEET
4 PLC ±-	ANGLES ±-	CUSTOMER DRAWING		1 OF 1
MATERIAL SEE TABLE	FINISH NATURAL	WEIGHT -		REV D