

THIS DRAWING IS UNPUBLISHED. RELEASED FOR PUBLICATION
 © COPYRIGHT 19 BY AMP INCORPORATED. ALL INTERNATIONAL RIGHTS RESERVED.

LOC	DIST	P	F	ZONE	LTR	REVISIONS	DATE	APPD
AF	50				G	ADDED -3 PER AF-7991	5/18/92	PF/GY

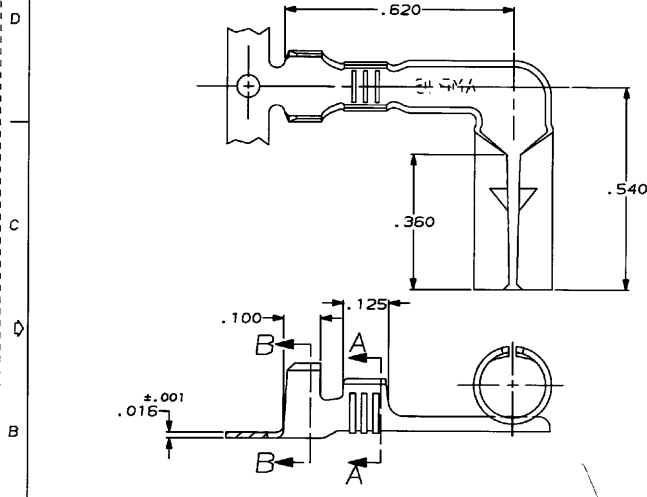

- 1 CONTINUOUS STRIP ON REELS
- 2 REVERSED REELED

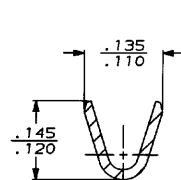

SECTION A-A
SCALE 8:1

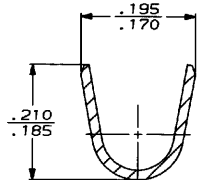

SECTION B-B
SCALE 8:1

F	.155	.190	F	.090	.065	16
					.057	18
					.053	20
TYPE	WIDTH	STRIP LENGTH ±.015	TYPE	WIDTH	±.002 HEIGHT	WIRE
INSUL BARREL CRIMP			WIRE BARREL CRIMP			

INSULATION RANGE	WIRE RANGE	PART NO
.100-.140 DIA	20-16 AWG	42700-3
.100-.140 DIA	20-16 AWG	42700-1

DR S/2/90	P. FORNEY	AMP AMP Incorporated Harrisburg, PA 17105-3608
CHK S/2/90	JR. SMITH	
APPD S/2/90	B. WETTER	
APPD S/2/90	R. KIDD	
MATERIAL	#4 HARD BRASS	NAME
FINISH		SIZE
APPLICATION SPEC		CAGE CODE
WEIGHT		DRAWING NO
		SCALE
		SHEET

AMP 1490-15 REV 11-88
 01 JUN 1992 10:59:14 AMP17795

US128A>DEPT2122>DWG2122>U.PIN-RECP1

CUSTOMER DRAWING