

4

3

2

1

THIS DRAWING IS UNCLASSIFIED
 (C) COPYRIGHT IS BY AMP INCORPORATED. ALL RIGHTS RESERVED.

REV	DATE	DESCRIPTION	DATE	BY	APP'D
CM	52				
D		REV 8 REDWN PER EC 0L30-0125-97	6-5-97	TB	RS

- △ 0.00203 MIN MATTE TIN PLATING OVER ALL.
- 2. WIRE RANGE: 0.12 - 0.6 MM² (26 - 20 AWG)
- 3. INSULATION RANGE: 1.02 - 2.79

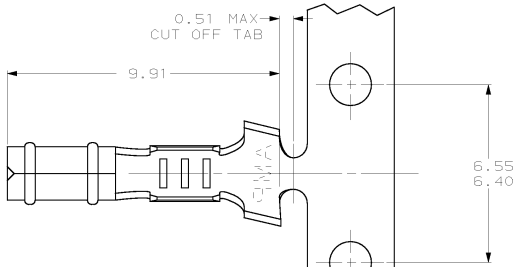

SECTION A-A

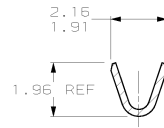
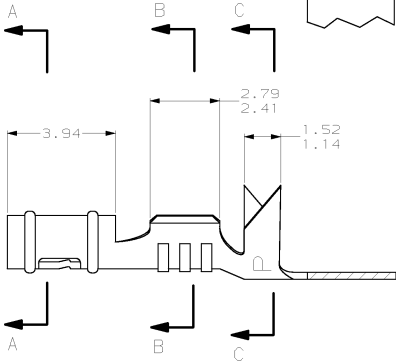

SECTION B-B

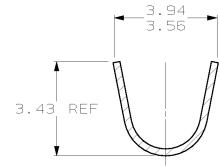

SECTION C-C

350196-1
 PART NUMBER

MM	IN	MM	IN	MM	IN	MM	IN
1.14	.045	1.96	.077	3.94	.155	-	-
1.02	.040	1.91	.075	3.56	.140	-	-
0.51	.020	1.52	.060	3.43	.135	-	-
0.25	.010	1.485	.0585	2.79	.110	9.91	.390
0.13	.005	1.47	.058	2.41	.095	6.55	.258
0.00203	.000080	1.359	.0535	2.16	.085	6.40	.252
MM	IN	MM	IN	MM	IN	MM	IN

CONVERSION TABLE

METRIC

THIS DRAWING IS A CONTROLLED DOCUMENT

DESIGNED BY	T. BECK	6-05-92
CHECKED BY	S. SWING	6-05-92
APPROVED BY	J. BRADY	6-17-92
PRODUCT SPEC	108-1025	
APPLICATION SPEC	114-1008	
REWORK	-	

AMP INCORPORATED
 HARRISBURG, PA 17105-3608

RECEPTACLE, .058 DIAMETER,
 26-20 AWG, .040-.110
 INSULATION, P.C. CONTACT

SCALE: 10:1 SHEET 1 OF 1

350196

A

D

C

B

D

C

B

A