

4 3 2 1

THIS DRAWING IS UNCLASSIFIED  
 (C) Copyright © 1998 BY AMP INCORPORATED. ALL RIGHTS RESERVED.

REV. NO.		REV. DATE		DESCRIPTION		DATE	BY	APP'D
CM	52							
		G		REV PER EC	0618-0242-98	20-JAN-99	JH	RS

1. WIRE RANGE: 0.3 - 0.9 MM<sup>2</sup> (22 - 18 AWG)

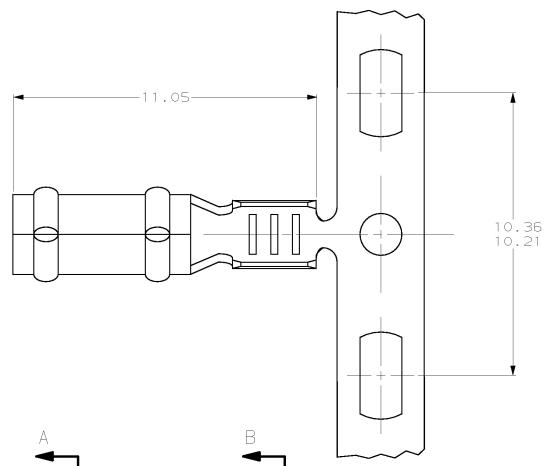

SECTION A-A

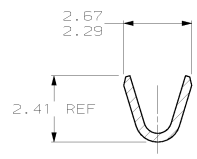
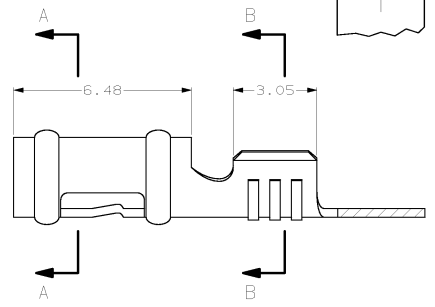

SECTION B-B

MINI	350015-2
STANDARD	350015-1
APPLICATOR	PART NUMBER

MM	IN	MM	IN	MM	IN	MM	IN
2.29	.090	2.67	.105	10.21	.402	-	-
0.32	.013	2.41	.095	6.48	.255	11.05	.435
0.13	.005	2.36	.093	3.05	.120	10.36	.408

CONVERSION TABLE

**METRIC**

THIS DRAWING IS A CONTROLLED DOCUMENT		DATE	8-17-99
BY	T. BECK	DATE	6-17-99
CHK	R. SWING	DATE	9-22-99
APP'D	J. REDDICK	DATE	
SYMBOL	PLC	PLC	PLC
PLC	PLC	PLC	PLC
PLC	PLC	PLC	PLC
PLC	PLC	PLC	PLC
PLC	PLC	PLC	PLC
PLC	PLC	PLC	PLC
POTENTIAL	0.32 PH BRZ	FINISH	PRE TIN
WEIGHT		REMARKS	CUSTOMER DRAWING
SCALE	10:1	SHEET	1 OF 1
REV	6		

**AMP** AMP Incorporated  
Harrisburg, PA 17105-3608

RECEPTACLE, .093 DIAMETER,  
22-18 AWG, P.C. CONTACT

SCALE CODE DRAWING NO. A200779-350015

AMP 1471-9 REV 27/04/06  
 20-JAN-99 10:14:06 amp18726 /home/amp18726/ec242-98