

|      |      |             |          |
|------|------|-------------|----------|
| SIGN | DATE | DESCRIPTION | APPROVER |
|      |      |             |          |

N = Number of poles  
 Dim L=(N-1)×7.0+3.5  
 Dim P=(N-1)×7.0

|       | Dim L | Dim P |
|-------|-------|-------|
| 2-4p  | ±0.15 | ±0.10 |
| 5-9p  | ±0.25 | ±0.25 |
| 9-12p | ±0.40 | ±0.30 |

**Material**

- Terminal body(metal housing): Brass(CuZn),Tin plated
- Terminal screw: Steel Zinc plating "-" slot type
- Wire guard :stainless steel
- Insulator (housing): PA66 (UL94V-0)

Electrical UL / CSA

- Voltage rating: 125V/125V
- Current rating: 10A/10A
- Wire range:
  - Solid wire(AWG): 16-26 / 16-26
  - Stranded wire(AWG): 16-26 / 16-26
- Torque: 1.7Lb-In/4kgf.cm
- Screw: M2
- Wire strip length: 5-6mm
- Withstanding Voltage: 1.25KV/1.25KV
- Operating temperature: -40°C to +115°C
- Soldering temperature: 260°C±5°C/5 Sec
- Safety Approval: 

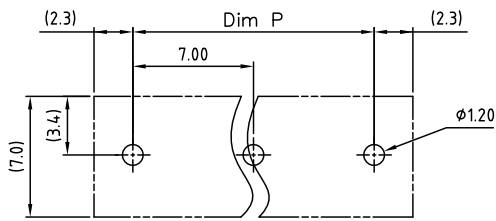
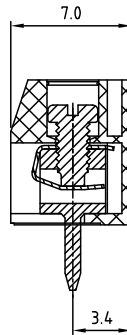
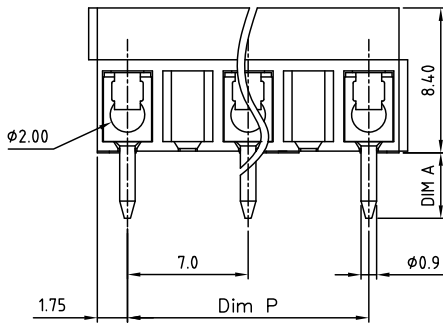
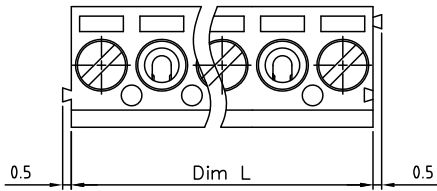

P.C.B. LAYOUT

**OST** ON-SHORE TECHNOLOGY, INC.

|          |         |  |                     |              |  |                 |
|----------|---------|--|---------------------|--------------|--|-----------------|
| TITLE    |         | OSTTE 7.0mm series "-" screw (Solid Block) |                     |              |  |                 |
| PART NO. |         | OSTTEXX11X4                                |                     | DWG NO.      |  | OSTTEXX11X4.DWG |
| APPROVED | CHECKED | DESIGNED                                   | DRAWN               | CUST NO.     |  | Tolerance       |
|          |         | Tason<br>2010.07.09                        | Tason<br>2010.07.09 |              |  | X. ±0.50        |
|          |         |  |                     | UNIT: mm     |  | X.X ±0.30       |
|          |         |  |                     | SCALE: NONE  |  | X.XX ±0.10      |
|          |         |  |                     | SHEET: 01/01 |  | X* ±1°          |
|          |         |  |                     | REV.: B      |  |                 |