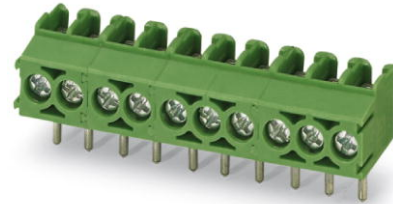

## PT 1,5/ 6-3,5-V

Order No.: 1984808

The figure shows a 10-position version of the product

<http://eshop.phoenixcontact.de/phoenix/treeViewClick.do?UID=1984808>

PC terminal block, Nominal current: 17.5 A, Nom. voltage: 160 V,  
Pitch: 3.5 mm, Number of positions: 6, Type of connection: Screw  
connection, Assembly: Soldering, Conductor/PCB connection  
direction: 90 °, Color: green

### Commercial data

|                          |                    |
|--------------------------|--------------------|
| EAN                      | 4017918946357      |
| Pack                     | 100 pcs.           |
| Customs tariff           | 85369010           |
| Weight/Piece             | 0.002968 KG        |
| Catalog page information | Page 467 (CC-2009) |

### Product notes

WEEE/RoHS-compliant since:  
01/01/2003



<http://www.download.phoenixcontact.com>  
Please note that the data given here has been taken from the online catalog. For comprehensive information and data, please refer to the user documentation. The General Terms and Conditions of Use apply to Internet downloads.

### Technical data

#### Dimensions / positions

|        |        |
|--------|--------|
| Length | 9 mm   |
| Height | 7.6 mm |
| Pitch  | 3.5 mm |

|                        |         |
|------------------------|---------|
| Dimension a            | 17.5 mm |
| Number of positions    | 6       |
| Pin dimensions         | 0,9 mm  |
| Pin spacing            | 3.5 mm  |
| Hole diameter          | 1.2 mm  |
| Screw thread           | M2      |
| Tightening torque, min | 0.22 Nm |
| Tightening torque max  | 0.25 Nm |

**Technical data**

|                                    |                     |
|------------------------------------|---------------------|
| Insulating material group          | I                   |
| Rated surge voltage (III/3)        | 2.5 kV              |
| Rated surge voltage (III/2)        | 2.5 kV              |
| Rated surge voltage (II/2)         | 2.5 kV              |
| Rated voltage (III/2)              | 200 V               |
| Rated voltage (II/2)               | 400 V               |
| Connection in acc. with standard   | EN-VDE              |
| Nominal current $I_N$              | 17.5 A              |
| Nominal voltage $U_N$              | 160 V               |
| Nominal cross section              | 1.5 mm <sup>2</sup> |
| Maximum load current               | 17.5 A              |
| Insulating material                | PA                  |
| Inflammability class acc. to UL 94 | V0                  |
| Stripping length                   | 5 mm                |

**Connection data**

|   |                      |
|---|----------------------|
| Conductor cross section solid min.                                      | 0.14 mm <sup>2</sup> |
| Conductor cross section solid max.                                      | 1.5 mm <sup>2</sup>  |
| Conductor cross section stranded min.                                   | 0.2 mm <sup>2</sup>  |
| Conductor cross section stranded max.                                   | 1.5 mm <sup>2</sup>  |
| Conductor cross section stranded, with ferrule with plastic sleeve min. | 0.25 mm <sup>2</sup> |
| Conductor cross section stranded, with ferrule with plastic sleeve max. | 0.75 mm <sup>2</sup> |
| Conductor cross section AWG/kcmil min.                                  | 26                   |
| Conductor cross section AWG/kcmil max                                   | 16                   |
| 2 conductors with same cross section, solid min.                        | 0.2 mm <sup>2</sup>  |

|   |                      |
|---|----------------------|
| 2 conductors with same cross section, solid max.    | 0.34 mm <sup>2</sup> |
| 2 conductors with same cross section, stranded min. | 0.2 mm <sup>2</sup>  |
| 2 conductors with same cross section, stranded max. | 0.5 mm <sup>2</sup>  |

### Certificates / Approvals



Certification CCA, CUL, SEV, UL

#### CUL

|                                |       |
|--------------------------------|-------|
| Nominal voltage U <sub>N</sub> | 300 V |
| Nominal current I <sub>N</sub> | 10 A  |
| AWG/kcmil                      | 26-16 |

#### UL

|                                |       |
|--------------------------------|-------|
| Nominal voltage U <sub>N</sub> | 300 V |
| Nominal current I <sub>N</sub> | 10 A  |
| AWG/kcmil                      | 26-16 |

### Accessories

| Item           | Designation             | Description   |
|----------------|-------------------------|---|
| <b>Marking</b> |                         |   |
| 1051993        | B-STIFT                 | Marker pen, for manual labeling of unprinted Zack strips, smear-proof and waterproof, line thickness 0.5 mm   |
| 0804073        | SK 3,5/2,8:FORTL.ZAHLEN | Marker card, printed horizontally, self-adhesive, 10-section marker strip, 14 identical decades marked 1-10, 11-20 etc. up to 91-100, sufficient for 140 terminal blocks                  |
| 0803883        | SK U/2,8 WH:UNBEDRUCKT  | Unprinted marker cards, DIN A4 format, pitch as desired, self-adhesive, with 50 stamped marker strips, 185 mm strip length, can be labeled with the CMS system or manually with the M-PEN |
| 0811228        | X-PEN 0,35              | Marker pen without ink cartridge, for manual labeling of markers, labeling extremely wipe-proof, line thickness 0.35 mm   |
| <b>Tools</b>   |                         |   |
| 1205037        | SZS 0,4X2,5             | Screwdriver, bladed, matches all screw terminal blocks up to 1.5 mm <sup>2</sup> connection cross section, blade: 0.4 x 2.5 mm  |

## Diagrams/Drawings

Drilling plan/solder pad geometry

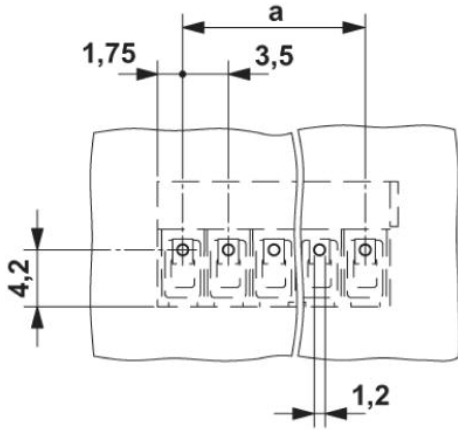

Diagram

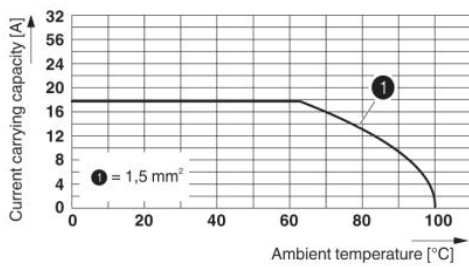

Derating diagram for 5 pins; reduction factor=1

Dimensioned drawing

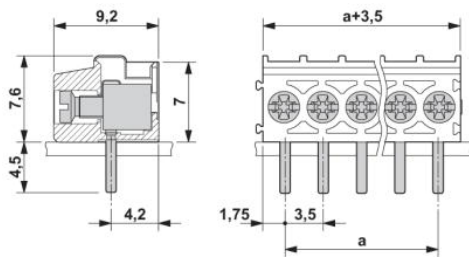

**Address**

PHOENIX CONTACT Inc., USA  
586 Fulling Mill Road  
Middletown, PA 17057, USA  
Phone (800) 888-7388  
Fax (717) 944-1625  
<http://www.phoenixcon.com>



© 2010 Phoenix Contact  
Technical modifications reserved;