

N=Number of poles

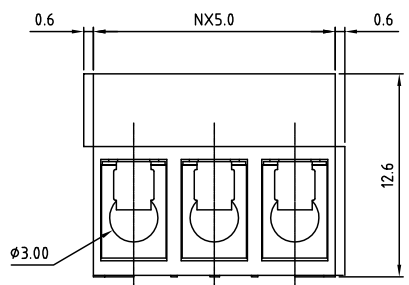

P.C.B. LAYOUT

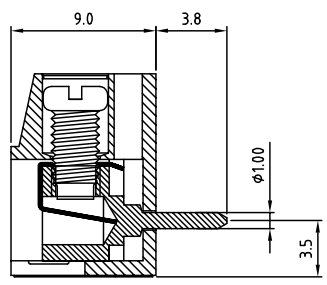
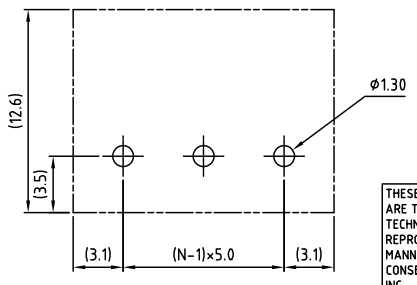

| SIGN | DATE | DESCRIPTION | APPROVER |
|--|------|-------------|----------|
| THIS IS CAD DRAWING, DO NOT REVISE MANUALLY!!! | | | |

- Material**
- Terminal body (metal housing): Brass(CuZn)
 - Terminal screw: Steel Zinc plating "-" slot type
 - Wire guard: Stainless steel
 - Surface of solder tail: Tin plated
 - Insulator (housing): Thermoplastic (UL94V-0)
- Electrical UL/CSA**
- Voltage rating: 250VAC/250VAC
 - Current rating: 16A/16A
 - Wire range:
 - Solid wire(AWG): 14/14-22
 - Stranded wire(AWG): 14-22
 - Torque: 2.6Lb-In/4Kgf.cm
 - Screw: M3
 - Wire strip length: 6-7mm
 - Withstanding Voltage: 15KV/15KV
 - Operating temperature: -30°C to +105°C
 - Soldering temperature: 250°C±10°C/5 Sec
 - Safety Approval:

RoHS Compliant

PART NUMBER:
OSTTBXX0161

No. of Poles
 02 2 Poles
 03 3 Poles
 ...
 24 24 Poles

COLOR
 0: Black
 5: Green
 6: Blue (Standard)
 8: Grey



THESE DRAWINGS AND SPECIFICATIONS ARE THE PROPERTY OF ON-SHORE TECHNOLOGY, INC. AND SHALL NOT BE REPRODUCED, COPIED OR USED IN ANY MANNER WITHOUT THE PRIOR WRITTEN CONSENT OF ON-SHORE TECHNOLOGY, INC.

| TITLE | | OSTTB 5.0 series 2-Interlock | | |
|-----------------------|----------------------|------------------------------|----------------------|-----|
| PART NO. | OSTTBXX0161 | DWG NO. | OSTTBXX0161.DWG | |
| APPROVED | CHECKED | DESIGNED | DRAWN | |
| Shi Jun 2006.10.19 | Marvin 2006.10.19 | Marvin 2006.10.19 | Marvin 2006.10.19 | |
| CUST NO. | | Tolerance | | |
| | | UNIT: mm | | |
| | | SCALE: NONE | | |
| | | X.X | ±0.50 | |
| | | X.XX | ±0.10 | |
| SHEET: 01/01 | | REV: D | | |
| | | X* | | ±1* |