

SIGN	DATE	DESCRIPTION	APPROVER
		<i>THIS IS CAD DRAWING, DO NOT REVISE MANUALLY!!!</i>	

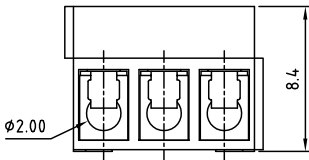

N=Number of contacts

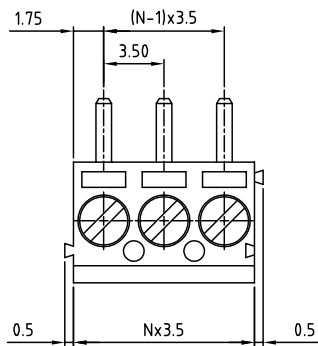
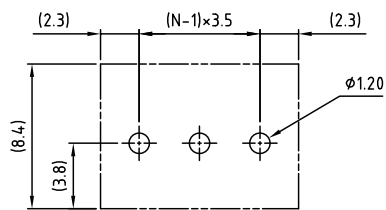
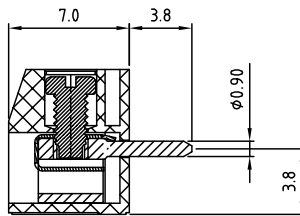

P.C.B. LAYOUT

THESE DRAWINGS AND SPECIFICATIONS ARE THE PROPERTY OF ON-SHORE TECHNOLOGY, INC. AND SHALL NOT BE REPRODUCED, COPIED OR USED IN ANY MANNER WITHOUT THE PRIOR WRITTEN CONSENT OF ON-SHORE TECHNOLOGY, INC.

Material

- Terminal body(metal housing): Brass(CuZn), Tin plated
- Terminal screw: Steel Zinc plating "-" slot type
- Wire guard :stainless steel
- Insulator (housing): Thermoplastic (UL94V-0)

Electrical UL / CSA

- Voltage rating: 125V/125V
- Current rating: 10A/10A
- Wire range:
 - Solid wire(AWG): 16-26 / 16-26
 - Stranded wire(AWG): 16-26 / 16-26
- Torque: 1.7lb-in/4kgf.cm
- Screw: M2
- Wire strip length: 5-6mm
- Withstanding Voltage: 1.25KV/1.25KV
- Operating temperature: -30°C to +105°C
- Soldering temperature: 250°C±10°C/5 Sec
- Safety Approval:

RoHS Compliant

PART NUMBER:

OSTTFXX0161

- No. of Poles
- 02: 2 Poles
 - 03: 3 Poles
 - ...
 - 24: 24 Poles

- COLOR
- 0: Black
 - 5: Green
 - 6: Blue (Standard)
 - 8: Grey



TITLE	OSTTF 3.5 series						
PART NO.	OSTTFXX0161			DWG NO.	OSTTFXX0161.DWG		
APPROVED	CHECKED	DESIGNED	DRAWN	CUST NO.	Tolerance		
	Marvin 2007.02.02	Marvin 2007.02.02	Marvin 2007.02.02		UNIT: mm		X. ±0.50
					SCALE: NONE		X.X ±0.30
					SHEET: 01/01		X.XX ±0.10
					REV.: B		X* ±1*