

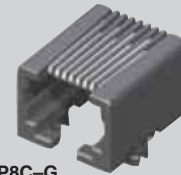

MODS-A-6P4C-G



MODS-A-6P6C-G-S



MODS-C-8P8C-G

MODS-C-6P4C-E-S



MODS-A, MODS-C SERIES

# SINGLE RIGHT ANGLE MODULAR JACKS

## SPECIFICATIONS

For complete specifications and recommended PCB layouts see [www.samtec.com?MODS-A](http://www.samtec.com?MODS-A) or [www.samtec.com?MODS-C](http://www.samtec.com?MODS-C)

**Insulator Material:**

PBT Glass Filled

**Contact Material:**

Phosphor Bronze

**Shield Material:**

Copper Alloy

**Plating:**

Gold on Contacts, Nickel on Shield

**Operating Temp Range:**

-25°C to +90°C

**Current Rating:**

1.5 A per contact

**Voltage Rating:** 120 VAC

**Contact Resistance:**

20 mΩ max

**Minimum Cycles:**

500

**System Application:**

CAT3

**Packaging:**

Packaged and shipped in Bulk Packaging Trays; Trays suitable for automation are available upon request.

**RoHS Compliant:**

Yes

**Lead-Free Solderable:**

Yes (Wave Solder only)



## MODS - A -

## POSITIONS CONTACTS

- 6P4C = 6 Positions 4 Contacts
- 6P6C = 6 Positions 6 Contacts
- 8P8C = 8 Positions 8 Contacts

| POSITIONS CONTACTS | A            | B            | C            |
|--------------------|--------------|--------------|--------------|
| -6PXC              | (13,21) .520 | (20,54) .809 | (12,70) .500 |
| -8P8C              | (15,24) .600 |              |              |
| -6PXC (-S)         | (13,94) .549 | (21,20) .835 | (13,60) .535 |
| -8P8C (-S)         | (15,98) .629 |              |              |

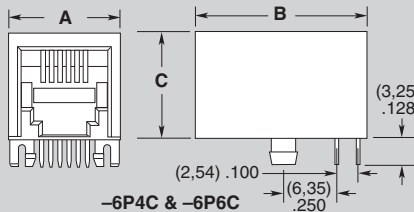

-6P4C & -6P6C

## PLATING

- G = 15µ" (0,38 µm)  
Gold on Mating Area,  
Gold Flash on Tails
- E = 50µ" (1,27µm)  
Gold on Mating Area,  
Gold Flash on Tails

## SHIELD OPTION

- (Leave Blank for Unshielded)
- S = Shielded (No Panel Grounds)
- S4 = Shielded with Top, Bottom and Side Panel Grounds

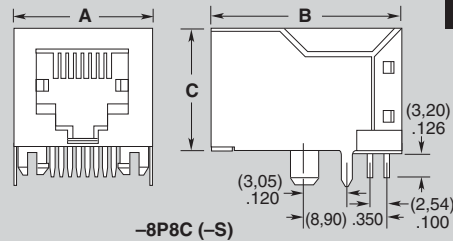

-8P8C (-S)

## APPLICATION SPECIFIC OPTION

Other plating options available. Call Samtec.

## MODS - C -

## POSITIONS CONTACTS

- 6P4C = 6 Positions 4 Contacts
- 6P6C = 6 Positions 6 Contacts
- 8P8C = 8 Positions 8 Contacts

## PLATING

- G = 15µ" (0,38 µm)  
Gold on Mating Area,  
Gold Flash on Tails
- E = 50µ" (1,27µm)  
Gold on Mating Area,  
Gold Flash on Tails

## SHIELD OPTION

- (Leave Blank for Unshielded)
- S = Shielded (No Panel Grounds)
- S1 = Shielded with Top and Bottom Panel Grounds

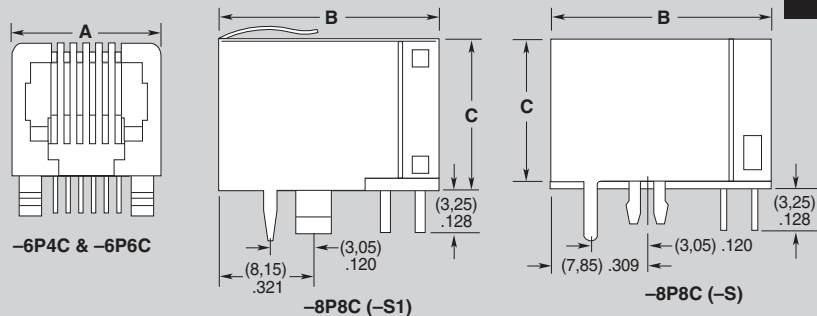

-8P8C (-S1)

-8P8C (-S)

| POSITIONS CONTACTS | A            | B            | C            |
|--------------------|--------------|--------------|--------------|
| -6PXC              | (13,21) .520 | (18,00) .709 | (11,70) .461 |
| -8P8C              | (15,20) .598 |              |              |
| -6PXC (-S)         | (14,00) .551 | (18,80) .740 | (12,20) .480 |
| -8P8C (-S)         | (15,90) .626 |              |              |

-6P4C & -6P6C

Due to technical progress, all designs, specifications and components are subject to change without notice.

[WWW.SAMTEC.COM](http://WWW.SAMTEC.COM)