

REV. NO.		DESCRIPTION	DATE	BY
AD	00			
E1		E20-06-002357	24JUL06	BSV MK

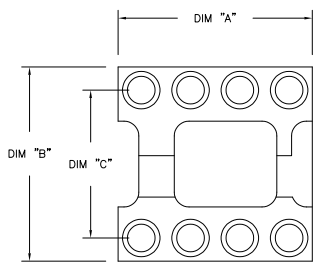

FIG. 1

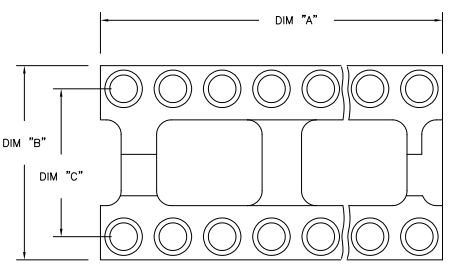

FIG. 2

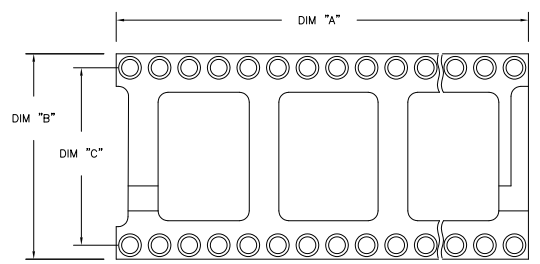
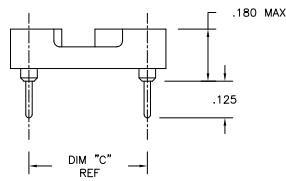
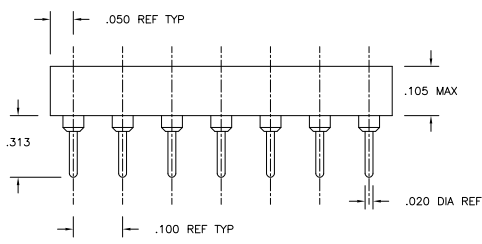
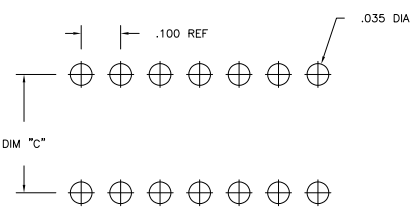

FIG. 3



- INSULATOR MATERIAL - THERMOPLASTIC POLYESTER, PCT, BLACK, UL94 V-0
 - STAMPED CONTACT - BECU, PLATED WITH 80-200.1" TIN (LEAD FREE) OVER 75-100.1" COPPER.
 - SLEEVE - COPPER, PLATED WITH 180-340.1" THK TIN (LEAD FREE) OVER 75-125μ" MIN NICKEL.
 - STAMPED CONTACT-BECU, PLATED WITH GOLD FLASH OVER 50-100.1" NICKEL
 - STAMPED CONTACT-BECU, PLATED WITH 20μ" MIN GOLD OVER 30-100.1" NICKEL.
- ELECTRICAL:**
 CONTACT RESISTANCE: 10 MILLIOHMS MAX
 CONTACT RATING: 3 AMPS
 CAPACITANCE: 1.0 pF PER MIL-STD-202, METHOD 305
 INSULATION RESISTANCE: 5000 OHMS MIN @ 500 VDC PER MIL-STD-1344, METHOD 3003.1
 DIELECTRIC WITHSTANDING VOLTAGE: 1000 VOLTS (RMS) PER MIL-STD-1344, METHOD 3001.1
- MECHANICAL:**
 INSERTION FORCE: 179 GRAMS AVG
 WITHDRAWAL FORCE: 63 GRAMS AVG
 *ACCEPTS IC PIN - .009"X.015" THROUGH .011"X.020", OR .016" TO .021" DIAMETER, .150/.105 LONG"
- ENVIRONMENTAL:**
 OPERATING TEMPERATURE: -55°C TO +105°C



P.C.B. HOLE LAYOUT
 TOLERANCE ±.003

THIS DRAWING IS A CONTROLLED DOCUMENT.		REV. NO.	00	STATUS	NEW	DATE	
DRAWN BY		DESIGNED BY	CHKD BY	APP'D BY	TYS ELECTRONICS CORPORATION Harrisburg, Pa 17105-3608		
CHECKED BY		DATE		OPEN FRAME DIP ECONOMY (STAMPED CONTACT) (REF AUGAT 800 SERIES)			
DATE		DATE	DATE	DATE	DATE	DATE	DATE
SEE NOTES		SEE NOTES	SEE NOTES	SEE NOTES	SEE NOTES	SEE NOTES	SEE NOTES
CUSTOMER DRAWING		DATE	4-1	REV	1	OF	2

8 7 6 5 4 3 2 1

THIS DRAWING IS UNPUBLISHED. ALL RIGHTS RESERVED.
 IN THE ELECTRONICS CORPORATION. ALL RIGHTS RESERVED.

REV	DATE	DESCRIPTION	BY	CHK	APP
AD	00	SEE SHEET 1	-	-	-

FINISH CONTACT/SLEEVE	"C" MAX	"B" MAX	"A" MAX	FIG	NO. OF POSN	PART NO.
△△ GOLD TIN	.400±.005	.500	1.200	2	24	5-1571552-7
△△ GOLD TIN	.300±.005	.400	1.200	2	24	5-1571552-6
△△ GOLD TIN	.900±.005	1.000	3.200	3	64	5-1571552-5
△△ GOLD TIN	.600±.005	.700	2.400	3	48	5-1571552-4
△△ GOLD TIN	.600±.005	.700	2.100	3	42	5-1571552-3
△△ GOLD TIN	.600±.005	.700	2.000	3	40	5-1571552-2
△△ GOLD TIN	.600±.005	.700	1.800	3	36	5-1571552-1
△△ GOLD TIN	.600±.005	.700	1.600	3	32	5-1571552-0
△△ GOLD TIN	.600±.005	.700	1.400	2	28	4-1571552-9
△△ GOLD TIN	.600±.005	.700	1.200	2	24	4-1571552-8
△△ GOLD TIN	.400±.005	.500	1.100	2	22	4-1571552-7
△△ GOLD TIN	.300±.005	.400	1.000	2	20	4-1571552-6
△△ GOLD TIN	.300±.005	.400	.900	2	18	4-1571552-5
△△ GOLD TIN	.300±.005	.400	.800	2	16	4-1571552-4
△△ GOLD TIN	.300±.005	.400	.700	2	14	4-1571552-3
△△ GOLD TIN	.300±.005	.400	.600	2	12	4-1571552-2
△△ G F TIN	.400±.005	.500	1.200	2	24	3-1571552-7
△△ G F TIN	.300±.005	.400	1.200	2	24	3-1571552-6
△△ G F TIN	.900±.005	1.000	3.200	3	64	3-1571552-5
△△ G F TIN	.600±.005	.700	2.400	3	48	3-1571552-4
△△ G F TIN	.600±.005	.700	2.100	3	42	3-1571552-3
△△ G F TIN	.600±.005	.700	2.000	3	40	3-1571552-2
△△ G F TIN	.600±.005	.700	1.800	3	36	3-1571552-1
△△ G F TIN	.600±.005	.700	1.600	3	32	3-1571552-0
△△ G F TIN	.600±.005	.700	1.400	2	28	2-1571552-9
△△ G F TIN	.600±.005	.700	1.200	2	24	2-1571552-8
△△ G F TIN	.400±.005	.500	1.100	2	22	2-1571552-7
△△ G F TIN	.300±.005	.400	1.000	2	20	2-1571552-6
△△ G F TIN	.300±.005	.400	.900	2	18	2-1571552-5
△△ G F TIN	.300±.005	.400	.800	2	16	2-1571552-4
△△ G F TIN	.300±.005	.400	.700	2	14	2-1571552-3
△△ G F TIN	.300±.005	.400	.600	2	12	2-1571552-2
△△ TIN TIN	.400±.005	.500	1.200	2	24	1-1571552-7
△△ TIN TIN	.300±.005	.400	1.200	2	24	1-1571552-6
△△ TIN TIN	.900±.005	1.000	3.200	3	64	1-1571552-5
△△ TIN TIN	.600±.005	.700	2.400	3	48	1-1571552-4
△△ TIN TIN	.600±.005	.700	2.100	3	42	1-1571552-3
△△ TIN TIN	.600±.005	.700	2.000	3	40	1-1571552-2
△△ TIN TIN	.600±.005	.700	1.800	3	36	1-1571552-1
△△ TIN TIN	.600±.005	.700	1.600	3	32	1-1571552-0
△△ TIN TIN	.600±.005	.700	1.400	2	28	1571552-9
△△ TIN TIN	.600±.005	.700	1.200	2	24	1571552-8
△△ TIN TIN	.400±.005	.500	1.100	2	22	1571552-7
△△ TIN TIN	.300±.005	.400	1.000	2	20	1571552-6
△△ TIN TIN	.300±.005	.400	.900	2	18	1571552-5
△△ TIN TIN	.300±.005	.400	.800	2	16	1571552-4
△△ TIN TIN	.300±.005	.400	.700	2	14	1571552-3
△△ TIN TIN	.300±.005	.400	.600	2	12	1571552-2

THIS DRAWING IS A CONTROLLED DOCUMENT. **STAMPA** **YAESU** **YAESU** Two Electronics Corporation Harrisburg, Pa 17105-3608

MECHANICAL DIMENSIONS: **OPEN FRAME DIP ECONOMY (STAMPED CONTACT) (REF AUGAT 800 SERIES)**

DATE: 00779 Q=1571552

CUSTOMER DRAWING