

FIG. 1

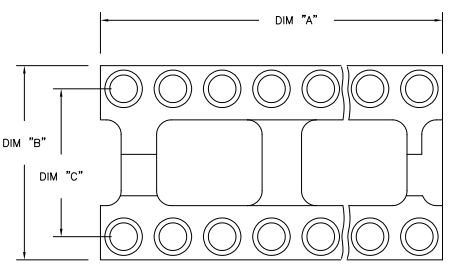

FIG. 2

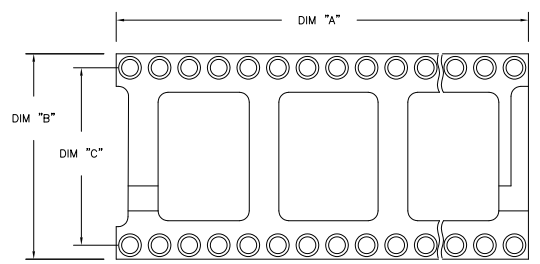
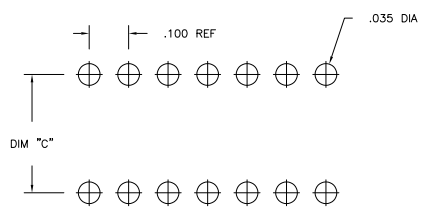
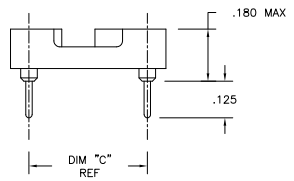
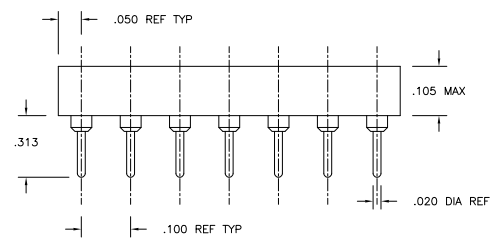

FIG. 3



P.C.B. HOLE LAYOUT
 TOLERANCE ±.003

- INSULATOR MATERIAL - THERMOPLASTIC POLYESTER, PCT, BLACK, UL94 V-0
- STAMPED CONTACT - BECU, PLATED WITH 80-200.1" TIN (LEAD FREE) OVER 75-100.1" COPPER.
- SLEEVE - COPPER, PLATED WITH 180-340.1" THK TIN (LEAD FREE) OVER 75-125μ" MIN NICKEL.
- STAMPED CONTACT-BECU, PLATED WITH GOLD FLASH OVER 50-100.1" NICKEL
- STAMPED CONTACT-BECU, PLATED WITH 20μ" MIN GOLD OVER 30-100.1" NICKEL.
- ELECTRICAL:
 - CONTACT RESISTANCE: 10 MILLIOHMS MAX
 - CONTACT RATING: 3 AMPS
 - CAPACITANCE: 1.0 pF PER MIL-STD-202, METHOD 305
 - INSULATION RESISTANCE: 5000 OHMS MIN @ 500 VDC PER MIL-STD-1344, METHOD 3003.1
 - DIELECTRIC WITHSTANDING VOLTAGE: 1000 VOLTS (RMS) PER MIL-STD-1344, METHOD 3001.1
- MECHANICAL:
 - INSERTION FORCE: 179 GRAMS AVG
 - WITHDRAWAL FORCE: 63 GRAMS AVG
 - "ACCEPTS IC PIN - .009"X.015" THROUGH .011"X.020", OR .016" TO .021" DIAMETER, .150/.105 LONG"
- ENVIRONMENTAL:
 - OPERATING TEMPERATURE: -55°C TO +105°C

THIS DRAWING IS A CONTROLLED DOCUMENT.		REV	DATE	BY	APP'D	Tys Electronics Corporation Harrisburg, Pa 17105-3608	
DESIGNER	DRAWN	DATE	BY	APP'D	REV	DATE	BY
CHECKED	APPROVED						
SEE NOTES	SEE NOTES						
CUSTOMER DRAWING		SIZE	DATE	DATE	ISSUE NO	REVISED TO	
		A1	00779	G=1571552			
		SHEET	4-1	OF	2	REV	E1

8 7 6 5 4 3 2 1

THIS DRAWING IS UNPUBLISHED. ALL RIGHTS RESERVED.
 IN THE ELECTRONICS CORPORATION. ALL RIGHTS RESERVED.

REV	DATE	DESCRIPTION	BY	CHK	APP
AD	00	SEE SHEET 1	-	-	-

FINISH CONTACT/SLEEVE	"C" MAX	"B" MAX	"A" MAX	FIG	NO. OF POSN	PART NO.
△△ GOLD TIN	.400±.005	.500	1.200	2	24	5-1571552-7
△△ GOLD TIN	.300±.005	.400	1.200	2	24	5-1571552-6
△△ GOLD TIN	.900±.005	1.000	3.200	3	64	5-1571552-5
△△ GOLD TIN	.600±.005	.700	2.400	3	48	5-1571552-4
△△ GOLD TIN	.600±.005	.700	2.100	3	42	5-1571552-3
△△ GOLD TIN	.600±.005	.700	2.000	3	40	5-1571552-2
△△ GOLD TIN	.600±.005	.700	1.800	3	36	5-1571552-1
△△ GOLD TIN	.600±.005	.700	1.600	3	32	5-1571552-0
△△ GOLD TIN	.600±.005	.700	1.400	2	28	4-1571552-9
△△ GOLD TIN	.600±.005	.700	1.200	2	24	4-1571552-8
△△ GOLD TIN	.400±.005	.500	1.100	2	22	4-1571552-7
△△ GOLD TIN	.300±.005	.400	1.000	2	20	4-1571552-6
△△ GOLD TIN	.300±.005	.400	.900	2	18	4-1571552-5
△△ GOLD TIN	.300±.005	.400	.800	2	16	4-1571552-4
△△ GOLD TIN	.300±.005	.400	.700	2	14	4-1571552-3
△△ GOLD TIN	.300±.005	.400	.600	2	12	4-1571552-2
△△ G F TIN	.400±.005	.500	1.200	2	24	3-1571552-7
△△ G F TIN	.300±.005	.400	1.200	2	24	3-1571552-6
△△ G F TIN	.900±.005	1.000	3.200	3	64	3-1571552-5
△△ G F TIN	.600±.005	.700	2.400	3	48	3-1571552-4
△△ G F TIN	.600±.005	.700	2.100	3	42	3-1571552-3
△△ G F TIN	.600±.005	.700	2.000	3	40	3-1571552-2
△△ G F TIN	.600±.005	.700	1.800	3	36	3-1571552-1
△△ G F TIN	.600±.005	.700	1.600	3	32	3-1571552-0
△△ G F TIN	.600±.005	.700	1.400	2	28	2-1571552-9
△△ G F TIN	.600±.005	.700	1.200	2	24	2-1571552-8
△△ G F TIN	.400±.005	.500	1.100	2	22	2-1571552-7
△△ G F TIN	.300±.005	.400	1.000	2	20	2-1571552-6
△△ G F TIN	.300±.005	.400	.900	2	18	2-1571552-5
△△ G F TIN	.300±.005	.400	.800	2	16	2-1571552-4
△△ G F TIN	.300±.005	.400	.700	2	14	2-1571552-3
△△ G F TIN	.300±.005	.400	.600	2	12	2-1571552-2
△△ TIN TIN	.400±.005	.500	1.200	2	24	1-1571552-7
△△ TIN TIN	.300±.005	.400	1.200	2	24	1-1571552-6
△△ TIN TIN	.900±.005	1.000	3.200	3	64	1-1571552-5
△△ TIN TIN	.600±.005	.700	2.400	3	48	1-1571552-4
△△ TIN TIN	.600±.005	.700	2.100	3	42	1-1571552-3
△△ TIN TIN	.600±.005	.700	2.000	3	40	1-1571552-2
△△ TIN TIN	.600±.005	.700	1.800	3	36	1-1571552-1
△△ TIN TIN	.600±.005	.700	1.600	3	32	1-1571552-0
△△ TIN TIN	.600±.005	.700	1.400	2	28	1571552-9
△△ TIN TIN	.600±.005	.700	1.200	2	24	1571552-8
△△ TIN TIN	.400±.005	.500	1.100	2	22	1571552-7
△△ TIN TIN	.300±.005	.400	1.000	2	20	1571552-6
△△ TIN TIN	.300±.005	.400	.900	2	18	1571552-5
△△ TIN TIN	.300±.005	.400	.800	2	16	1571552-4
△△ TIN TIN	.300±.005	.400	.700	2	14	1571552-3
△△ TIN TIN	.300±.005	.400	.600	2	12	1571552-2

THIS DRAWING IS A CONTROLLED DOCUMENT. **STAMPA** **YAESU** **YAESU** Two Electronics Corporation Harrisburg, Pa 17102-3608

MECHANICAL DIMENSIONS: **OPEN FRAME DIP ECONOMY (STAMPED CONTACT) (REF AUGAT 800 SERIES)**

DATE: 00779 **Q=1571552** SHEET 2 OF 2