

THIS DRAWING IS UNPUBLISHED. RELEASED FOR PUBLICATION.
 © COPYRIGHT BY TYCO ELECTRONICS CORPORATION. ALL RIGHTS RESERVED.

LOC	DIST	REVISIONS		DATE	BY	APP'D
AD	O	F	LR			
		M		ECO-07-017363	DBAUG2007	RB MM

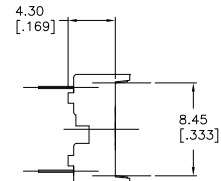
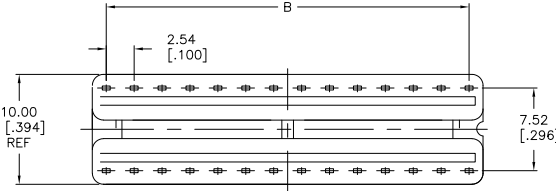
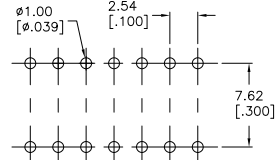
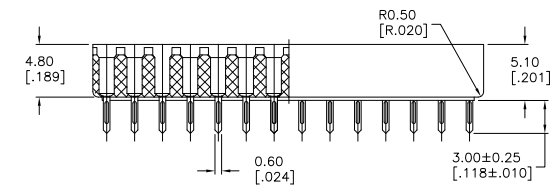
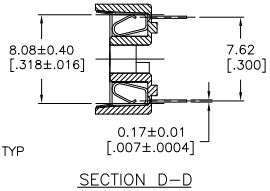
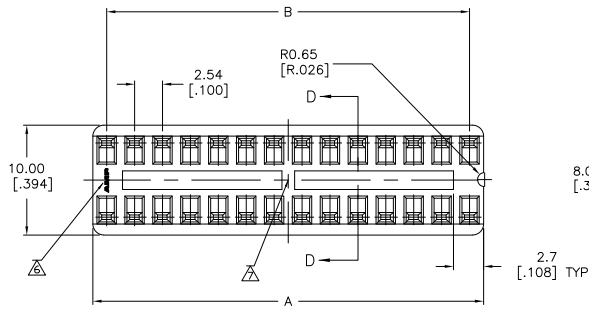

NOTE:

- 1 MATERIAL:
HOUSING: 30% GLASS FILLED PBT, THERMOPLASTIC, BLACK.
CONTACT: PHOS BRONZE
- 2 FINISH: CONTACT PLATING: TIN-LEAD (60u INCHES MIN.)
SOLDERABILITY :95% COVERAGE MIN.;
TEST TEMPERATURE=230°C±5°C
TEST TIME = 5±5 SECONDS.
- 3. MECHANICAL SPECS:
DURABILITY: 50 CYCLES MIN.
INSERTION FORCE:300 GRAMS MAX.
WITHDRAWAL FORCE: 20 GRAMS MIN.
CONTACT RETENTION: 500 GRAMS MIN.
ACCEPTS: 0.20-0.30 [.008-.012] LEADS
- 4. ELECTRICAL SPECS:
VOLTAGE RATING: 250V AC,DC
CONTACT RESISTANCE: 20 MILLOHMS MAX.
CURRENT RATING: 1 AMPERE AC,DC
INSULATION RESISTANCE: 1000 MEGOHMS MIN.
DIELECTRIC WITHSTANDING VOLTAGE: AC 1000 V MIN.
OPERATING TEMPERATURE: -40°C TO +105°C
- 5 AMP LOGO
- 6 LADDER PRESENT FOR 24, 28 & 32 POSITION SOCKETS.
- 7 FINISH: CONTACT PLATING TIN (LEAD FREE); 60 UIN MIN. OVER 30 UIN NI
SOLDERABILITY :95% COVERAGE MIN.;
TEST TEMPERATURE=260±5°C;
TEST TIME = 5±5 SECONDS.

- SUPERSEDED BY 2-390261-0
- SUPERSEDED BY 1-390261-9
- SUPERSEDED BY 1-390261-8
- SUPERSEDED BY 1-390261-7
- SUPERSEDED BY 1-390261-6
- SUPERSEDED BY 1-390261-5
- SUPERSEDED BY 1-390261-4
- SUPERSEDED BY 1-390261-3
- SUPERSEDED BY 1-390261-2
- SUPERSEDED BY 1-390261-1

FINISH	POS	A ±0.20 [.008]	B±0.15 [.006]	PART NO.
Δ	32	40.64 [1.600]	38.10 [1.500]	2-390261-0
Δ	28	35.56 [1.400]	33.02 [1.300]	1-390261-9
Δ	24	30.48 [1.200]	27.94 [1.100]	1-390261-8
Δ	22	27.94 [1.100]	25.40 [1.000]	1-390261-7
Δ	20	25.40 [1.000]	22.86 [.900]	1-390261-6
Δ	18	22.86 [.900]	20.32 [.800]	1-390261-5
Δ	16	20.32 [.800]	17.78 [.700]	1-390261-4
Δ	14	17.78 [.700]	15.24 [.600]	1-390261-3
Δ	8	10.16 [400]	7.62 [300]	1-390261-2
Δ	6	7.62 [300]	5.08 [200]	1-390261-1
Δ	32	40.64 [1.600]	38.10 [1.500]	1-390261-0
Δ	28	35.56 [1.400]	33.02 [1.300]	390261-9
Δ	24	30.48 [1.200]	27.94 [1.100]	390261-8
Δ	22	27.94 [1.100]	25.40 [1.000]	390261-7
Δ	20	25.40 [1.000]	22.86 [.900]	390261-6
Δ	18	22.86 [900]	20.32 [800]	390261-5
Δ	16	20.32 [800]	17.78 [700]	390261-4
Δ	14	17.78 [700]	15.24 [600]	390261-3
Δ	8	10.16 [400]	7.62 [300]	390261-2
Δ	6	7.62 [300]	5.08 [200]	390261-1

THIS DRAWING IS A CONTROLLED DOCUMENT. DIM 08SEP2004

Ytyco Electronics Corporation
Harrisburg, PA 17105-3608

DIP SOCKET, .300 CENTER LINE
LADDER STYLE

SIZE CASE CODE DRAWING NO. A2 00779 C=390261

RESTRICTED TO: -

CUSTOMER DRAWING SCALE 4:1 SHEET 1 of 1 REV M

390261

A