

# ADAPTERS, BETWEEN SERIES

## Type N / SMA, DC - 18 GHz, Bulkhead Mount

### SPECIFICATIONS:

Models: 5209, 5210, 5212, 5213

**RoHS**  
Compliant

<b>Electrical:</b>	
Frequency Range _____	DC - 18.0 GHz
VSWR _____	1.20:1 Max.
Impedance _____	50 Ohms
Temperature Range _____	-65°C to +125°C
<b>Mechanical:</b>	
Connectors _____	Passivated Stainless Steel
Mates with MILSTD-348	
Conductors _____	Gold Plated Beryllium Copper
Nut & Washer _____	Passivated Stainless Steel
O-Ring _____	Silicone Rubber

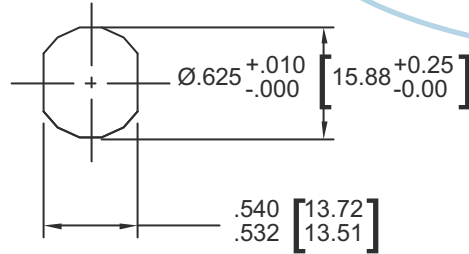

Recommended Panel Configuration

Model Number: **5213**  
Type N Female / SMA Male  
\*Includes O-Ring as Shown

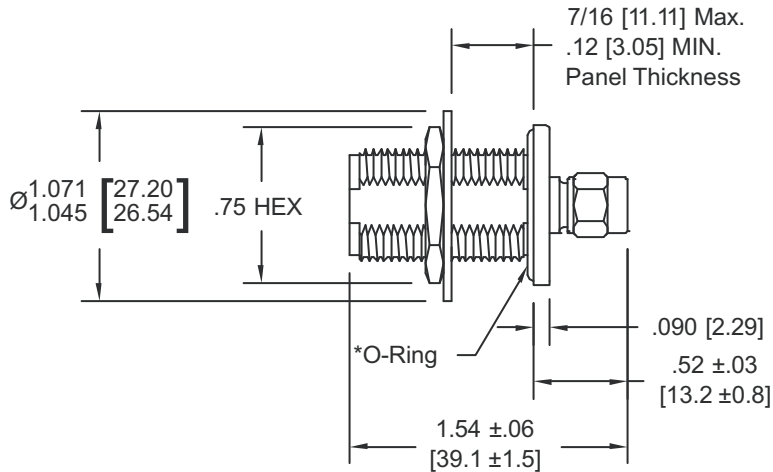

Model Number: **5210**  
Type N Female / SMA Male  
No O-Ring Included

Model Number: **5212**  
Type N Female / SMA Female  
\*Includes O-Ring as Shown

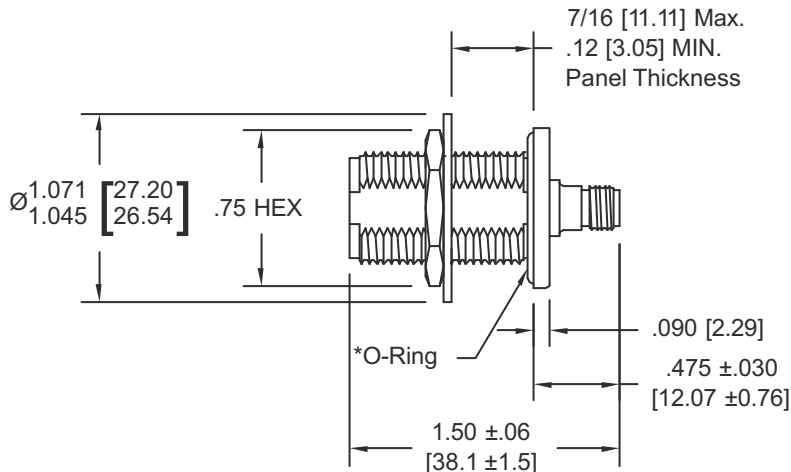

Model Number: **5209**  
Type N Female / SMA Female  
No O-Ring Included

Panel Nut, Lock Washer & O-Ring are Shipped Unassembled

Note: Dimensions in Brackets are Expressed in Millimeters and are for Reference Only.

5213: REV E



Aeroflex / Inmet, Inc. • 300 Dino Drive, Ann Arbor, MI 48103 • U.S.A.  
888-244-6638 or 734-426-5553 • FAX: 734-426-5557  
www.aeroflex.com/inmet • inmet@aeroflex.com