

# ADAPTERS, BETWEEN-SERIES

## Type N / SMA, DC - 18 GHz, Bulkhead Mount

### SPECIFICATIONS:

Models: 5206

**RoHS**  
Compliant

<b>Electrical:</b>	
Frequency Range	DC - 18.0 GHz
VSWR	
DC - 4 GHz	1.10:1 Max.
4 - 12.4 GHz	1.20:1 Max.
12.4 - 18 GHz	1.30:1 Max.
Impedance	50 Ohms
Operating Temp Range	-65°C to +125°C
<b>Mechanical:</b>	
Connectors	Passivated Stainless Steel
<small>Mates with MIL-STD-348</small>	
Conductors	Gold Plated Beryllium Copper
Nut & Washer	Passivated Stainless Steel
O-Ring	Silicone Rubber

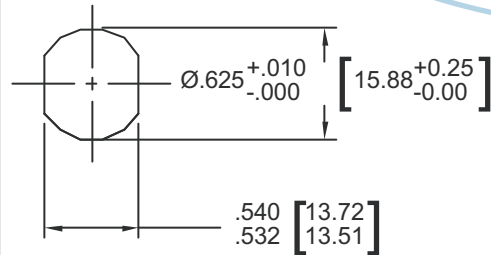

Recommended Panel Configuration

Model Number: **5206**  
Type N Male / SMA Female

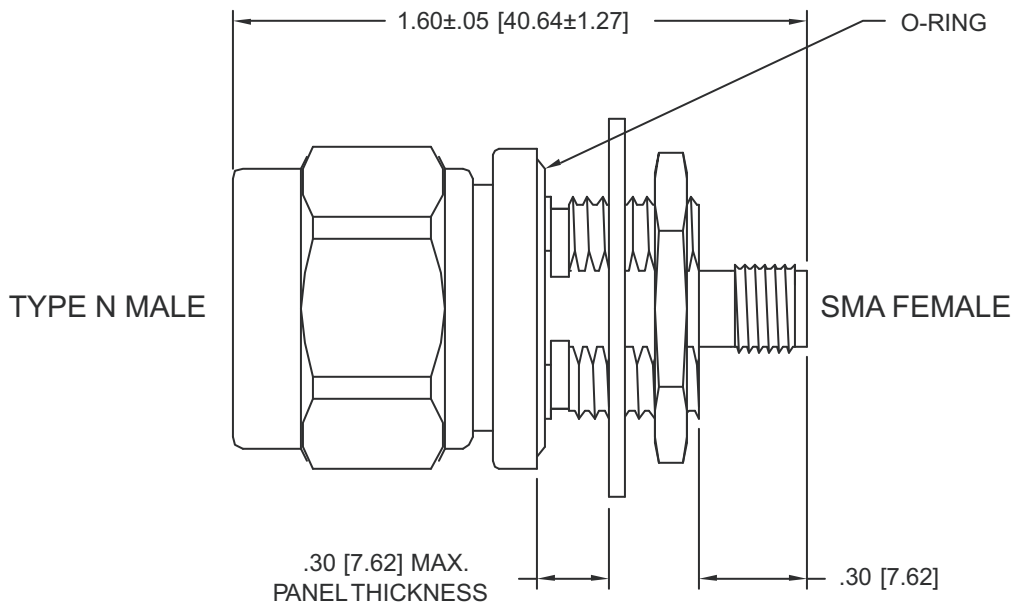

Panel Nut, Lock Washer & O-Ring are Shipped Unassembled

Note: Dimensions in Brackets are Expressed in Millimeters and are for Reference Only.

5206: REV A



Aeroflex / Inmet, Inc. • 300 Dino Drive, Ann Arbor, MI 48103 • U.S.A.  
888-244-6638 or 734-426-5553 • FAX: 734-426-5557  
www.aeroflex.com/inmet • inmet@aeroflex.com