

ADAPTERS, BETWEEN-SERIES

SMA / GPO™ or SMP, DC - 18 GHz

SPECIFICATIONS:

Models: 5190xx, 5191xx, 5192x, 5193x

RoHS
Compliant

Electrical:	
Frequency Range	DC - 18.0 GHz
VSWR	1.20:1 Max.
Impedance	50 Ohms
Operating Temp Range	-65°C to +125°C
Mechanical:	
SMA Connectors	Passivated Stainless Steel
Mates with MIL-STD-348	
GPO™ /SMP Connectors	Gold Plated Beryllium Copper
(GPO Connectors Mate with SMP Connectors IAW MIL-STD-348)	
Conductors	Gold Plated Beryllium Copper
GPO is a trademark of Corning Gilbert Inc.	



Model Number: **5190XX**
GPO™/SMP Male to SMA Male

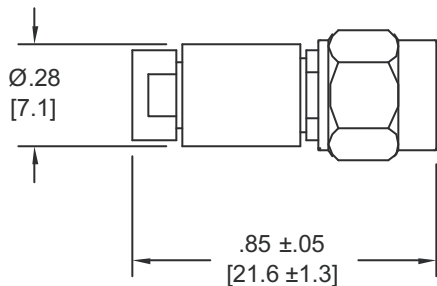

Model Number: **5191XX**
GPO™/SMP Male to SMA Female

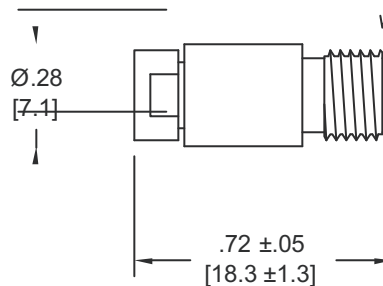

Model Number: **5192X**
GPO™/SMP Female to SMA Male

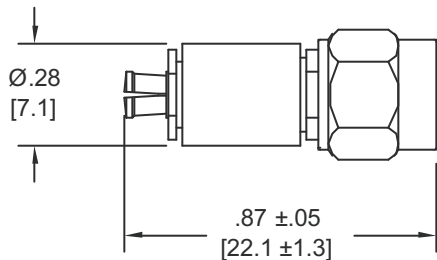

Model Number: **5193X**
GPO™/SMP Female to SMA Female

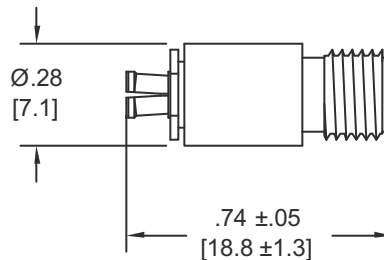

HOW TO ORDER:

Model Number: **519XYZ**

Base Number
As Shown Above

Connector Type
G = GPO™ Connectors
P = SMP Connectors

Connector Style
= Full Detent Male Interface
Force to Engage: 15.0 Lbs. Max.
L = Limited Detent Male Interface
Force to Engage: 5.0 Lbs. Max.

Ordering Examples:

Model Number: **5190G**
GPO™ Male/SMA Male
GPO™ Male has Full Detent Interface

Model Number: **5191PL**
SMP Male/SMA Female
SMP Male has Limited Detent Interface

Model Number: **5193P**
SMP Female/SMA Female

Note: Dimensions in Brackets are Expressed in Millimeters and are for Reference Only.

5190: REV D



Aeroflex / Inmet, Inc. • 300 Dino Drive, Ann Arbor, MI 48103 • U.S.A.
888-244-6638 or 734-426-5553 • FAX: 734-426-5557
www.aeroflex.com/inmet • inmet-sales@eroflex.com