

# ADAPTERS, BETWEEN-SERIES

Type N / BNC, DC - 8 GHz

## SPECIFICATIONS:

Models: 5021, 5022, 5023, 5024

**RoHS**  
Compliant

**AEROFLEX**  
A passion for performance.

### Electrical:

Frequency Range \_\_\_\_\_ DC - 8 GHz  
 VSWR \_\_\_\_\_ 1.30:1 Max.  
 Impedance \_\_\_\_\_ 50 Ohms  
 Operating Temp. Range \_\_\_\_\_ -65°C to +125°C

### Mechanical:

Type N Connectors \_\_\_\_\_ Passivated Stainless Steel  
Mates with MIL-STD-348  
 BNC Connectors \_\_\_\_\_ Nickel Plated Brass  
Mates with MIL-STD-348  
 Conductors \_\_\_\_\_ Gold Plated Beryllium Copper

Model Number: **5021**  
Type N Male / BNC Male

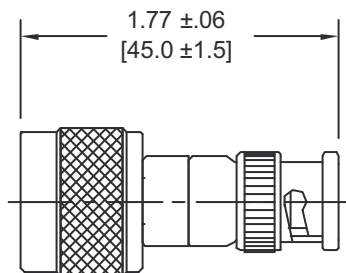

Model Number: **5022**  
Type N Male / BNC Female

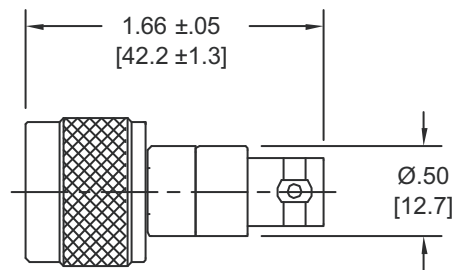

Model Number: **5023**  
Type N Female / BNC Male

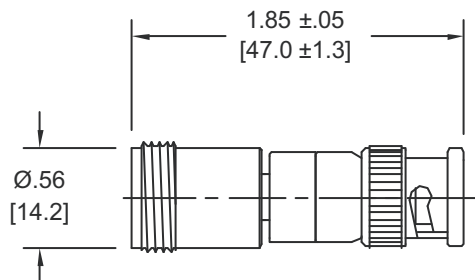

Model Number: **5024**  
Type N Female / BNC Female

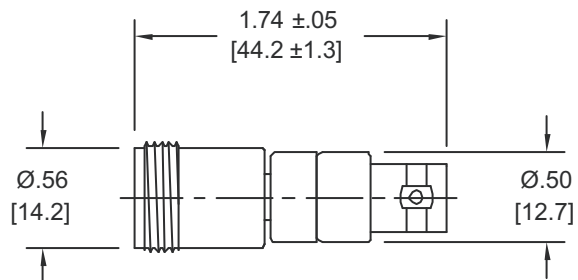

Note: Dimensions in Brackets are Expressed in Millimeters and are for Reference Only.

5021: REVA

**AEROFLEX**  
INMET

Aeroflex / Inmet, Inc. • 300 Dino Drive, Ann Arbor, MI 48103 • U.S.A.  
 888-244-6638 or 734-426-5553 • FAX: 734-426-5557  
 www.aeroflex.com/inmet • inmet@aeroflex.com