

## AMPLIMITE .050 Series Panel Mount Receptacle Assemblies With Rails, Latch Blocks, Series III (Continued)

AMPLIMITE .050 Series Connectors, Series III

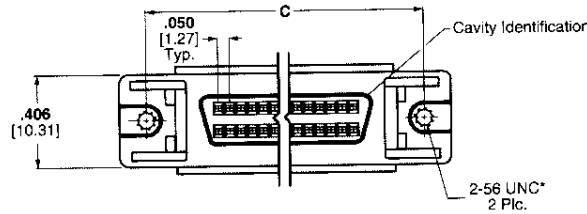
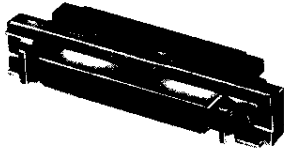

### Materials:

#### Housing and Termination

**Covers**—Thermoplastic, 94V-0 rated, black

**Shell**—Steel, plated bright nickel over copper

**Bracket**—Zinc, plated nickel over copper

**Contacts**—Phosphor bronze, duplex plated .000030 [0.00076] min. gold on mating end, bright tin-lead in termination area, all nickel underplated

#### Recommended wire size—

28 AWG [0.08-0.09mm<sup>2</sup>] or 30 AWG [0.05mm<sup>2</sup>], solid or 7 strand, with a .029-.036 [0.74-0.89] insulation diameter or .050 [1.27] centerline, 28 AWG [0.08-0.09mm<sup>2</sup>] stranded, PVC, flat ribbon cable.

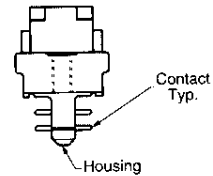
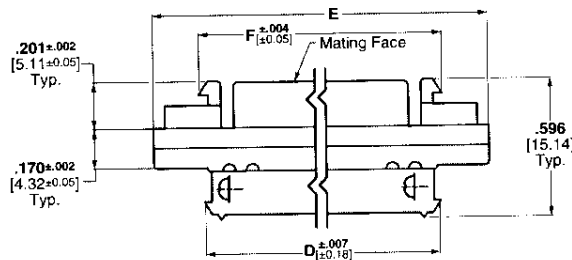

### Technical Documents:

**Product Specifications**—108-1228

**Application Specifications**—114-40029

**Note:** Extra pin contact protection is provided by rails, which facilitate a straight-out, unmating motion. A side-to-side rocking motion should not be used to disengage the connector system.

**Note:** Refer to Tyco Electronics Customer drawings and Application Spec for PCB & panel layouts.

No. of Pos.	Dimensions				Part Numbers
	C	D	E	F	Connectors With Assembled Standard Termination Covers
20	1.080 27.43	.879 22.33	1.315 33.40	.915 23.24	749611-2
26	1.230 31.24	1.029 26.14	1.465 37.21	1.065 27.05	749611-1
50	1.830 46.48	1.629 41.38	2.065 52.45	1.665 42.29	749611-5
50	1.830 46.48	1.629 41.38	2.065 52.45	1.665 42.29	750450-1*
100	3.080 78.23	2.879 73.13	3.315 84.20	2.915 74.04	749611-9

\*Part Number 750450-1 has 4-40 threaded holes. All others have 2-56 threaded holes.  
**Note:** For termination, cover closing and wire lacing tooling, see page 14.  
 For termination tooling other than wire lacing see pages 28,29.