

PRODUCT DATA DRAWING

CAD GENERATED DRAWING	DCN CONTROLLED DOCUMENT	DWG. NO. SF 1115-6009
-----------------------	-------------------------	--------------------------

MATERIAL:

BODY & COUPLING NUT: STAINLESS STEEL PER AMS-5640, UNS S30300, TYPE I

CONTACT & LOCK RING: BERYLLIUM COPPER PER ASTM-B-196, ALLOY C17300, COND. TD04

INSULATOR: TEFLON PER ASTM-D-1457

GASKET: SILICONE RUBBER PER ZZ-R-765, CLASS IIB, GRADE 50/60

FINISH:

BODY & COUPLING NUT: PASSIVATED PER QQ-P-35, TYPE II

CONTACT: GOLD PER MIL-G-45204, TYPE I, GRADE C, CLASS 00; OVER NICKEL PER QQ-N-290, CLASS 1

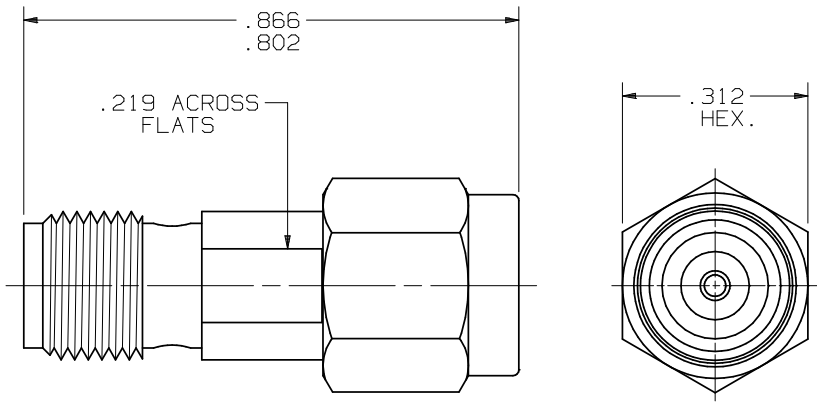

PERFORMANCE:

IMPEDANCE: 50 OHMS

FREQ. RANGE: DC-26.5 GHz

VSWR: 1.20:1 @ DC TO 26.5 GHz

TEMP. RATING: -55°C TO +135°C

INTERFACE: IAW MIL-STD-348

SYM.	DESCRIPTION	DATE	APPR.	UNLESS OTHERWISE SPECIFIED: 1) ALL DIMENSIONS ARE AFTER PLATING. 2) BREAK CORNERS & EDGES .005 R. MAX. 3) CHAM. 1st & LAST THDS. 4) SURFACE ROUGHNESS 63 J MIL-STD-10. 5) DIAS. ON COMMON CENTERS TO BE CONCENTRIC WITHIN .005 T.I.R. 6) REMOVE ALL BURRS.	DIMENSIONS ARE IN INCHES			<i>SV Microwave, Inc.</i> 2400 Centrepark West Drive, Suite 100 West Palm Beach, FL 33409 TITLE: SVK PLUG TO SMA JACK ADAPTER DC TO 26.5 GHz DWG. NO. SF 1115-6009	
	-	REL.DCN 28853	09/02		DWC	TOLERANCES:			
						DECIMALS	FRACTIONAL		ANGULAR
						.X ±.030			X° ±1°0'
				.XX ±.015	±1/64	X°X' ±15'			
				.XXX ±.005					
				DRAWN: BRT 9/05/02	MATERIAL: SEE ABOVE				
				CHECKED: DWC 9/12/02	FINISH: SEE ABOVE	AREA: N/A			
				APPROVED: DWC 9/12/02	SIZE	CAGE NO.	SCALE		
					A	95077	N/A		