

SMA, SMB5 SERIES

50Ω SMA & SMB JACKS

SPECIFICATIONS

For complete specifications and recommended PCB layouts see www.samtec.com?SMA

- Contact Material:** BeCu
- Shell Material:** Brass
- Insulator Material:** PTFE (-PN)
- Operating Temp Range:** -40°C to +90°C
- Contact Resistance:** Center Contact: 6mΩ max
Outer Contact: 2mΩ max
- Insulator Resistance:** 5,000 MΩ
- Impedance:** 50Ω
- Dielectric Withstanding Voltage:** 500 Vrms min (-EM1 & -PN)
750 Vrms min (-TH1)
- Working Voltage:** 170 Vrms max
- RoHS Compliant:** Yes

Processing:
Lead-Free Solderable:
Yes

SMA

GENDER

TYPE

PLATING

ORIENTATION

TERMINATION

Mates with:
RF174, RF316,
PCRF

-J
= Jack

-P
= PCB
Mount

-H
= 30μ"
(0,76μm)
Gold

-ST
= Straight

-RA
= Right Angle

-TH1
= Through-hole

-EM1
= Edge Mount
(-ST only)

-MT1
= Mixed
Technology
(-ST only)

-PN2
= 2-Hole
Panel Mount
(-ST only)

-PN4
= 4-Hole
Panel Mount
(-ST only)

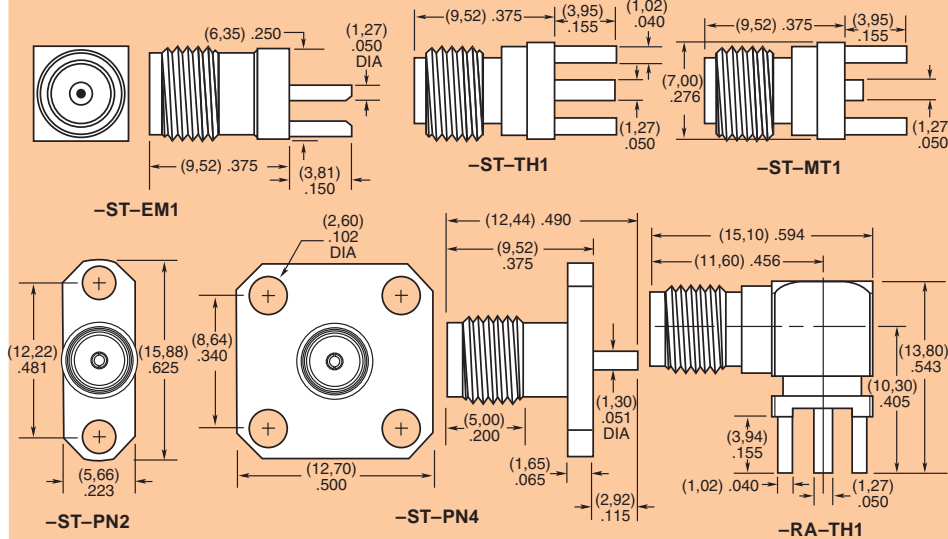

SPECIFICATIONS

For complete specifications and recommended Cable Stripping see www.samtec.com?SMB5

- Shell Material:** Brass
- Contact Material:** Brass
- Insulator Material:** PTFE
- Impedance:** 50Ω
- Frequency Range:** 0-4 GHz
- V.S.W.R:** 1.5 max
- Working Voltage:** 250 Vrms max
- Dielectric Withstanding:** 750 Vrms min
- Contact Resistance:** Center Contact: 6mΩ max
Outer Contact: 2.5mΩ max
- Insulator Resistance:** 1000 MΩ min
- RoHS Compliant:** Yes

Processing:
Lead-Free Solderable: Yes

SMB5

GENDER

TYPE

PLATING

ORIENTATION

TERMINATION

Mates with:
RF174, RF316

-J
= Jack

-P
= PCB
Mount

-H
= 30μ"
(0,76μm)
Gold

-RA
= Right Angle

-TH1
= Through-Hole

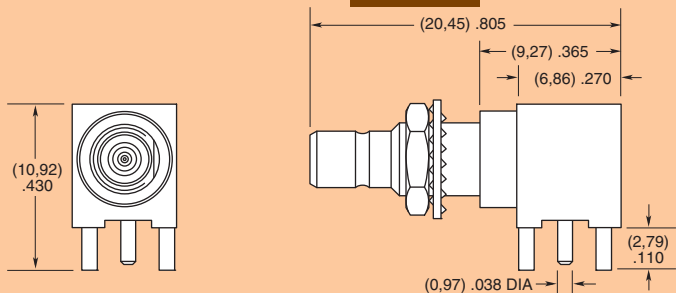

Due to technical progress, all designs, specifications and components are subject to change without notice.

WWW.SAMTEC.COM