

SMB Connectors, 50 Ohm (Continued)

Jacks and Bulkhead Jacks

Jack



Figure A

Bulkhead Jack

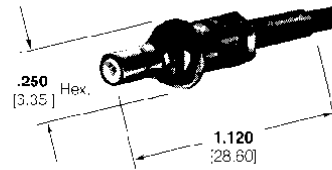

Figure B

Connector Cable Range Selection Code ¹	RG/U Cable	Center Contact Plating	Body Plating	Dielectric	Style	Jack Part No. (Figure A)	Bulkhead Jack Part No. (Figure B)
A	178, 178A, 178B 196, 196A	Gold	Gold	TEFLON	Mil Type	414091-5	414092-5
		Gold	Nickel	TEFLON	Mil Type	414091-6	415006-3
B	174, 316, 188, 188A	Gold	Gold	TEFLON	Mil Type	—	414092-1
		Gold	Nickel	TEFLON	Mil Type	414948-1	415006-1
B3	RD 316, 188 Double Braid	Gold	Gold	TEFLON	Mil Type	414091-2	—
		Gold	Nickel	TEFLON	Mil Type	414948-3	415006-2

Tooling— Page 134

¹Refer to pages 14 and 15 for code specifications.

Bulkhead Jack Adapter

(Jack-to-Jack)

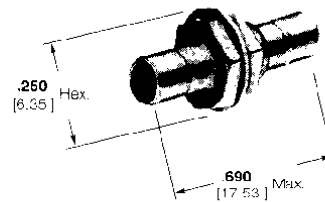
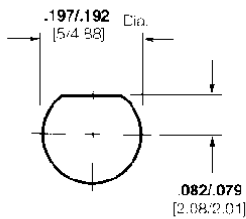

Figure C



Maximum Panel Thickness **.093** [2.36]
Recommended Panel Cutout
for figures B and C

Type	Center Contact Plating	Body Plating	Dielectric	Style	Part No. (Figure C)
Jack-to-Jack	Gold	Nickel	TEFLON	Mil Type	228553-1
	Gold	Gold	TEFLON	Mil Type	228553-2
SMB Plug	Gold	Gold	TEFLON	Mil Type	415385-2