

DRAWING MADE IN THIRD ANGLE PROJECTION

© COPYRIGHT 1974 BY AMP INCORPORATED, HARRISBURG, PA.
 ALL INTERNATIONAL RIGHTS RESERVED. AMP INCORPORATED PRODUCTS
 COVERED BY U. S. AND FOREIGN PATENTS AND/OR PATENTS PENDING.

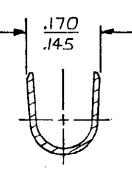
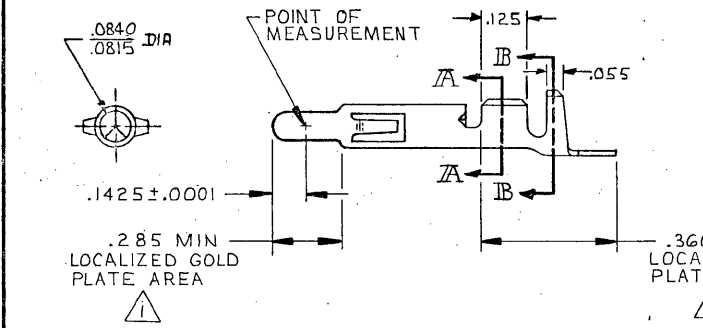
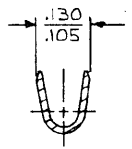
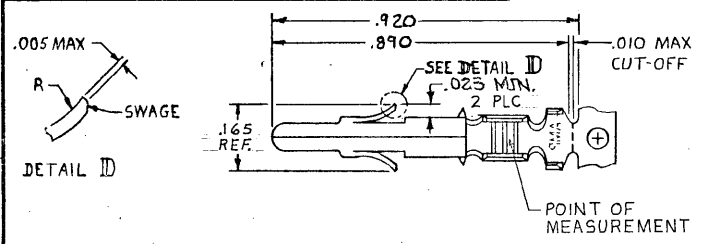

| P | F | ZONE | LTR | DESCRIPTION | DATE | APPROVED |
|---|---|------|----------------|---------------------------|---------|----------|
| ✓ | | | F | REDRAWN W/O CHANGE M-6457 | 6-5-81 | MSE/DH |
| ✓ | | | G | ADDED -3 PER TTI 82-61 | 9-30-82 | MSE/DH |
| ✓ | | | H | REVISED AG 57 | 10/2/82 | RS |
| ✓ | | | H ₁ | RESTORED | 4/4/83 | RS |
| ✓ | | | J | OBsolete -3 CM 473 | 4-15-86 | KW/RS |
| ✓ | | | K | RLSD -7 PER PR CM 90-7 | 1-17-90 | TB/RS |
| ✓ | | | L | REVISED PER CM-3286 | 2-7-91 | RS |
| ✓ | | | M | REV PER EC 0730-3607-91 | 1-7-94 | RV/RS |
| ✓ | | | N | REV PER EC 0730-0141-94 | 7-26-94 | RV/RS |

△ .000030 MIN GOLD AT POINT OF MEASUREMENT IN GOLD PLATE AREA; .000030 MIN TIN IN TIN PLATE AREA; .000050 NICKEL UNDERPLATE ON ENTIRE CONTACT.

| | | | |
|-------------------|---------|------------|----------|
| 350669-1 | PRE-TIN | .012 BRASS | 350654-7 |
| LOOSE PIECE (REF) | FINISH | MATERIAL | PART NO |

| | | | |
|--|---|---|---------------------|
| UNLESS OTHERWISE SPECIFIED DIMENSIONS ARE IN INCHES. TOLERANCES ON: DECIMALS ± .015 ANGLES ± | CONTRACT NO | AMP AMP INCORPORATED Harrisburg, Pa. | |
| | DR m. Foker 5-6-81 CHK D. S. Cole 6/9/81 | NAME PIN, GROUNDING UNIVERSAL MATE-N-LOK | |
| WIRE RANGE 20-14 AWG | APPD P. L. L. 6-10-81 | SIZE B | CODE IDENT NO 00779 |
| INSULATION RANGE .130 DIA MAX | OTHER APPD | DRAWING NO | 350654 |
| | | SCALE NTS | SHEET # |

CUSTOMER DRAWING