

DRAWING MADE IN THIRD ANGLE PROJECTION
 THIS DRAWING IS UNPUBLISHED. RELEASED FOR PUBLICATION
 COPYRIGHT 19 BY AMP INCORPORATED. ALL INFORMATION RIGHTS RESERVED.

REV	DATE	DESCRIPTION	BY	APPD
1	1-21-89	F REV PER EC 0730-4050-93		

1. ACCEPTS CONTACT P/N 770601-1.
2. DIMENSIONS IN BRACKETS ARE IN INCHES.
3. ACCEPTS MTA-100 KEYING PLUG P/N 641994-1.

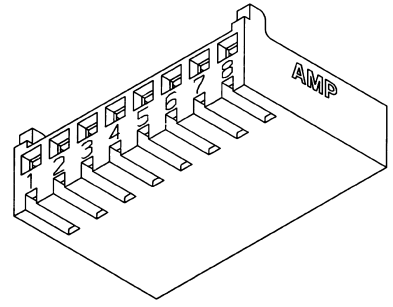
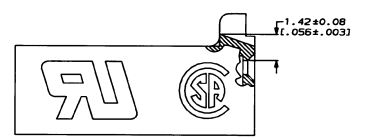
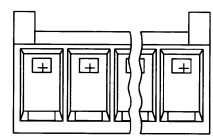
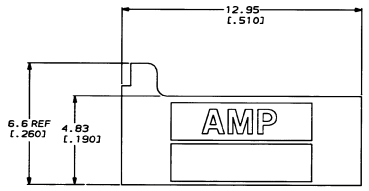
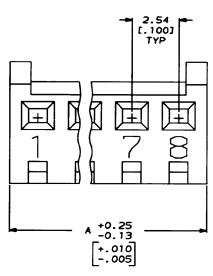

2.52071.63	28	2-770602-8
2.72069.08	27	2-770602-7
2.62066.58	26	2-770602-6
2.52064.01	25	2-770602-5
2.42061.47	24	2-770602-4
2.32058.93	23	2-770602-3
2.22056.39	22	2-770602-2
2.12053.85	21	2-770602-1
2.02051.31	20	2-770602-0
1.82048.77	19	1-770602-9
1.82046.23	18	1-770602-8
1.72043.69	17	1-770602-7
1.62041.15	16	1-770602-6
1.52038.61	15	1-770602-5
1.42036.07	14	1-770602-4
1.32033.53	13	1-770602-3
1.22030.99	12	1-770602-2
1.12028.45	11	1-770602-1
1.02025.91	10	1-770602-0
.82023.37	9	770602-9
.82020.83	8	770602-8
.72018.29	7	770602-7
.62015.75	6	770602-6
.52013.21	5	770602-5
.42010.67	4	770602-4
.3208.13	3	770602-3
.2205.59	2	770602-2
IN MM	NO. OF CIRCUITS	PART NUMBER
A		

DO NOT SCALE PRINT. UNLESS SPECIFIED DIMENSIONS IN INCHES TOLERANCES ON + S PL. DEC 4 S PL. DEC 12 (.005) ANGLES MATERIAL: NYLON, UL 94V-0 NATURAL FINISH	DR C. MARTIN 10-4-89 APPD B. SHORE 10-4-89 APPRO B. SHORE 10-4-89 PRODUCT SPEC APPLICATION SPEC WEIGHT	AMP INCORPORATED Merrillville, Pa. 17053 NAME HOUSING, CST-100 DRAWING NO 770602 SCALE 10:1	PART NO SHEET 1 OF 1
---	--	--	-------------------------



CUSTOMER DRAWING