

4

3

2

1

THIS DRAWING IS UNPUBLISHED. RELEASED FOR PUBLICATION. BY AMP INCORPORATED. ALL RIGHTS RESERVED.

LOC	DIST	REVISIONS					
		F	LR	DESCRIPTION	DATE	ENR	APPD
BD	48	S		0B5 -12,-13,-24,-27 PER EC 0020-724-95	16 FEB 96	MB	CS
		T		REDRAWN AND REV PER EC 0020-170-96	16 FEB 96	MB	LF
		U		0B5 -25 PER EC 0420-143-96	28 OCT 97	TS	SB
		V		REV PER EC 001D-0260-00	12 SEP 01	JR	J6

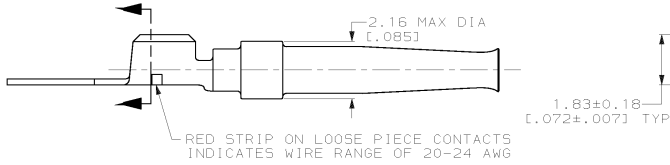
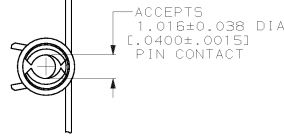
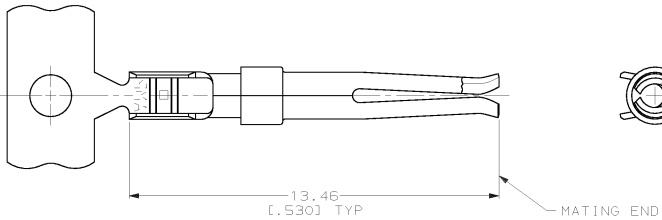

- ⚠ 2.54µm [.000100] MIN TIN OR TIN-LEAD OVER 1.27µm [.000050] MIN NICKEL.
- ⚠ 0.76µm [.000030] MIN GOLD FOR A LENGTH OF 2.54 [.100] MIN FROM MATING END, GOLD FLASH ON REMAINDER ALL OVER 1.27µm [.000050] MIN NICKEL.
- ⚠ GOLD PLATING PER MIL-G-45204, TIN PLATING PER MIL-T-10727, NICKEL PLATING PER QQ-N-290.
- ⚠ GOLD FLASH OVER 0.76µm [.000030] MIN NICKEL.
- ⚠ GOLD FLASH FOR A LENGTH OF 2.54 [.100] MIN FROM MATING END, 2.54µm [.000100] MIN TIN PLATED WIRE BARRELS, ALL OVER 0.76µm [.000030] MIN NICKEL.
- ⚠ 0.76µm [.000030] MIN GOLD FOR A LENGTH OF 2.54 [.100] MIN FROM MATING END, 2.54µm [.000100] MIN TIN PLATED WIRE BARRELS, ALL OVER 1.27µm [.000050] MIN NICKEL.

SUPERSEDED BY 205201-5	SMALL PACK	SEE DETAIL C	NO	⚠	2-205201-8
OBSOLETE	STANDARD	-	YES	⚠	2-205201-5
SUPERSEDED BY 205201-6	STANDARD	-	YES	⚠	2-205201-2
SUPERSEDED BY 205201-6	STANDARD	-	YES	⚠	1-205201-4
	STANDARD	SEE DETAIL C	NO	⚠	205201-7
	STANDARD	-	YES	⚠	205201-6
	STANDARD	SEE DETAIL C	NO	⚠	205201-5
	STANDARD	-	YES	⚠	205201-3
PACKAGING TYPE	LOOSE PIECE	FOR MINI-APPLICATOR	FINISH	PART NUMBER	

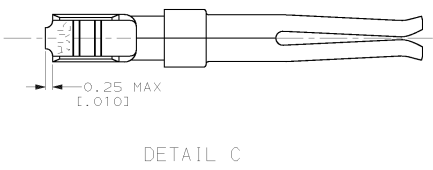

DIMENSIONS mm (INCHES)		TOLERANCES UNLESS OTHERWISE SPECIFIED		DWG BY: BLINNER CHK: S. STONE DATE: 16 FEB 96	AMP AMP Incorporated Harrisburg, PA 17105-3608	
Ø	PLC	±.01		DATE	NAME	
Ø	PLC	±.01		DATE	SOCKET CONTACT, SIZE 20 DF, 20-24 AWG	
Ø	PLC	±.01		DATE	SIZE	
Ø	PLC	±.01		DATE	EAGE CODE	
Ø	PLC	±.01		DATE	DRAWING NO	
Ø	PLC	±.01		DATE	A2100779	
Ø	PLC	±.01		DATE	C-205201	
Ø	PLC	±.01		DATE	SCALE	
Ø	PLC	±.01		DATE	10:1	
Ø	PLC	±.01		DATE	SHEET	
Ø	PLC	±.01		DATE	1 OF 1	
Ø	PLC	±.01		DATE	REV	
Ø	PLC	±.01		DATE	V	

205201