

PC card drilling dimensions (after plating)
(thickness 2.40 ± 0.20mm)

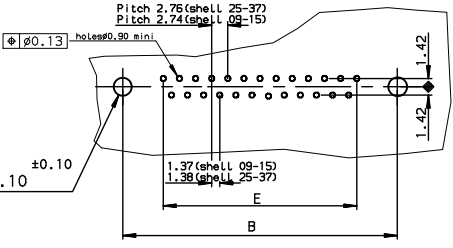

SHELL	A ± 0.38	B ± 0.12	C ± 0.10	D ± 0.25	E ± 0.07	PART NUMBER
09	30.81	24.99	16.96	16.79	10.96	D09P24B6GV00
15	39.14	33.32	25.18	25.12	19.18	D15P24B6GV00
25	53.03	47.04	39.12	38.84	33.12	D25P24B6GV00
37	69.32	63.50	55.68	55.30	49.68	D37P24B6GV00
37	69.32	63.50	55.68	55.30	49.68	D37P24B4GV00

SHELL	A ± 0.38	B ± 0.12	C ± 0.10	D ± 0.25	E ± 0.07	PART NUMBER
09	30.81	24.99	16.96	16.79	10.96	D09P24B6GV00LF
15	39.14	33.32	25.18	25.12	19.18	D15P24B6GV00LF
25	53.03	47.04	39.12	38.84	33.12	D25P24B6GV00LF
37	69.32	63.50	55.68	55.30	49.68	D37P24B6GV00LF
37	69.32	63.50	55.68	55.30	49.68	D37P24B4GV00LF

GENERAL CHARACTERISTICS AND ROHS INFORMATIONS:
SEE DRAWING C01-8646-0000

www.fcconnect.com		surface	tolerance std	projection	European Views	
		ISO 1302	ISO 406 ISO 1101	mm		
		TOLERANCES UNLESS OTHERWISE SPECIFIED				
Dr	LELEON	1992/09/14	ANGULAR	size	A3	Scale 2
Eng	PESSON	1992/09/14	LINEAR	ECN	LS06-0097	
Chr	LEGARE	1992/09/14	0.xx' ± 2'	Product family	D-SUB	Spec ref -
Appr	LEGARE	1992/09/14	0.xxx' ± 2'			
Title		MALE CONNECTOR DELTA D ST		Rev.		
straight, solder type for		C01-8646-0107		G		
catalog no		CUSTOMER		sheet 1 of 1		

rev	ecn no	dr	date
C	-	-	1996/09/09
D	LS05-001	MPE	2005/03/12
E	LS05-0056	MPE	2005/06/27
F	LS05-0070	LGO	2005/11/03
G	LS06-0097	LGO	2006/07/29
-	-	-	-
-	-	-	-

REV F - 2006-04-17