

4

3

2

1

THIS DRAWING IS UNPUBLISHED. RELEASED FOR PUBLICATION.
 © COPYRIGHT BY TYCO ELECTRONICS CORPORATION. ALL RIGHTS RESERVED.

LOC	QTY	REV	DESCRIPTION	DATE	MIN	APPD
FT	0					
		H	REVISED PER 0638-0956-04	11/18/04	SS	GS

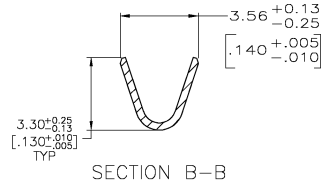
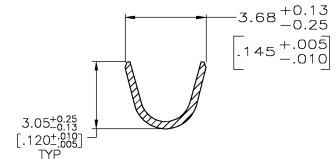
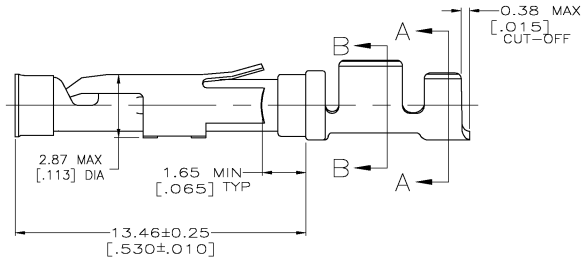
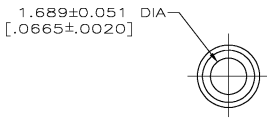
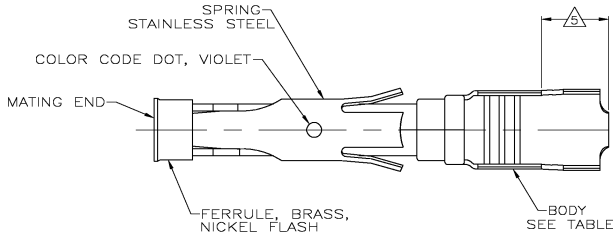

- 1. 0.76µm [.000030] MIN GOLD PER MIL-G-45204 ON MATING END FOR A LENGTH OF 5.08 [.200] MIN WITH GOLD FLASH ON THE REMAINDER OVER 0.76µm [.000030] MIN NICKEL PER QQ-N-290.
- 2. 1.27µm [.000050] MIN TIN-LEAD PER MIL-T-10727 OVER 0.76µm [.000030] MIN NICKEL PER QQ-N-290.
- 3. 0.76µm [.000030] MIN GOLD PER MIL-G-45204 ON MATING END FOR A LENGTH OF 5.08 [.200] MIN WITH A UNIFORM GRADIENT TO 0.25µm [.000010] MIN GOLD PER MIL-G-45204 ON THE REMAINDER OVER 0.76µm [.000030] MIN NICKEL PER QQ-N-290.
- 4. 0.38µm [.000015] MIN GOLD PER MIL-G-45204 ON MATING END FOR A LENGTH OF 5.08 [.200] MIN WITH GOLD FLASH ON THE REMAINDER OVER 0.76µm [.000030] MIN NICKEL PER QQ-N-290.
- 5. GOLD PLATING NOT REQUIRED IN THIS AREA.
- 6. WIRE RANGE 18-14 AWG.
- 7. INSULATION RANGE 2.03[.080]-2.54[.100].
- 8. 0.38µm [.000015] MIN GOLD PER MIL-G-45204 ON MATING END FOR A LENGTH OF 5.08 [.200] MIN, 1.27µm [.000050] MIN TIN-LEAD PER MIL-T-10727 FOR A LENGTH OF 5.69 [.224] MIN ON OPPOSITE END, BOTH OVER 1.27µm [.000050] MIN NICKEL PER QQ-N-290 ON ENTIRE CONTACT.
- 9. 1.27µm [.000050] MIN TIN PER MIL-T-10727 OVER 0.76µm [.000030] MIN NICKEL PER QQ-N-290.

PACKAGING	BODY FINISH	BODY MATERIAL	STRIP P/N REF	PART NUMBER
STANDARD	△	CU-NI ALLOY	2-66358-1	1-66360-6
STANDARD	△	CU-NI ALLOY	2-66358-0	1-66360-5
STANDARD	△	CU-NI ALLOY	1-66358-9	1-66360-4
SMALL PACK	△	BRASS	1-66358-6	1-66360-3
STANDARD	△	BRASS	1-66358-6	1-66360-2
SMALL PACK	△	BRASS	66358-4	1-66360-1
SMALL PACK	△	BRASS	66358-2	1-66360-0
OBSOLETE	△	BRASS	1-66358-5	66360-9
STANDARD	△	PHOSPHOR BRONZE	1-66358-3	66360-8
OBSOLETE	△	PHOSPHOR BRONZE	1-66358-2	66360-7
STANDARD	△	BRASS	66358-4	66360-4
STANDARD	△	BRASS	66358-3	66360-3
STANDARD	△	BRASS	66358-2	66360-2
STANDARD	△	BRASS	66358-1	66360-1

THIS DRAWING IS A CONTROLLED DOCUMENT. DATE: 06/23/92

DESIGNED BY: L. SIEPE
 CHECKED BY: W. LENKER
 DRAWN BY: G. STEINHAUER
 PROJECT SPEC: 7-8-92

APPROVED BY: [Signature]

DATE: 6-11-92

APPLICATION SPEC: [Blank]

WEIGHT: [Blank]

SCALE: 8:1

SHEET: 1 OF 1

REV: H

TYCO Electronics
 Tyco Electronics Corporation
 Harrisburg, Pa 17105-3608

SOCKET ASSEMBLY,
 LOOSE PIECE, TYPE III+

SEE CASE CODE (DRAWING NO)
 A2 00779 66360