

8	7	6	5	4	3	2	1
THIS DRAWING IS UNAPPROVED		REVISIONS FOR INFORMATION					
BY: [Signature]		DATE: [Date]					

REV	DATE	DESCRIPTION	BY	CHK	APP
00					
0		RELEASED PER EC 0513-0024-04			

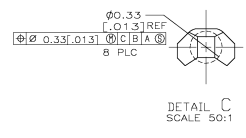
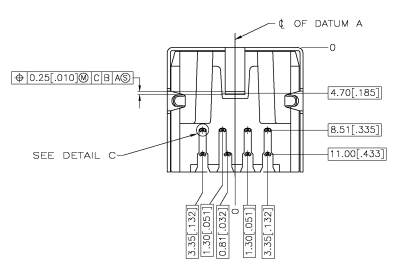
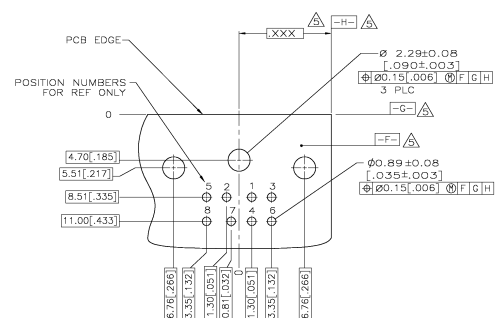
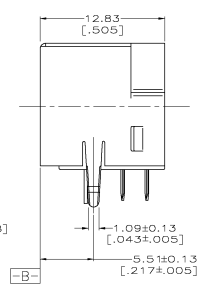
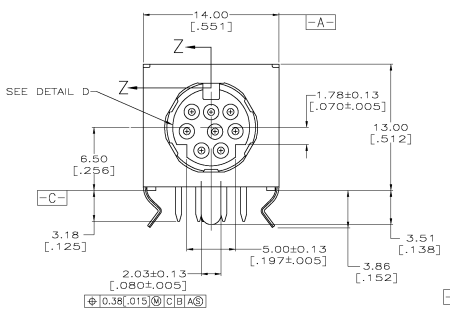
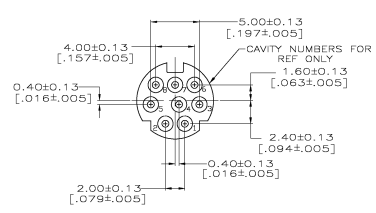
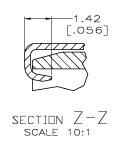
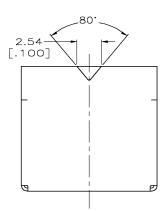

- RECEPTACLE CONTACTS: COPPER ALLOY.  
RECEPTACLE SHIELD: COPPER ALLOY.  
HOUSING: LCP, COLOR: BLACK, UL 94V-0 RATED.
- PLATING:  
RECEPTACLE CONTACTS - GOLD PLATED 0.00076 [0.00030] MIN ON MATING END, TIN PLATED 0.0030 [0.00120] MIN ON SOLDER TAIL, ALL OVER 0.0013 [0.00050] MIN NICKEL.
- PLATING:  
SHIELD: 0.0015-0.004 [0.00059-0.00158] BRIGHT TIN.
- RECEPTACLE ASSEMBLY MATES WITH 8 PIN 9.00±0.10 [0.354±0.04] DIAMETER PLUG.
- DATUMS AND BASIC DIMENSION DETERMINED BY CUSTOMER.

1658998-1  
PART NUMBER

THIS DRAWING IS A CONTROLLED DOCUMENT		REV	DATE	DESCRIPTION	BY	CHK	APP
UNAPPROVED		00					
BY: [Signature]		DATE: [Date]					
DATE: [Date]		RELEASED PER EC 0513-0024-04					

DIMENSIONS mm (INCH)	DIMENSIONAL TOLERANCES FRACTIONAL DECIMAL ANGLES HOLE LOCATIONS SURFACE FINISH	MFG MICHANICAL PC BOARD MFG MICHANICAL MFG MICHANICAL MFG MICHANICAL	TOLERANCES FRACTIONAL DECIMAL ANGLES HOLE LOCATIONS SURFACE FINISH	RECEPTACLE ASSY W/HOLD DOWN, 8 POS RIGHT ANGLE, MINATURE CIRCULAR DIN	SEE DATE CODE DRAWING NO A1007798	PART NUMBER 1658998	RESTRICTED TO ---
-------------------------	---	--	---	--	---	------------------------	----------------------