

## Features

- 6 mm Round / Single-Turn / Cermet Industrial / Open Frame
- Cross slot adjustment options
- Horizontal and vertical mounting styles
- Dust resistant/splash resistant covers
- Front and top adjust styles

■ RoHS compliant\*

## TC86 - 6 mm Round Trimpot® Trimming Potentiometer

### Electrical Characteristics

Standard Resistance Range ..... 100 ohms to 1 megohm  
 (see standard resistance table)  
 Resistance Tolerance .....  $\pm 20\%$  std.  
 (tighter tolerance available)  
 Absolute Minimum Resistance  
 $\leq 500$  Ohms ..... 10 ohms max.  
 $> 500$  Ohms ..... 2 % max. of TR  
 Contact Resistance Variation .. 5 % max.  
 Resolution ..... Infinite  
 Adjustment Angle .....  $240^\circ \pm 20^\circ$

### Environmental Characteristics

Power Rating (100 VDC max.)  
 70 °C ..... 0.3 watt  
 Temperature Range ..... -30 °C to +85 °C  
 Temperature Coefficient ...  $\pm 250$  ppm/°C  
 Humidity ..... 95 % RH  
 Load Life ..... 500 hours @ 70 °C  
 Rotational Cycling ..... 50 cycles

### Physical Characteristics

Torque ..... 30-300 gf-cm  
 Mechanical Angle .....  $240^\circ \pm 20^\circ$   
 Marking ..... Part marking code  
 Standard Packaging ..... 500 pcs./bag  
 Adjustment Tool ..... H-90  
 Aqueous cleaning not recommended

### How To Order

**TC86 W - 1 - 103**

Model \_\_\_\_\_  
 Style \_\_\_\_\_  
 Standard Product Indicator \_\_\_\_\_  
 Resistance Code \_\_\_\_\_

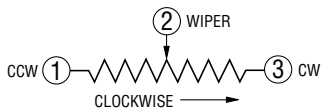

DIMENSIONS:  $\frac{\text{MM}}{\text{(INCHES)}}$

TOLERANCES:  $\pm \frac{0.25}{(.010)}$  EXCEPT WHERE NOTED

### Product Dimensions

#### Top Adjust Common Dimensions

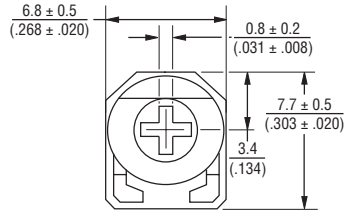

#### Side Adjust Common Dimensions

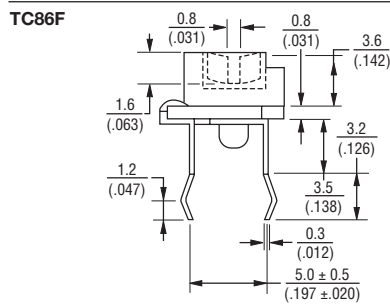
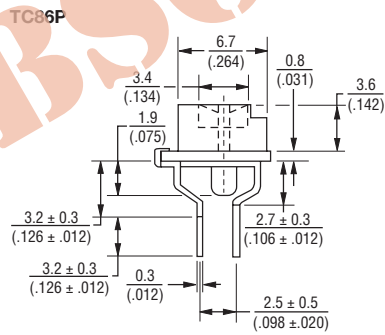
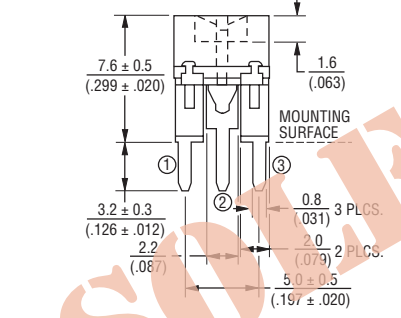
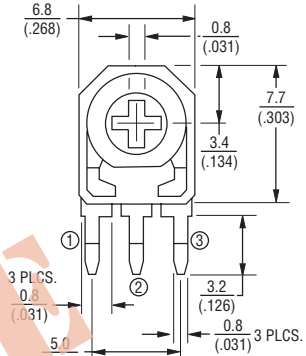

TC86W

TC86K

### Suggested PCB Layout - Style F

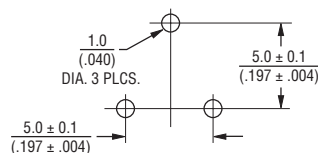

### Suggested PCB Layout - Styles K,P,W

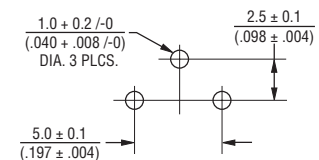

\*RoHS Directive 2002/95/EC Jan 27 2003 including Annex. Specifications are subject to change without notice. Customers should verify actual device performance in their specific applications.

Standard Resistance Table

Resistance (Ohms)	Resistance Code
100	101
200	201
500	501
<b>1,000</b>	<b>102</b>
<b>2,000</b>	<b>202</b>
<b>5,000</b>	<b>502</b>
<b>10,000</b>	<b>103</b>
<b>20,000</b>	<b>203</b>
<b>50,000</b>	<b>503</b>
<b>100,000</b>	<b>104</b>
200,000	204
500,000	504
1,000,000	105

Popular values listed in boldface.

OBSOLETE