

PRODUCT NUMBER
SEE TABLE

SECTION U-U

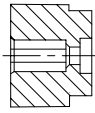

SECTION X-X

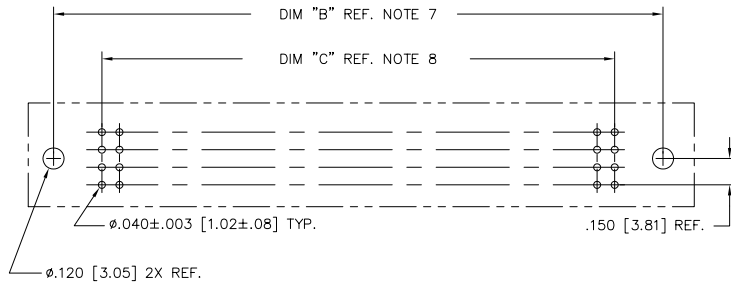
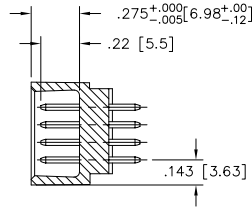

RECOMMENDED PCB LAYOUT
(ALL HOLES LOCATED ON .100/2.54 GRID
UNLESS OTHERWISE SPECIFIED)

mat'l. code NOTE 4		surface ISO 1302	tolerance ISO 406 ISO 1101	projection	product family HPC	
ltr	ecn no	dr	date	title		
s				4 ROW VERTICAL HEADER W/SOLDER TAIL PINS, 0 G.P.		
tolerances unless otherwise specified				INCH/MM	scale 1:1	
angles	linear		.XX±.01/.3		sheet 2 of 4	
0°±2°			.XXX±.005/.13		size	
dr	D.INGRAM		7/20/05		50015	A3
enrg	D.HORCHLER		7/20/05		type	Product Customer Drawing
chr	T.BREWBAKER		7/20/05			
appd	D.HORCHLER		7/20/05			
sheet index	revision sheet					

PDM: Rev:S STATUS:Released Printed: Feb 06, 2010

PRODUCT NUMBER	NUMBER OF POSITIONS NOTE 3	TAIL LENGTH ±.015/0.38	CONTACT PLATING
50015-1Y1YA	YYY	.177/4.50	30u"/.76u Au
50015-1Y1YC	YYY	.533/13.54	30u"/.76u Au
50015-1Y1YD	YYY	.733/18.62	30u"/.76u Au
50015-1Y1YG	YYY	.250/6.35	30u"/.76u Au
50015-1Y1YJ	YYY	.120/3.05	30u"/.76u Au
50015-3Y1YA	YYY	.177/4.50	50u"/1.27u Au
50015-3Y1YC	YYY	.533/13.54	50u"/1.27u Au
50015-3Y1YD	YYY	.733/18.62	50u"/1.27u Au
50015-3Y1YG	YYY	.250/6.35	50u"/1.27u Au
50015-3Y1YJ	YYY	.120/3.05	50u"/1.27u Au
50015-5Y1YA	YYY	.177/4.50	30u"/.76u GXT
50015-5Y1YLF	YYY	.177/4.50	30u"/.76u GXT
50015-5Y1YC	YYY	.533/13.54	30u"/.76u GXT
50015-5Y1YCLF	YYY	.533/13.54	30u"/.76u GXT
50015-5Y1YD	YYY	.733/18.62	30u"/.76u GXT
50015-5Y1YDLF	YYY	.733/18.62	30u"/.76u GXT
50015-5Y1YG	YYY	.250/6.35	30u"/.76u GXT
50015-5Y1YGLF	YYY	.250/6.35	30u"/.76u GXT
50015-5Y1YJ	YYY	.120/3.05	30u"/.76u GXT
50015-5Y1YJLF	YYY	.120/3.05	30u"/.76u GXT
50015-XX022	128	.250/6.35	30u"/.76u Au
50015-XX022LF	128	.250/6.35	30u"/.76u GXT

NOTES:

1. PRODUCT NUMBERING CODE

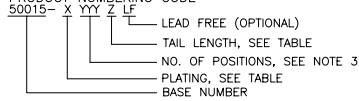

PRODUCT NUMBERING CODE FOR SELECT LOAD

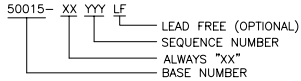

- ② MANUFACTURE'S LOGO, PN, AND LOT CODE TO APPEAR ON THIS SURFACE.
- ③ THIS PRODUCT IS CONFIGURED IN SIZES OF 6 THRU 80 COLUMNS IN INCREMENTS OF ONE, i.e. 6, 7, 8, 9,79, 80.
- ④ MATERIAL:
HOUSING - GLASS AND MINERAL FILLED HIGH TEMPERATURE THERMOPLASTIC, FLAME RETARDANT PER UL94V-0. COLOR-BLACK
CONTACT - PHOS BRONZE
5. PLATING:
CONTACT AREA - SEE PRODUCT NUMBER TABLE
TAILS-EITHER TIN OR TIN LEAD, SEE PRODUCT NUMBER TABLE
- ⑥ DIMENSION "A" CALCULATION = .100 (2.54) X NO. OF COLUMNS + .75 (19.1)
- ⑦ DIMENSION "B" CALCULATION = .100 (2.54) X NO. OF COLUMNS + .450(11.43)
- ⑧ DIMENSION "C" CALCULATION = .100 (2.54) X NO. OF COLUMNS - .100(2.54)
9. ALL POSITIONS ARE LOADED EXCEPT FOR -XXYYY ASSEMBLIES WHICH HAVE SELECTIVE LOADING.
10. THIS PRODUCT (WITH "LF" SUFFIX) MEETS EUROPEAN UNION DIRECTIVES AND OTHER COUNTRY REGULATIONS AS DESCRIBED IN GS-22-008.
11. THIS HOUSING WILL WITHSTAND EXPOSURE TO 260°C PEAK TEMPERATURE FOR 10-30 SECONDS IN A CONVECTION, INFRA-RED OR VAPOR PHASE REFLOW OVEN.

mat'l. code		surface	tolerance	projection	product family
NOTE 4		ISO 1302	ISO 406		HPC
ltr	ecn no/dr	ISO 1101	ISO 1101		title
s	date	tolerances unless otherwise specified			4 ROW VERTICAL HEADER
		angles	.XX±.01/3		W/SOLDER TAIL PINS, 0 G.P.
		linear	.XXX±.005/13		dwg no
		dr	XXXX±.0020/05		sheet 4 of 4 size
		engr	D.INGRAM 7/20/05		50015 A3
		chr	T.BREWBAKER 7/20/05	type	
		appd	D.HORCHLER 7/20/05	Product Customer Drawing	
sheet index	revision sheet				