

## 5206473 -3 Product Details

**Live Product Chat** US Only  
8:30am - 5pm ET, Mon - Fri

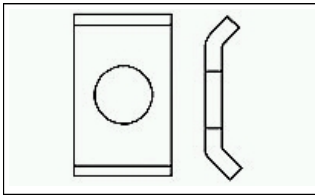

**5206473 -3**

Active

### Hardware (AMPLIMITE)

[Always EU RoHS/ELV Compliant](#) ( [Statement of Compliance](#) )

#### Product Highlights:

- ? Saddle Washer
- ? Thread Size = 4 -40
- ? Clear Chromate Screw Finish
- ? Set of Two

[View all Features](#) | [Find Similar Products](#)

### Quick Links

- [Check Pricing & Availability](#)
- [Search for Tooling Product Feature Selector](#)
- [Contact Us About This Product](#)

### Documentation & Additional Information

#### Product Drawings:

- ? [WASHER, SADDLE, SPECIAL](#) (PDF, English)

#### Catalog Pages/Data Sheets:

- ? None Available

#### Product Specifications:

- ? None Available

#### Application Specifications:

- ? None Available

#### Instruction Sheets:

- ? None Available

#### CAD Files:

- ? None Available

#### Additional Information:

- ? [Product Line Information](#)

#### Related Products:

- ? [Tooling](#)

[List all Documents](#)

### Product Features (Please use the Product Drawing for all design activity)

#### Product Type Features:

- ? [Product Type](#) = Saddle Washer
- ? [Thread Size](#) = 4 -40
- ? For Use With = Mounting Screw 5206052 -3
- ? Body Material = Cold rolled Steel

#### Termination Related Features:

- ? [Screw Finish](#) = Clear Chromate

#### Body Related Features:

- ? Body Plating = Zinc

#### Industry Standards:

- ? Government/Industry Qualification = No
- ? [RoHS/ELV Compliance](#) = RoHS compliant, ELV compliant
- ? [Lead Free Solder Processes](#) = Not relevant for lead free process
- ? RoHS/ELV Compliance History = Always was RoHS compliant

#### Packaging Related Features:

- ? [Packaging Method](#) = Set of Two
- ? Packaging Quantity = 50

#### Other:

- ? Brand = AMP