

Shielded AMPLIMITE .050 Series Slimline Connectors (Continued)

Backshell Kits

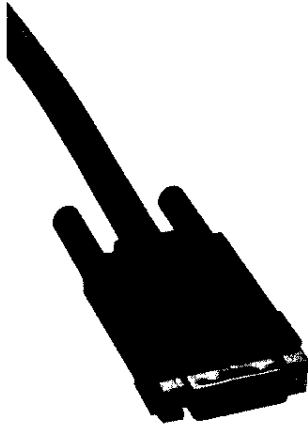

Material and Finish:

Backshells—Copper-nickel alloy

Jackscraws—Steel, plated tin over copper, handles covered with ABS, gray

Keyed and Unkeyed Inserts—Zinc, plated tin over copper

Outside Covers—ABS, gray

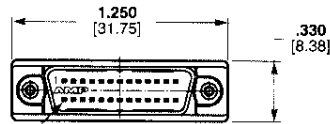
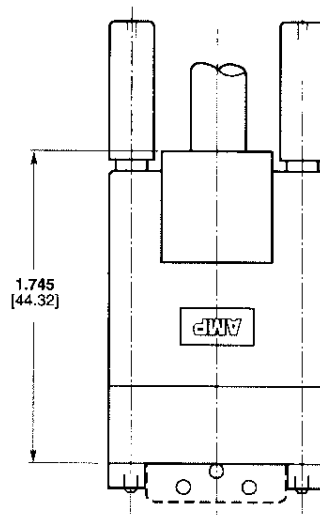

Connector shown for illustration purposes only, must be purchased separately.

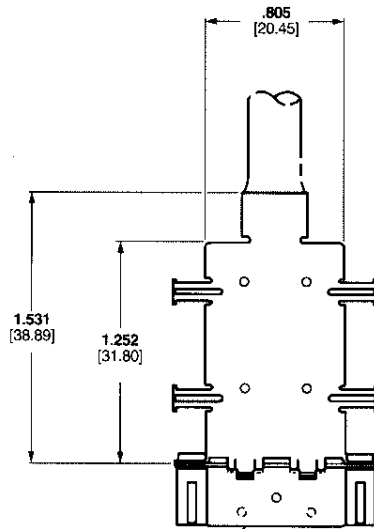

Plug Assembly Must Be Purchased Separately

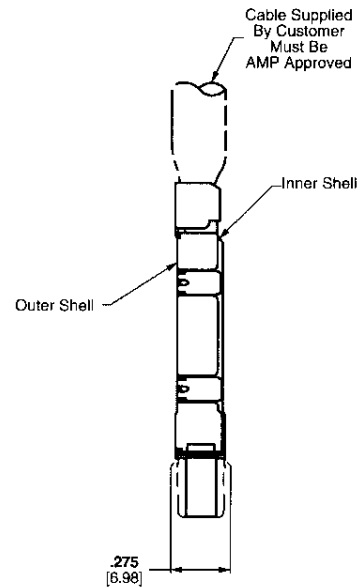

Backshell Kits

Unkeyed Kit Part No.	Cable Dia.	Packaging*
750850-1	.250-.280	Individually Packed Kit
750850-2	6.35-7.11	Bulk Packed Kit
750850-3	.280-.310 7.11-7.87	Individually Packed Kit

*Bulk packaging—100 kits per box.